



SOBHA ONE

SOBHA  
REALTY

ONE

*awaits you...*

# TOWER A

UNIT PLANS

# 1 BEDROOM APARTMENT

## TYPE A (with powder room + balcony)

TOTAL SALEABLE AREA  
 SUITE = 674.79 SQ.FT.  
 BALCONY = 57.48 SQ.FT.  
 TOTAL = 732.27 SQ.FT.

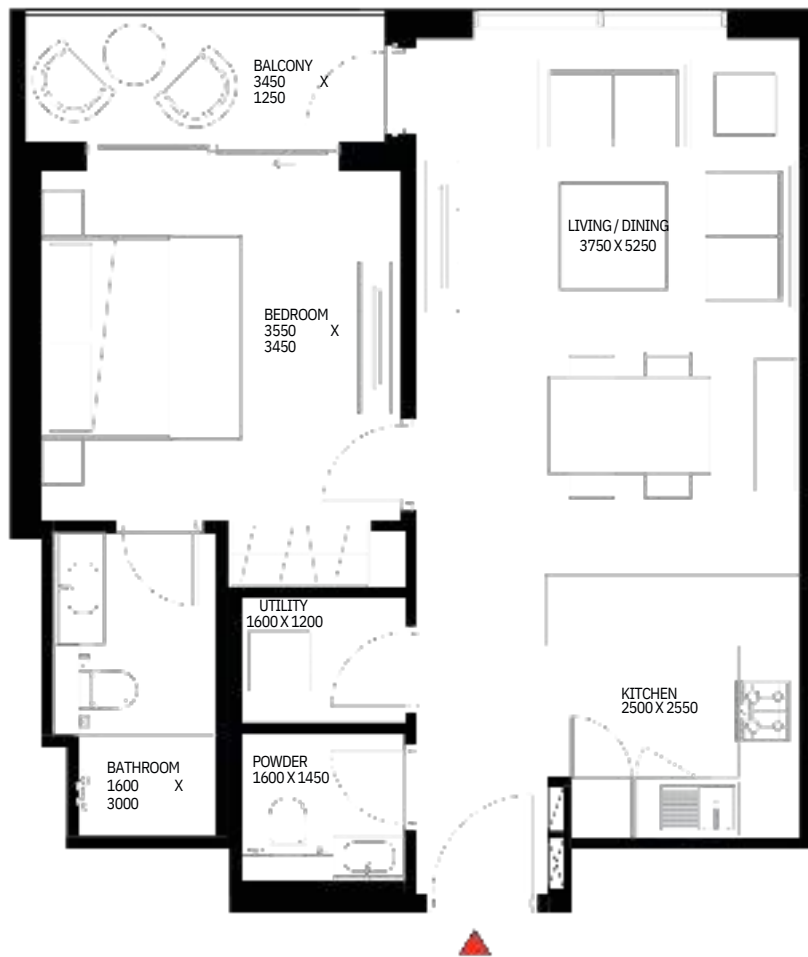
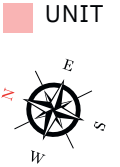
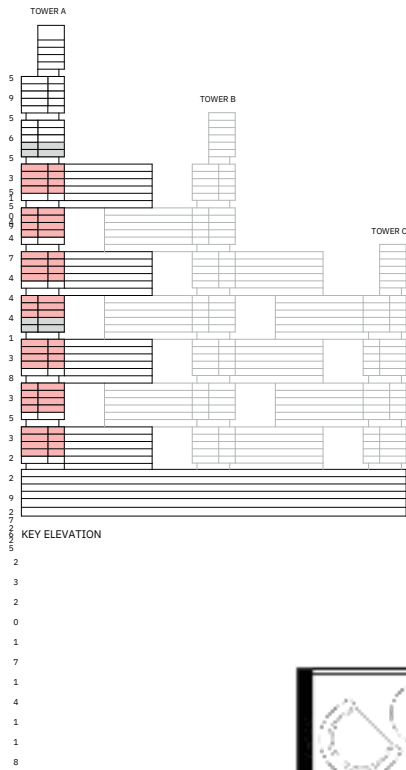

List of unit numbers with this unit plan:

### VIEWS

Creek  
 A802, A804, A902, A904, A1002, A1004, A1102, A1104, A1402, A1404, A1502, A1504, A1602, A1604, A1702, A1704, A2002, A2004, A2102, A2104, A2202, A2204, A2302, A2304, A2702, A2704, A2802, A2804, A2902, A2904, A3202, A3204, A3302, A3304, A3402, A3404, A3502, A3504, A3802, A3804, A3902, A3904, A4002, A4004, A4102, A4104, A4402, A4404, A4502, A4504, A4602, A4604, A4702, A4704

Disclaimer: 1. All dimensions are in metric, measured to wall finishes. 2. All materials, dimensions & drawings are approximate. 3. Information is subject to change without notice, at developer's absolute discretion. 4. Actual area may vary from the stated area. 5. Drawing are not to scale. 6. All images used are for illustrative purpose only and do not represent the actual size, features, specifications, fittings and furnishings. 7. The developer reserves the right to make revisions/ alterations, at its absolute discretion, without any liability whatsoever.

# 1 BEDROOM APARTMENT

TYPE A (with powder room + balcony)

TOTAL SALEABLE AREA  
 SUITE = 674.79 SQ.FT.  
 BALCONY = 57.48 SQ.FT.  
 TOTAL = 732.27 SQ.FT.

UNIT

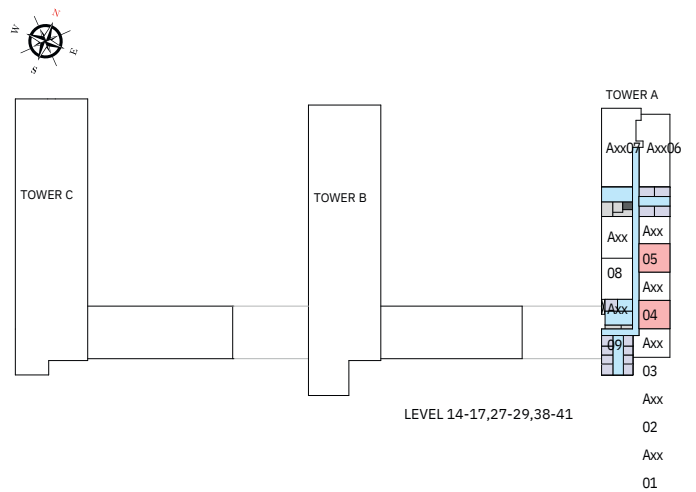
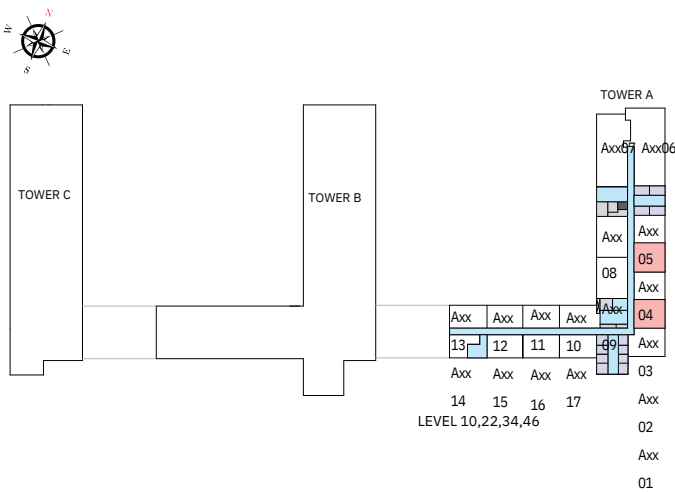
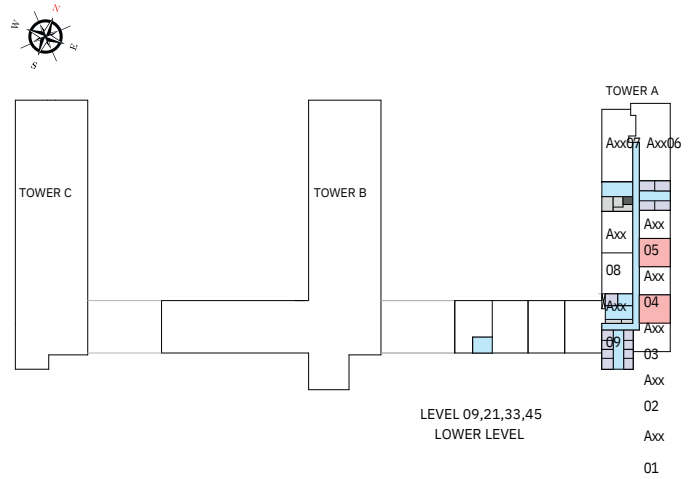
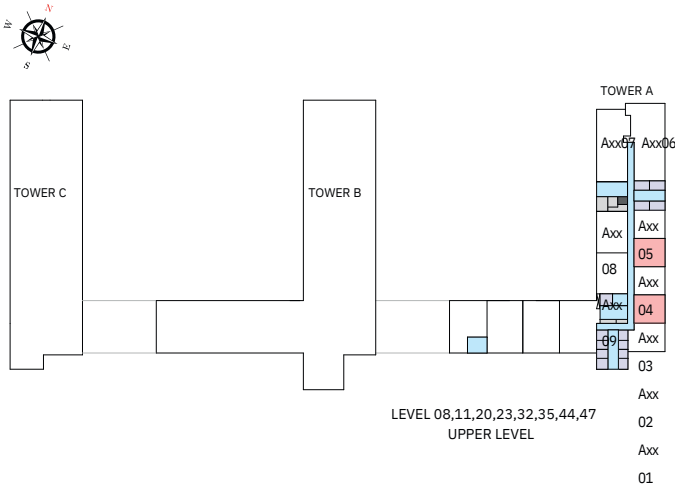

List of unit numbers with this unit plan:

## VIEWS

Creek  
 A802, A804, A902, A904, A1002, A1004, A1102, A1104, A1402, A1404, A1502, A1504, A1602, A1604, A1702, A1704, A2002, A2004, A2102, A2104, A2202, A2204, A2302, A2304, A2702, A2704, A2802, A2804, A2902, A2904, A3202, A3204, A3302, A3304, A3402, A3404, A3502, A3504, A3802, A3804, A3902, A3904, A4002, A4004, A4102, A4104, A4402, A4404, A4502, A4504, A4602, A4604, A4702, A4704

Disclaimer: 1. All dimensions are in metric, measured to wall finishes. 2. All materials, dimensions & drawings are approximate. 3. Information is subject to change without notice, at developer's absolute discretion. 4. Actual area may vary from the stated area. 5. Drawing are not to scale. 6. All images used are for illustrative purpose only and do not represent the actual size, features, specifications, fittings and furnishings. 7. The developer reserves the right to make revisions/ alterations, at its absolute discretion, without any liability whatsoever.

# 1 BEDROOM APARTMENT

TYPE A (with powder room + balcony) VARIANT 1

TOTAL SALEABLE AREA  
 SUITE = 674.79 SQ.FT.  
 BALCONY = 57.48 SQ.FT.  
 TOTAL = 732.27 SQ.FT.

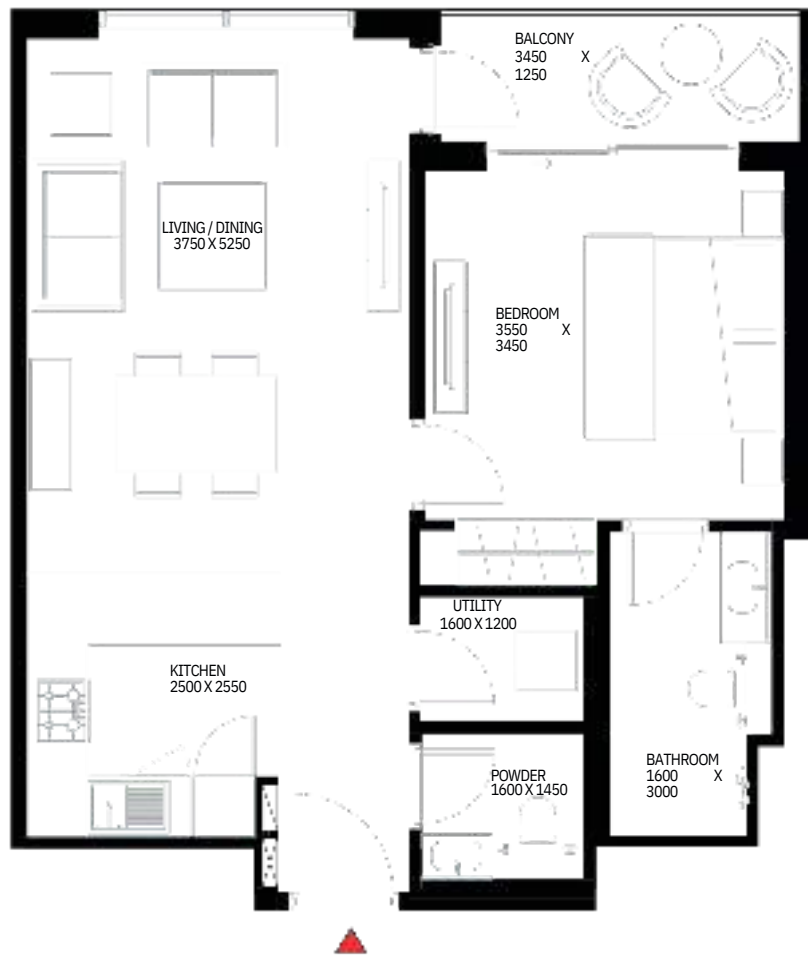
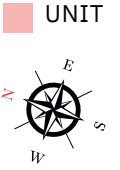
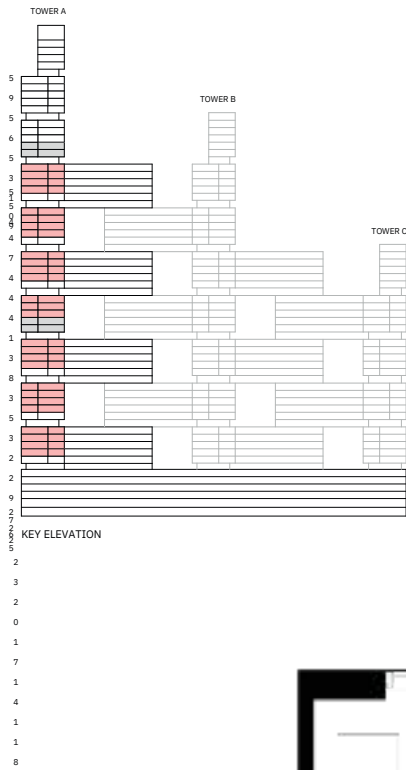

List of unit numbers with this unit plan:

## VIEWS

Creek  
 A803, A805, A903, A905, A1003, A1005, A1103, A1105, A1403, A1405, A1503, A1505, A1603, A1605, A1703, A1705, A2003, A2005, A2103, A2105, A2203, A2205, A2303, A2305, A2703, A2705, A2803, A2805, A2903, A2905, A3203, A3205, A3303, A3305, A3403, A3405, A3503, A3505, A3803, A3805, A3903, A3905, A4003, A4005,, A4103, A4105, A4403, A4405, A4503, A4505, A4603, A4605, A4703, A4705

Disclaimer: 1. All dimensions are in metric, measured to wall finishes. 2. All materials, dimensions & drawings are approximate. 3. Information is subject to change without notice, at developer's absolute discretion. 4. Actual area may vary from the stated area. 5. Drawing are not to scale. 6. All images used are for illustrative purpose only and do not represent the actual size, features, specifications, fittings and furnishings. 7. The developer reserves the right to make revisions/ alterations, at its absolute discretion, without any liability whatsoever.

# 1 BEDROOM APARTMENT

TYPE A (with powder room + balcony) VARIANT 1

TOTAL SALEABLE AREA  
 SUITE = 674.79 SQ.FT.  
 BALCONY = 57.48 SQ.FT.  
 TOTAL = 732.27 SQ.FT.

UNIT

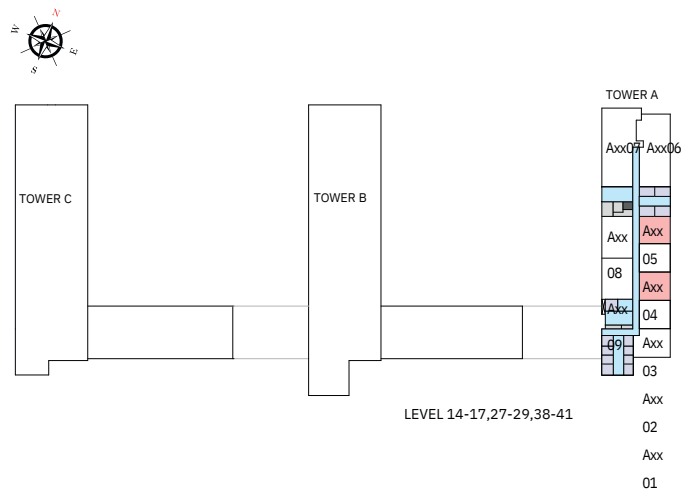
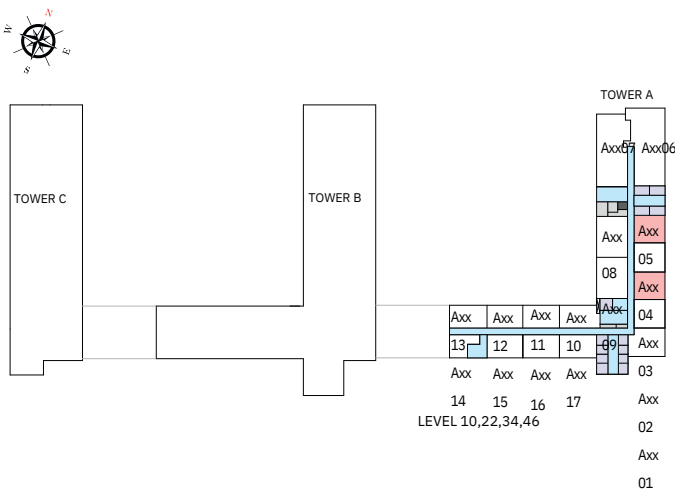
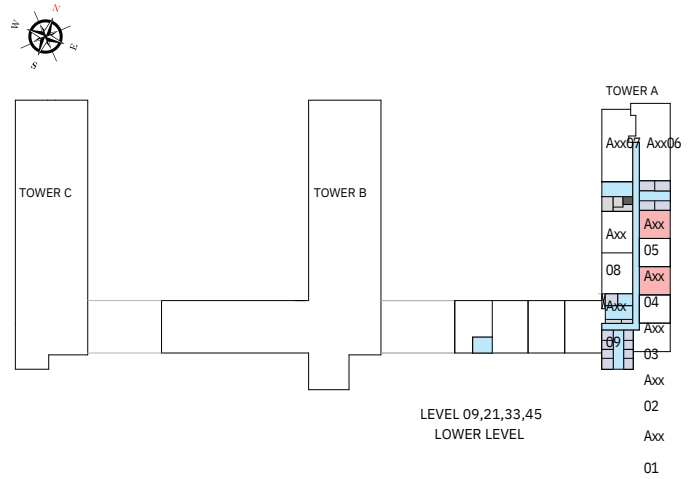
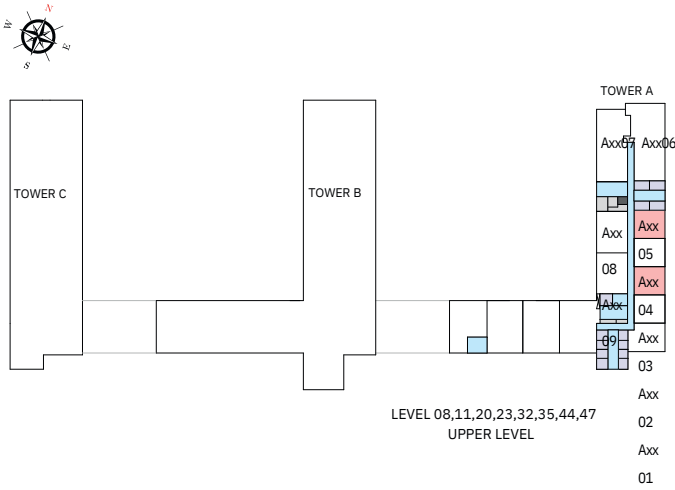

List of unit numbers with this unit plan:

## VIEWS

Creek  
 A803, A805, A903, A905, A1003, A1005, A1103, A1105, A1403, A1405, A1503, A1505, A1603, A1605, A1703, A1705, A2003, A2005, A2103, A2105, A2203, A2205, A2303, A2305, A2703, A2705, A2803, A2805, A2903, A2905, A3203, A3205, A3303, A3305, A3403, A3405, A3503, A3505, A3803, A3805, A3903, A3905, A4003, A4005, A4103, A4105, A4403, A4405, A4503, A4505, A4603, A4605, A4703, A4705

Disclaimer: 1. All dimensions are in metric, measured to wall finishes. 2. All materials, dimensions & drawings are approximate. 3. Information is subject to change without notice, at developer's absolute discretion. 4. Actual area may vary from the stated area. 5. Drawing are not to scale. 6. All images used are for illustrative purpose only and do not represent the actual size, features, specifications, fittings and furnishings. 7. The developer reserves the right to make revisions/ alterations, at its absolute discretion, without any liability whatsoever.

# 1 BEDROOM APARTMENT

TYPE B (with powder room + yard)

TOTAL SALEABLE AREA  
 SUITE = 675.11 SQ.FT.  
 YARD = 132.72 SQ.FT.  
 TOTAL = 807.83 SQ.FT.

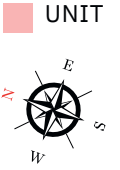
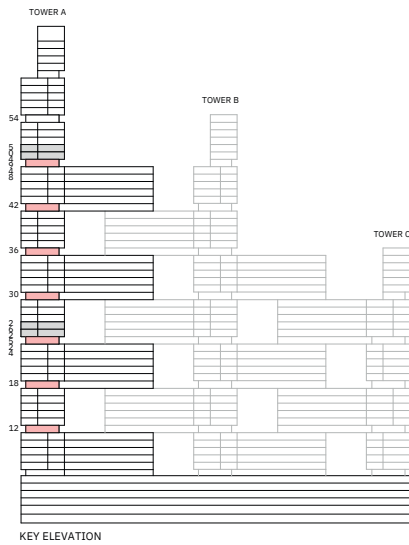

List of unit numbers with this unit plan:

## VIEWS

Creek  
 A1202, A1204, A1802, A1804, A2402, A2404, A3002, A3004, A3602, A3604, A4202, A4204, A4802, A4804

Disclaimer: 1. All dimensions are in metric, measured to wall finishes. 2. All materials, dimensions & drawings are approximate. 3. Information is subject to change without notice, at developer's absolute discretion. 4. Actual area may vary from the stated area. 5. Drawing are not to scale. 6. All images used are for illustrative purpose only and do not represent the actual size, features, specifications, fittings and furnishings. 7. The developer reserves the right to make revisions/ alterations, at its absolute discretion, without any liability whatsoever.



# 1 BEDROOM APARTMENT

TYPE B (with powder room + yard)

TOTAL SALEABLE AREA  
 SUITE = 675.11 SQ.FT.  
 YARD = 132.72 SQ.FT.  
 TOTAL = 807.83 SQ.FT.

■ UNIT

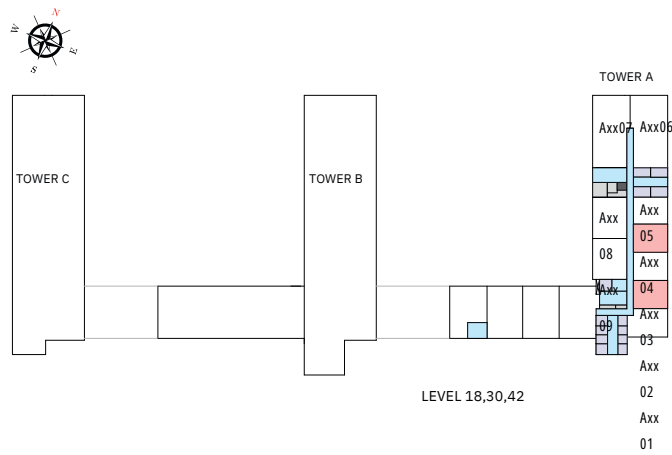
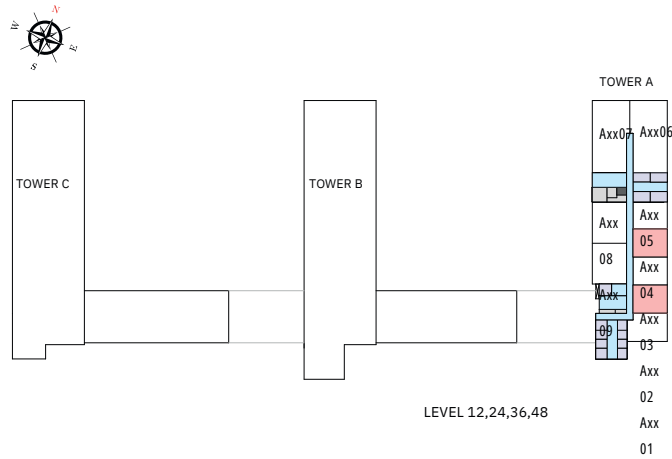

List of unit numbers with this unit plan:

## VIEWS

Creek  
 A1202, A1204, A1802, A1804, A2402, A2404, A3002, A3004, A3602, A3604, A4202, A4204, A4802, A4804

Disclaimer: 1. All dimensions are in metric, measured to wall finishes. 2. All materials, dimensions & drawings are approximate. 3. Information is subject to change without notice, at developer's absolute discretion. 4. Actual area may vary from the stated area. 5. Drawing are not to scale. 6. All images used are for illustrative purpose only and do not represent the actual size, features, specifications, fittings and furnishings. 7. The developer reserves the right to make revisions/ alterations, at its absolute discretion, without any liability whatsoever.

# 1 BEDROOM APARTMENT

TYPE B (with powder room + yard) VARIANT 1

TOTAL SALEABLE AREA  
 SUITE = 675.11 SQ.FT.  
 YARD = 132.72 SQ.FT.  
 TOTAL = 807.83 SQ.FT.

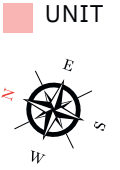
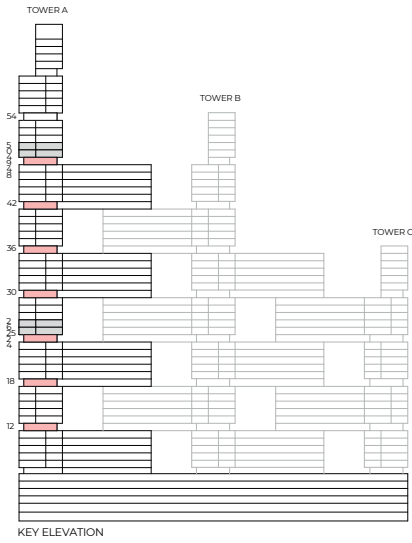

List of unit numbers with this unit plan:

## VIEWS

Creek  
 A1203, A1205, A1803, A1805, A2403, A2405, A3003, A3005, A3603, A3605, A4203, A4205, A4803, A4805

Disclaimer: 1. All dimensions are in metric, measured to wall finishes. 2. All materials, dimensions & drawings are approximate. 3. Information is subject to change without notice, at developer's absolute discretion. 4. Actual area may vary from the stated area. 5. Drawing are not to scale. 6. All images used are for illustrative purpose only and do not represent the actual size, features, specifications, fittings and furnishings. 7. The developer reserves the right to make revisions/ alterations, at its absolute discretion, without any liability whatsoever.

# 1 BEDROOM APARTMENT

TYPE B (with powder room + yard) VARIANT 1

TOTAL SALEABLE AREA  
 SUITE = 675.11 SQ.FT.  
 YARD = 132.72 SQ.FT.  
 TOTAL = 807.83 SQ.FT.

■ UNIT

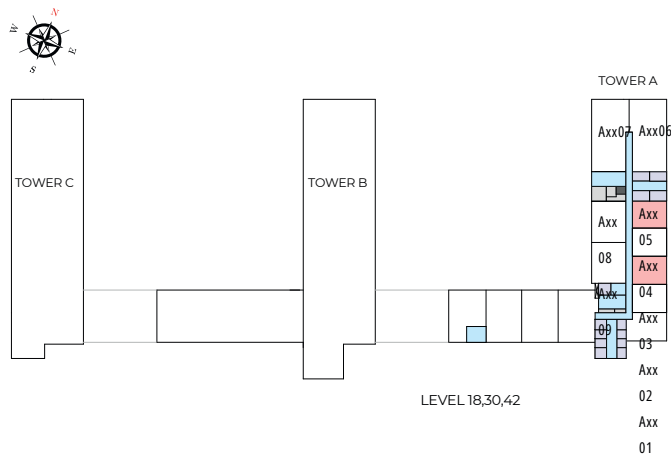
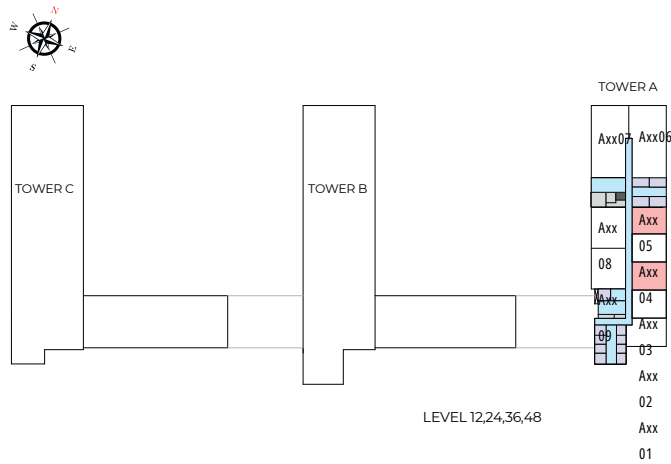

List of unit numbers with this unit plan:

## VIEWS

Creek  
 A1203, A1205, A1803, A1805, A2403, A2405, A3003, A3005, A3603, A3605, A4203, A4205, A4803, A4805

Disclaimer: 1. All dimensions are in metric, measured to wall finishes. 2. All materials, dimensions & drawings are approximate. 3. Information is subject to change without notice, at developer's absolute discretion. 4. Actual area may vary from the stated area. 5. Drawing are not to scale. 6. All images used are for illustrative purpose only and do not represent the actual size, features, specifications, fittings and furnishings. 7. The developer reserves the right to make revisions/ alterations, at its absolute discretion, without any liability whatsoever.

# 1 BEDROOM APARTMENT

TYPE C (with powder room + yard)

TOTAL SALEABLE AREA  
 SUITE = 674.79 SQ.FT.  
 YARD = 133.04 SQ.FT.  
 TOTAL = 807.83 SQ.FT.

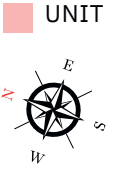
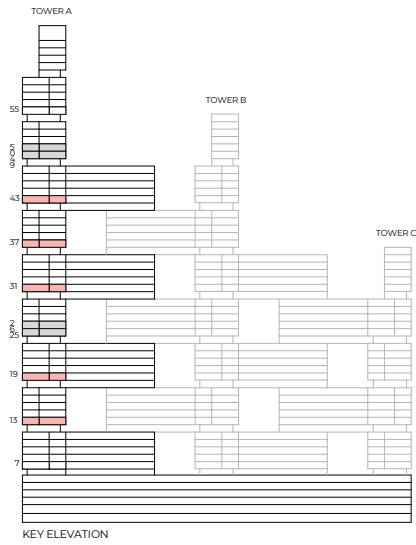

List of unit numbers with this unit plan:

## VIEWS

Creek  
 A1302, A1304, A1902, A1904, A3102, A3104, A3702, A3704, A4302, A4304

Disclaimer: 1. All dimensions are in metric, measured to wall finishes. 2. All materials, dimensions & drawings are approximate. 3. Information is subject to change without notice, at developer's absolute discretion. 4. Actual area may vary from the stated area. 5. Drawing are not to scale. 6. All images used are for illustrative purpose only and do not represent the actual size, features, specifications, fittings and furnishings. 7. The developer reserves the right to make revisions/ alterations, at its absolute discretion, without any liability whatsoever.

# 1 BEDROOM APARTMENT

TYPE C (with powder room + yard)

TOTAL SALEABLE AREA  
 SUITE = 674.79 SQ.FT.  
 YARD = 133.04 SQ.FT.  
 TOTAL = 807.83 SQ.FT.

■ UNIT

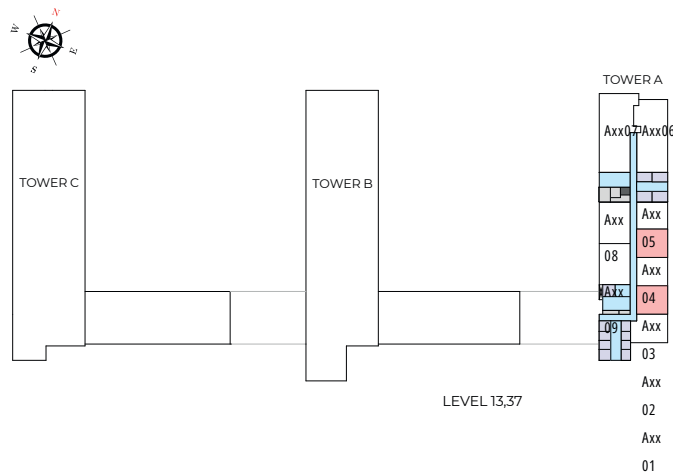
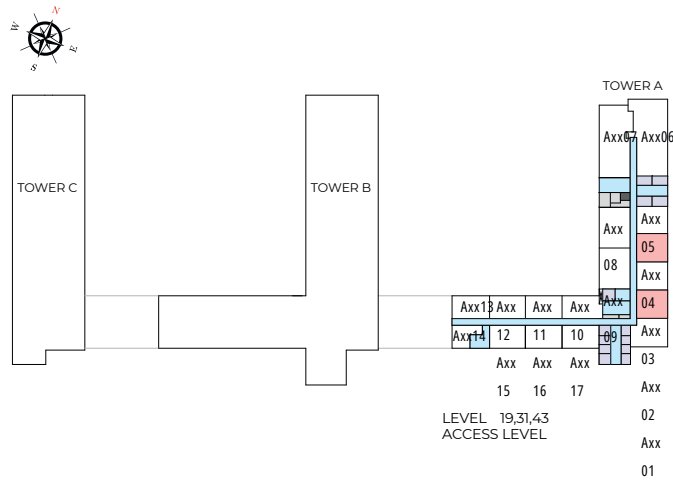

List of unit numbers with this unit plan:

## VIEWS

Creek  
 A1302, A1304, A1902, A1904, A3102, A3104, A3702, A3704, A4302, A4304

Disclaimer: 1. All dimensions are in metric, measured to wall finishes. 2. All materials, dimensions & drawings are approximate. 3. Information is subject to change without notice, at developer's absolute discretion. 4. Actual area may vary from the stated area. 5. Drawing are not to scale. 6. All images used are for illustrative purpose only and do not represent the actual size, features, specifications, fittings and furnishings. 7. The developer reserves the right to make revisions/ alterations, at its absolute discretion, without any liability whatsoever.

# 1 BEDROOM APARTMENT

TYPE C (with powder room + yard) VARIANT 1

TOTAL SALEABLE AREA  
 SUITE = 674.79 SQ.FT.  
 YARD = 133.04 SQ.FT.  
 TOTAL = 807.83 SQ.FT.

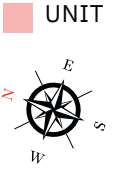
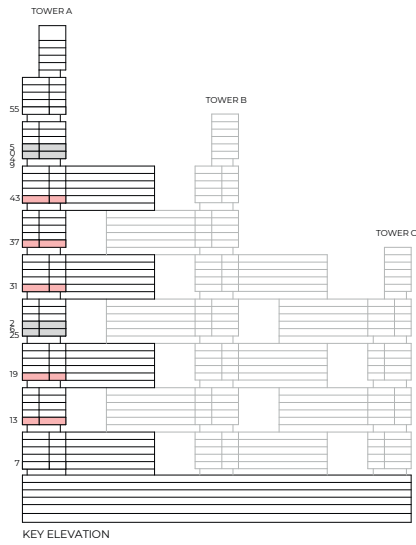

List of unit numbers with this unit plan:

## VIEWS

Creek  
 A1303, A1305, A1903, A1905, A3103, A3105, A3703, A3705, A4303, A4305

Disclaimer: 1. All dimensions are in metric, measured to wall finishes. 2. All materials, dimensions & drawings are approximate. 3. Information is subject to change without notice, at developer's absolute discretion. 4. Actual area may vary from the stated area. 5. Drawing are not to scale. 6. All images used are for illustrative purpose only and do not represent the actual size, features, specifications, fittings and furnishings. 7. The developer reserves the right to make revisions/ alterations, at its absolute discretion, without any liability whatsoever.

# 1 BEDROOM APARTMENT

TYPE C (with powder room + yard) VARIANT 1

TOTAL SALEABLE AREA  
 SUITE = 674.79 SQ.FT.  
 YARD = 133.04 SQ.FT.  
 TOTAL = 807.83 SQ.FT.

■ UNIT

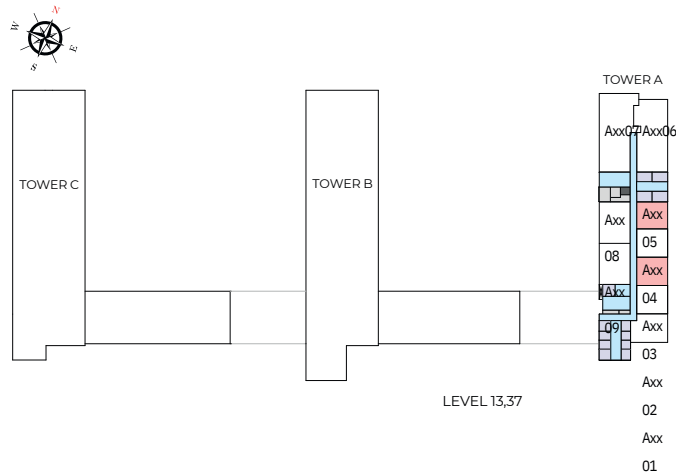
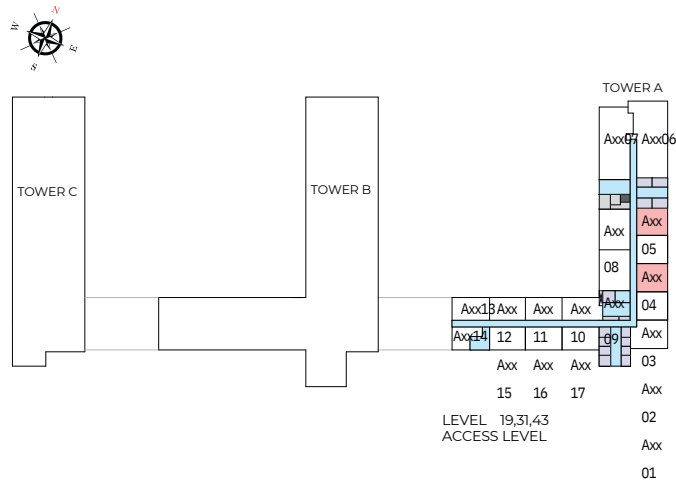

List of unit numbers with this unit plan:

## VIEWS

Creek  
 A1303, A1305, A1903, A1905, A3103, A3105, A3703, A3705, A4303, A4305

Disclaimer: 1. All dimensions are in metric, measured to wall finishes. 2. All materials, dimensions & drawings are approximate. 3. Information is subject to change without notice, at developer's absolute discretion. 4. Actual area may vary from the stated area. 5. Drawing are not to scale. 6. All images used are for illustrative purpose only and do not represent the actual size, features, specifications, fittings and furnishings. 7. The developer reserves the right to make revisions/ alterations, at its absolute discretion, without any liability whatsoever.

# 2 BEDROOM APARTMENT

## TYPE A (with powder room + balcony)

TOTAL SALEABLE AREA  
 SUITE = 1,034.63 SQ.FT.  
 BALCONY = 64.69 SQ.FT.  
 TOTAL = 1,099.32 SQ.FT.

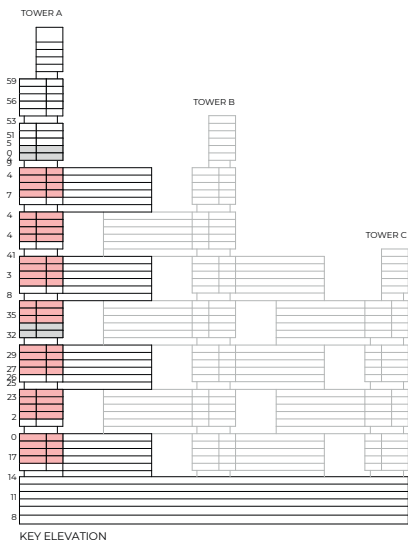

List of unit numbers with this unit plan:

### VIEWS

Ras Al Khor, Amenities  
 A809, A909

Ras Al Khor, Golf Course, Amenities  
 A1009, A1109, A1409, A1509, A1609, A1709, A2009, A2109, A2209, A2309

Ras Al Khor, Golf Course  
 A2709, A2809, A2909, A3209, A3309, A3409, A3509, A3809, A3909, A4009, A4109, A4409, A4509, A4609, A4709

Disclaimer: 1. All dimensions are in metric, measured to wall finishes. 2. All materials, dimensions & drawings are approximate. 3. Information is subject to change without notice, at developer's absolute discretion. 4. Actual area may vary from the stated area. 5. Drawing are not to scale. 6. All images used are for illustrative purpose only and do not represent the actual size, features, specifications, fittings and furnishings. 7. The developer reserves the right to make revisions/ alterations, at its absolute discretion, without any liability whatsoever.



# 2 BEDROOM APARTMENT

TYPE A (with powder room + balcony)

TOTAL SALEABLE AREA  
 SUITE = 1,034.63 SQ.FT.  
 BALCONY = 64.69 SQ.FT.  
 TOTAL = 1,099.32 SQ.FT.

■ UNIT

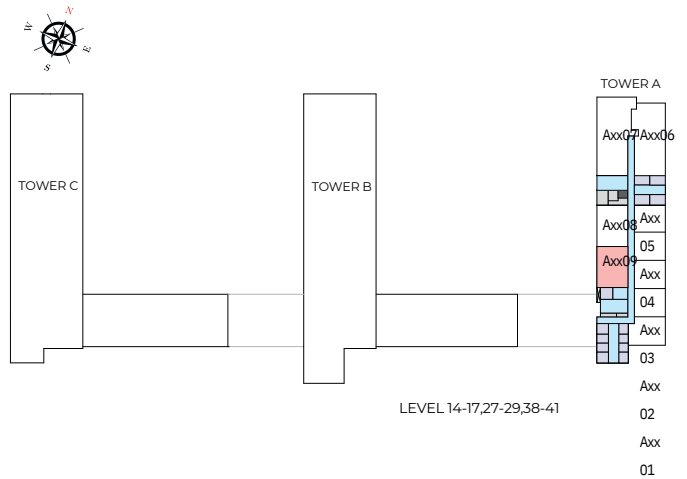
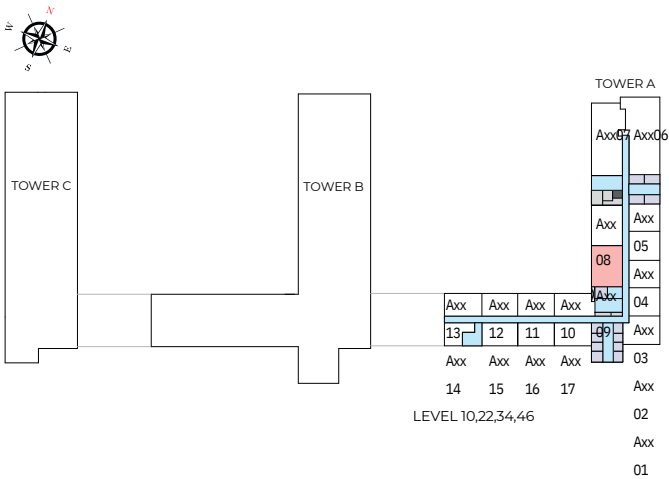
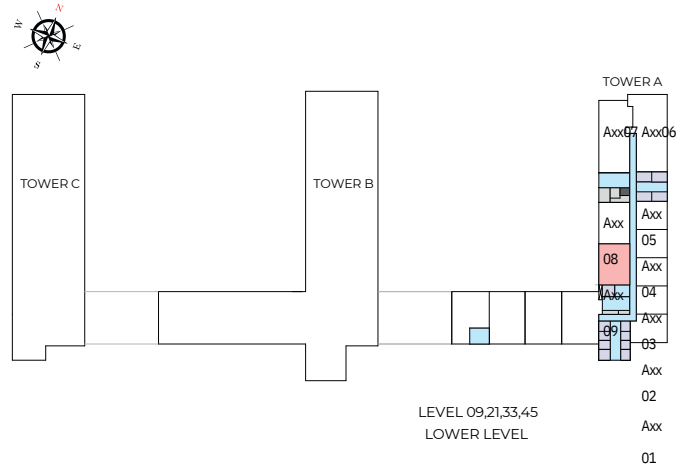
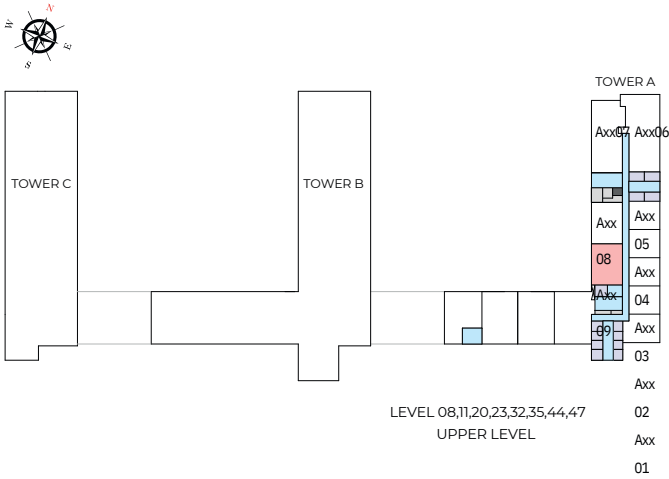

List of unit numbers with this unit plan:

## VIEWS

Ras Al Khor, Amenities  
 A809, A909

Ras Al Khor, Golf Course, Amenities  
 A1009, A1109, A1409, A1509, A1609, A1709, A2009, A2109, A2209, A2309

Ras Al Khor, Golf Course  
 A2709, A2809, A2909, A3209, A3309, A3409, A3509, A3809, A3909, A4009, A4109, A4409, A4509, A4609, A4709

Disclaimer: 1. All dimensions are in metric, measured to wall finishes. 2. All materials, dimensions & drawings are approximate. 3. Information is subject to change without notice, at developer's absolute discretion. 4. Actual area may vary from the stated area. 5. Drawing are not to scale. 6. All images used are for illustrative purpose only and do not represent the actual size, features, specifications, fittings and furnishings. 7. The developer reserves the right to make revisions/ alterations, at its absolute discretion, without any liability whatsoever.

# 2 BEDROOM APARTMENT

TYPE A (with powder room + balcony) VARIANT 1

TOTAL SALEABLE AREA  
 SUITE = 1,034.63 SQ.FT.  
 BALCONY = 64.69 SQ.FT.  
 TOTAL = 1,099.32 SQ.FT.

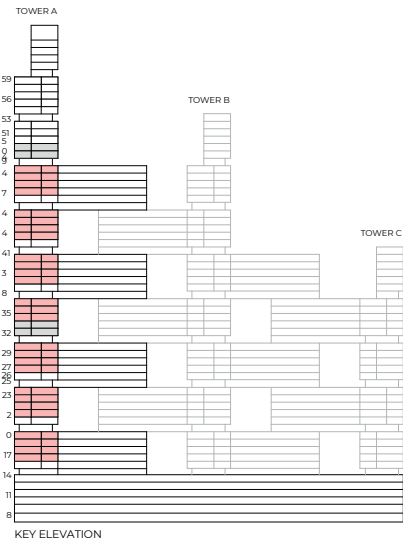

List of unit numbers with this unit plan:

## VIEWS

Ras Al Khor, Amenities  
 A808, A908

Ras Al Khor, Golf Course, Amenities  
 A1008, A1108, A1408, A1508, A1608, A1708, A2008, A2108, A2208, A2308

Ras Al Khor, Golf Course  
 A2708, A2808, A2908, A3208, A3308, A3408, A3508, A3808, A3908, A4008, A4108, A4408, A4508, A4608, A4708

Disclaimer: 1. All dimensions are in metric, measured to wall finishes. 2. All materials, dimensions & drawings are approximate. 3. Information is subject to change without notice, at developer's absolute discretion. 4. Actual area may vary from the stated area. 5. Drawing are not to scale. 6. All images used are for illustrative purpose only and do not represent the actual size, features, specifications, fittings and furnishings. 7. The developer reserves the right to make revisions/ alterations, at its absolute discretion, without any liability whatsoever.

# 2 BEDROOM APARTMENT

TYPE A (with powder room + balcony) VARIANT 1

TOTAL SALEABLE AREA  
 SUITE = 1,034.63 SQ.FT.  
 BALCONY = 64.69 SQ.FT.  
 TOTAL = 1,099.32 SQ.FT.

■ UNIT

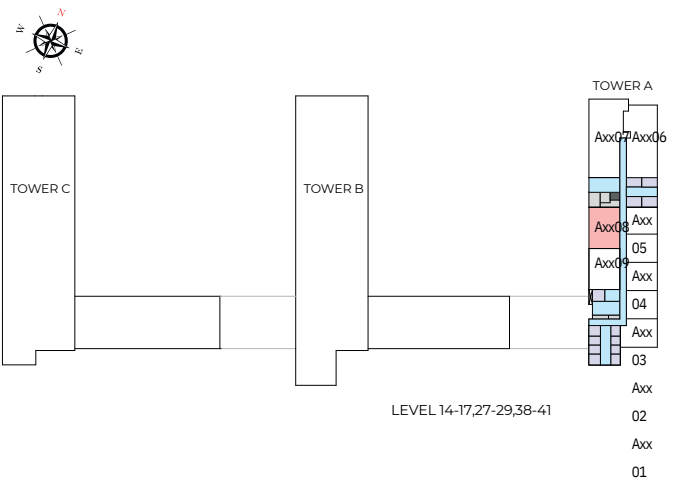
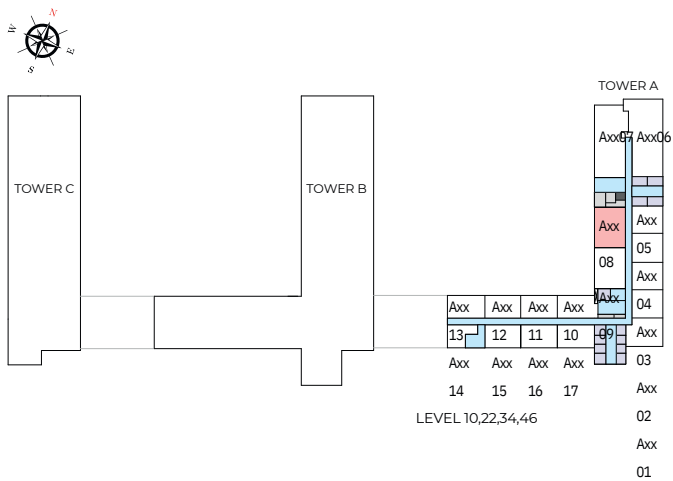
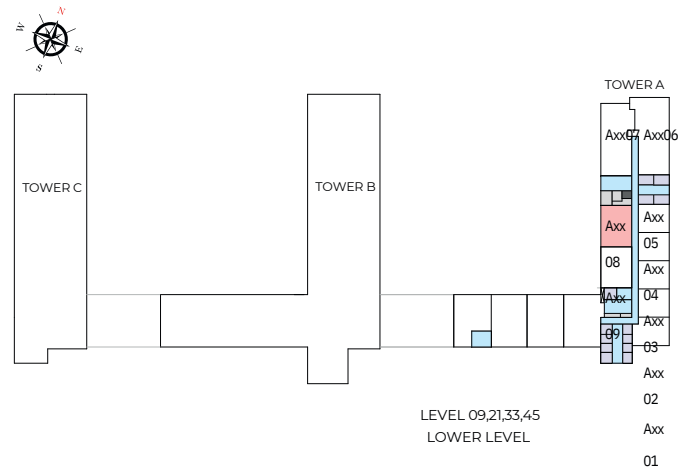
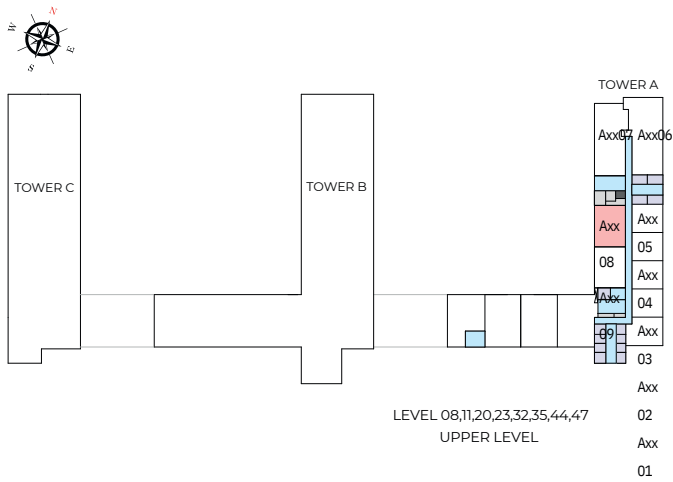

List of unit numbers with this unit plan:

## VIEWS

Ras Al Khor, Amenities  
 A808, A908

Ras Al Khor, Golf Course, Amenities  
 A1008, A1108, A1408, A1508, A1608, A1708, A2008, A2108, A2208, A2308

Ras Al Khor, Golf Course  
 A2708, A2808, A2908, A3208, A3308, A3408, A3508, A3808, A3908, A4008, A4108, A4408, A4508, A4608, A4708

Disclaimer: 1. All dimensions are in metric, measured to wall finishes. 2. All materials, dimensions & drawings are approximate. 3. Information is subject to change without notice, at developer's absolute discretion. 4. Actual area may vary from the stated area. 5. Drawing are not to scale. 6. All images used are for illustrative purpose only and do not represent the actual size, features, specifications, fittings and furnishings. 7. The developer reserves the right to make revisions/ alterations, at its absolute discretion, without any liability whatsoever.

# 2 BEDROOM APARTMENT

TYPE G (with powder room + yard)

TOTAL SALEABLE AREA  
 SUITE = 1,025.05 SQ.FT.  
 YARD = 184.82 SQ.FT.  
 TOTAL = 1,209.87 SQ.FT.

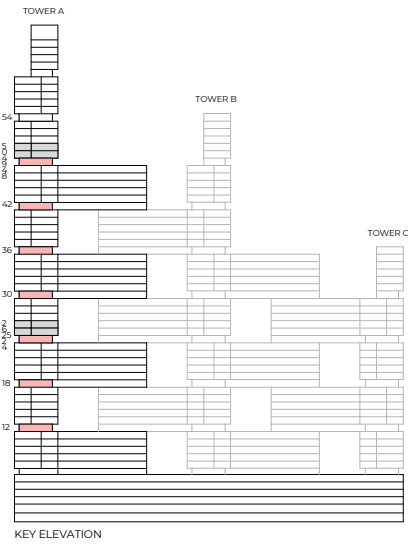

List of unit numbers with this unit plan:

## VIEWS

Ras Al Khor, Golf Course, Amenities  
 A1209, A1809, A2409

Ras Al Khor, Golf Course  
 A3009, A3609, A4209, A4809

Disclaimer: 1. All dimensions are in metric, measured to wall finishes. 2. All materials, dimensions & drawings are approximate. 3. Information is subject to change without notice, at developer's absolute discretion. 4. Actual area may vary from the stated area. 5. Drawing are not to scale. 6. All images used are for illustrative purpose only and do not represent the actual size, features, specifications, fittings and furnishings. 7. The developer reserves the right to make revisions/ alterations, at its absolute discretion, without any liability whatsoever.

# 2 BEDROOM APARTMENT

TYPE G (with powder room + yard)

TOTAL SALEABLE AREA  
 SUITE = 1,025.05 SQ.FT.  
 YARD = 184.82 SQ.FT.  
 TOTAL = 1,209.87 SQ.FT.

■ UNIT

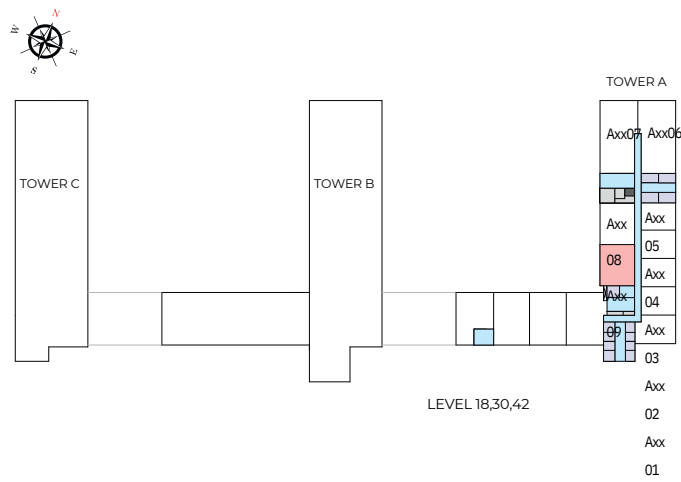
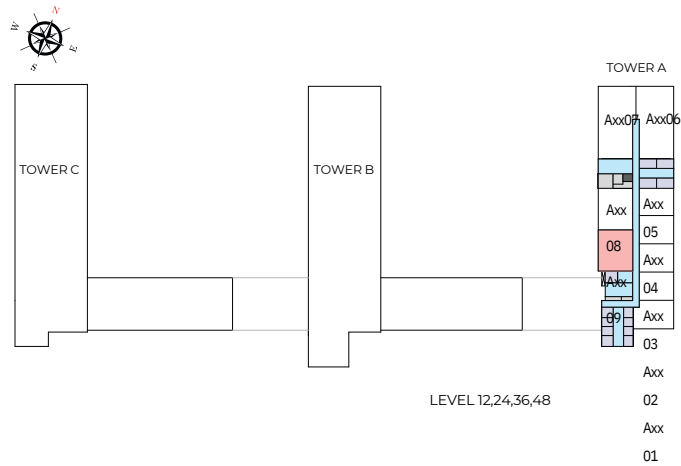

List of unit numbers with this unit plan:

## VIEWS

Ras Al Khor, Golf Course, Amenities  
 A1209, A1809, A2409

Ras Al Khor, Golf Course  
 A3009, A3609, A4209, A4809

Disclaimer: 1. All dimensions are in metric, measured to wall finishes. 2. All materials, dimensions & drawings are approximate. 3. Information is subject to change without notice, at developer's absolute discretion. 4. Actual area may vary from the stated area. 5. Drawing are not to scale. 6. All images used are for illustrative purpose only and do not represent the actual size, features, specifications, fittings and furnishings. 7. The developer reserves the right to make revisions/ alterations, at its absolute discretion, without any liability whatsoever.

# 2 BEDROOM APARTMENT

TYPE G (with powder room + yard) VARIANT 1

TOTAL SALEABLE AREA  
 SUITE = 1,025.05 SQ.FT.  
 YARD = 184.82 SQ.FT.  
 TOTAL = 1,209.87 SQ.FT.

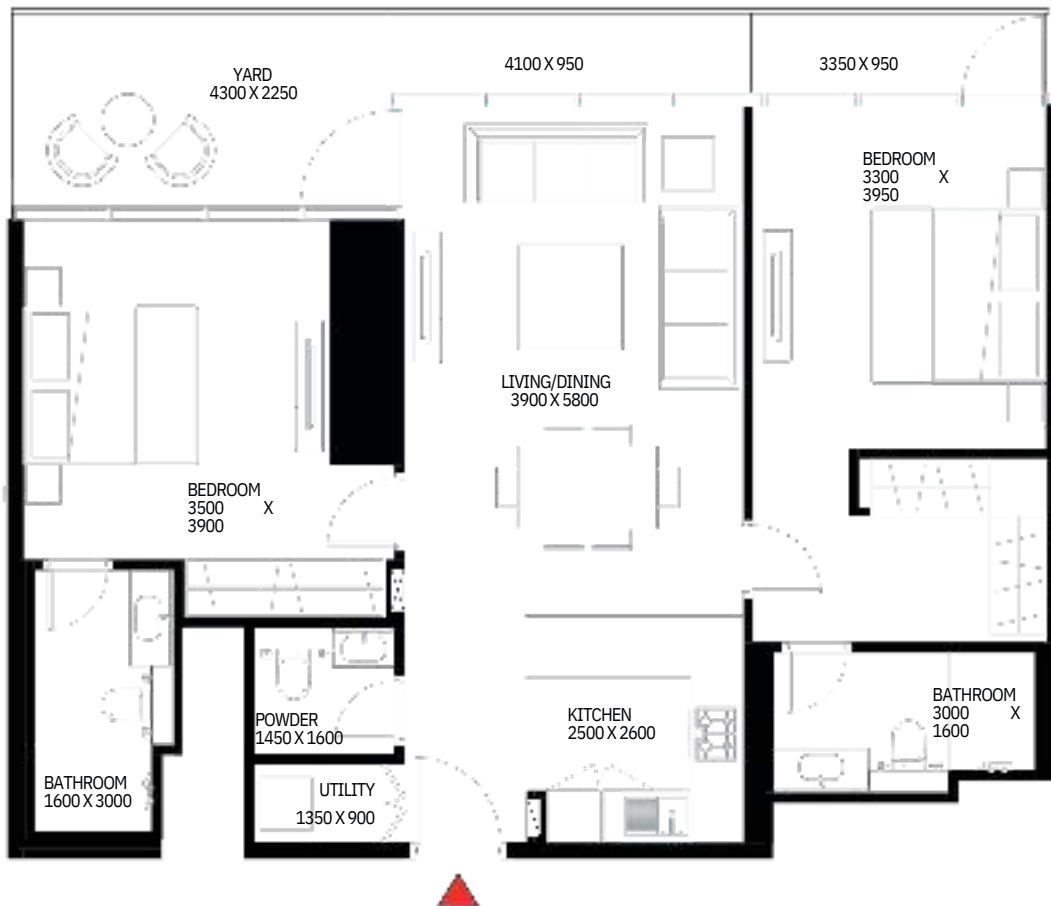
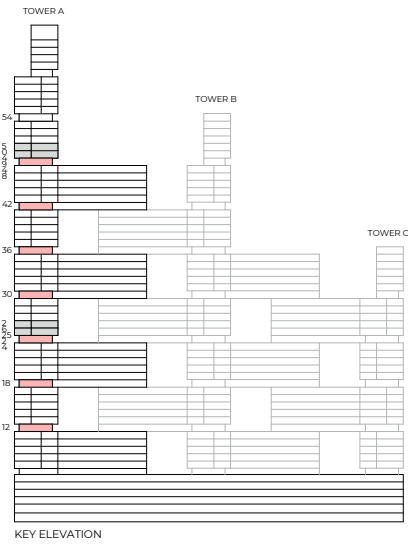

List of unit numbers with this unit plan:

## VIEWS

Ras Al Khor, Golf Course, Amenities  
 A1208, A1808, A2408

Ras Al Khor, Golf Course  
 A3008, A3608, A4208, A4808

Disclaimer: 1. All dimensions are in metric, measured to wall finishes. 2. All materials, dimensions & drawings are approximate. 3. Information is subject to change without notice, at developer's absolute discretion. 4. Actual area may vary from the stated area. 5. Drawing are not to scale. 6. All images used are for illustrative purpose only and do not represent the actual size, features, specifications, fittings and furnishings. 7. The developer reserves the right to make revisions/ alterations, at its absolute discretion, without any liability whatsoever.

# 2 BEDROOM APARTMENT

TYPE G (with powder room + yard) VARIANT 1

TOTAL SALEABLE AREA  
 SUITE = 1,025.05 SQ.FT.  
 YARD = 184.82 SQ.FT.  
 TOTAL = 1,209.87 SQ.FT.

■ UNIT

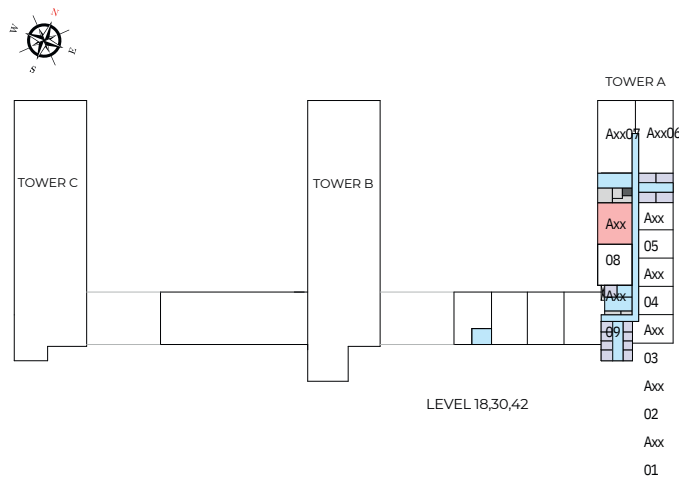
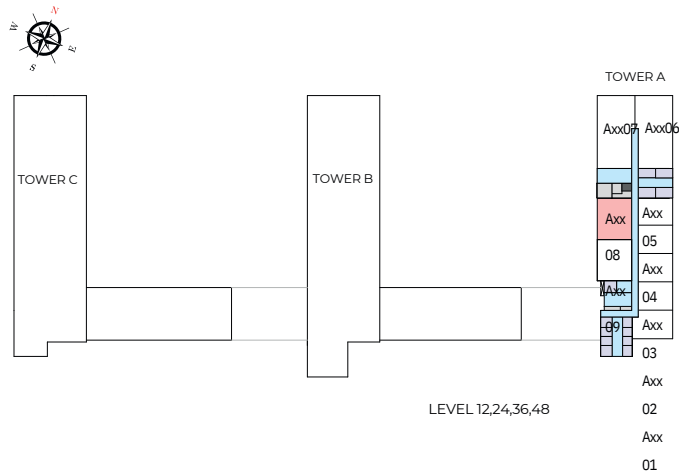

List of unit numbers with this unit plan:

## VIEWS

Ras Al Khor, Golf Course, Amenities  
 A1208, A1808, A2408

Ras Al Khor, Golf Course  
 A3008, A3608, A4208, A4808

Disclaimer: 1. All dimensions are in metric, measured to wall finishes. 2. All materials, dimensions & drawings are approximate. 3. Information is subject to change without notice, at developer's absolute discretion. 4. Actual area may vary from the stated area. 5. Drawing are not to scale. 6. All images used are for illustrative purpose only and do not represent the actual size, features, specifications, fittings and furnishings. 7. The developer reserves the right to make revisions/ alterations, at its absolute discretion, without any liability whatsoever.

# 2 BEDROOM APARTMENT

TYPE P (with powder room + yard)

TOTAL SALEABLE AREA  
 SUITE = 1,034.61 SQ.FT.  
 YARD = 178.41 SQ.FT.  
 TOTAL = 1,213.02 SQ.FT.

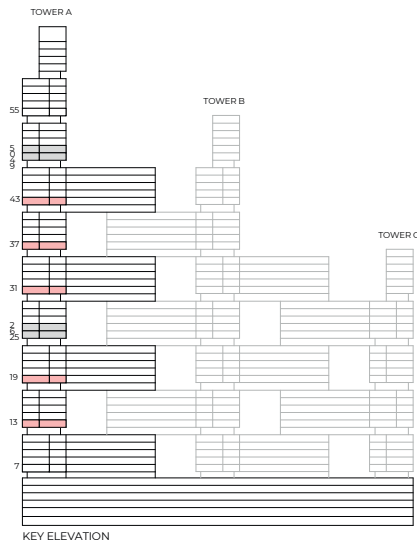

List of unit numbers with this unit plan:

## VIEWS

Ras Al Khor, Golf Course, Amenities  
 A1309, A1909

Ras Al Khor, Golf Course  
 A3109, A3709, A4309

Disclaimer: 1. All dimensions are in metric, measured to wall finishes. 2. All materials, dimensions & drawings are approximate. 3. Information is subject to change without notice, at developer's absolute discretion. 4. Actual area may vary from the stated area. 5. Drawing are not to scale. 6. All images used are for illustrative purpose only and do not represent the actual size, features, specifications, fittings and furnishings. 7. The developer reserves the right to make revisions/ alterations, at its absolute discretion, without any liability whatsoever.



# 2 BEDROOM APARTMENT

TYPE P (with powder room + yard)

TOTAL SALEABLE AREA  
 SUITE = 1,034.61 SQ.FT.  
 YARD = 178.41 SQ.FT.  
 TOTAL = 1,213.02 SQ.FT.

■ UNIT

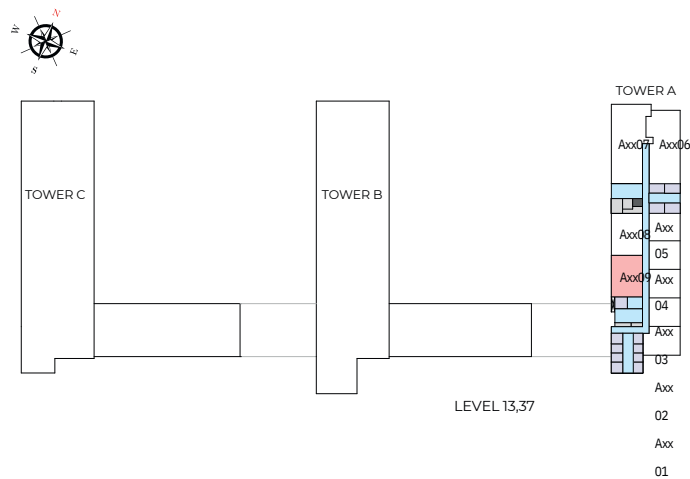
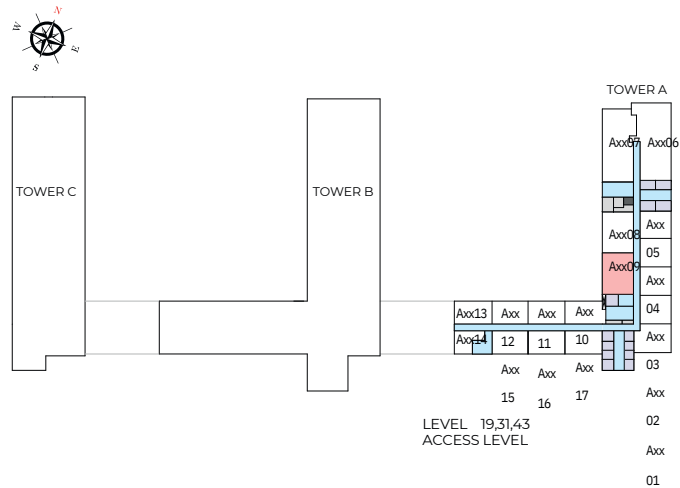

List of unit numbers with this unit plan:

## VIEWS

Ras Al Khor, Golf Course, Amenities  
 A1309, A1909

Ras Al Khor, Golf Course  
 A3109, A3709, A4309

Disclaimer: 1. All dimensions are in metric, measured to wall finishes. 2. All materials, dimensions & drawings are approximate. 3. Information is subject to change without notice, at developer's absolute discretion. 4. Actual area may vary from the stated area. 5. Drawing are not to scale. 6. All images used are for illustrative purpose only and do not represent the actual size, features, specifications, fittings and furnishings. 7. The developer reserves the right to make revisions/ alterations, at its absolute discretion, without any liability whatsoever.

# 2 BEDROOM APARTMENT

TYPE P (with powder room + yard) VARIANT 1

TOTAL SALEABLE AREA  
 SUITE = 1,034.61 SQ.FT.  
 YARD = 178.41 SQ.FT.  
 TOTAL = 1,213.02 SQ.FT.

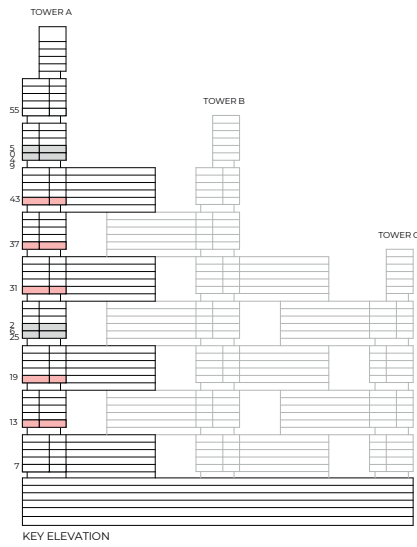

List of unit numbers with this unit plan:

## VIEWS

Ras Al Khor, Golf Course, Amenities  
 A1308, A1908

Ras Al Khor, Golf Course  
 A3108, A3708, A4308

Disclaimer: 1. All dimensions are in metric, measured to wall finishes. 2. All materials, dimensions & drawings are approximate. 3. Information is subject to change without notice, at developer's absolute discretion. 4. Actual area may vary from the stated area. 5. Drawing are not to scale. 6. All images used are for illustrative purpose only and do not represent the actual size, features, specifications, fittings and furnishings. 7. The developer reserves the right to make revisions/ alterations, at its absolute discretion, without any liability whatsoever.

# 2 BEDROOM APARTMENT

TYPE P (with powder room + yard) VARIANT 1

TOTAL SALEABLE AREA  
 SUITE = 1,034.61 SQ.FT.  
 YARD = 178.41 SQ.FT.  
 TOTAL = 1,213.02 SQ.FT.

■ UNIT

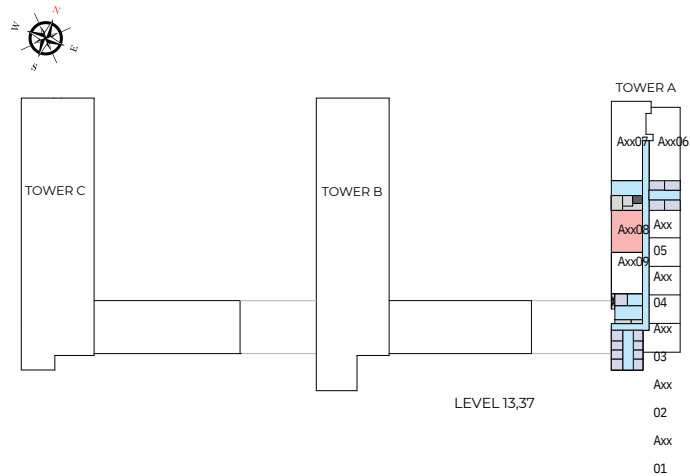
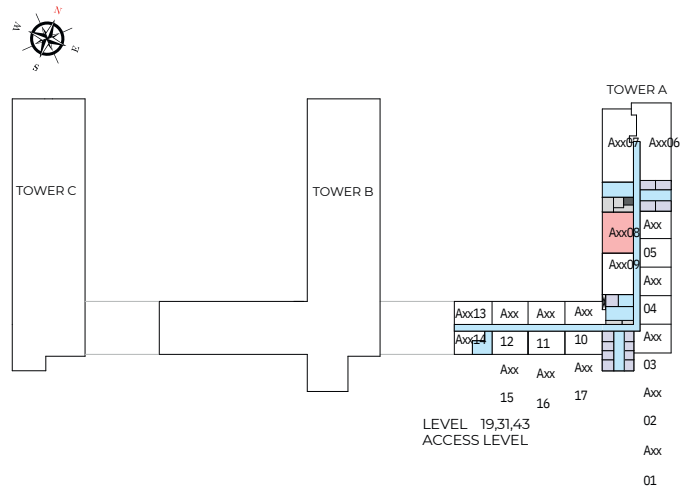

List of unit numbers with this unit plan:

## VIEWS

Ras Al Khor, Golf Course, Amenities  
 A1308, A1908

Ras Al Khor, Golf Course  
 A3108, A3708, A4308

Disclaimer: 1. All dimensions are in metric, measured to wall finishes. 2. All materials, dimensions & drawings are approximate. 3. Information is subject to change without notice, at developer's absolute discretion. 4. Actual area may vary from the stated area. 5. Drawing are not to scale. 6. All images used are for illustrative purpose only and do not represent the actual size, features, specifications, fittings and furnishings. 7. The developer reserves the right to make revisions/ alterations, at its absolute discretion, without any liability whatsoever.

# 3 BEDROOM APARTMENT

TYPE A (with maid room + balcony)

TOTAL SALEABLE AREA  
 SUITE = 1,642.57 SQ.FT.  
 BALCONY = 274.54 SQ.FT.  
 TOTAL = 1,917.11 SQ.FT.

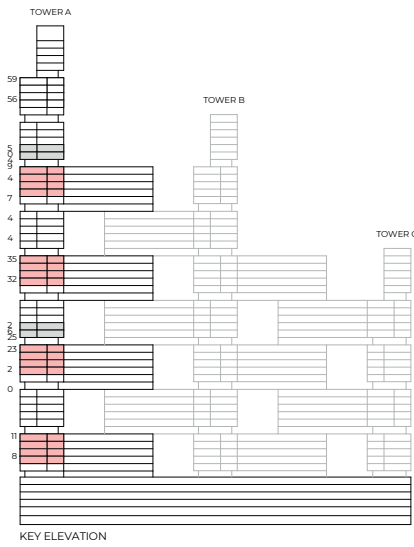

List of unit numbers with this unit plan:

## VIEWS

Downtown, Ras Al Khor, Creek, Golf Course, water body, Amenities  
 A807, A907, A1007, A1107, A2007, A2107, A2207, A2307

Downtown, Ras Al Khor, Creek, Golf Course, water body  
 A3207, A3307, A3407, A3507, A4407, A4507, A4607, A4707

Disclaimer: 1. All dimensions are in metric, measured to wall finishes. 2. All materials, dimensions & drawings are approximate. 3. Information is subject to change without notice, at developer's absolute discretion. 4. Actual area may vary from the stated area. 5. Drawing are not to scale. 6. All images used are for illustrative purpose only and do not represent the actual size, features, specifications, fittings and furnishings. 7. The developer reserves the right to make revisions/ alterations, at its absolute discretion, without any liability whatsoever.

# 3 BEDROOM APARTMENT

TYPE A (with maid room + balcony)

TOTAL SALEABLE AREA  
 SUITE = 1,642.57 SQ.FT.  
 BALCONY = 274.54 SQ.FT.  
 TOTAL = 1,917.11 SQ.FT.

■ UNIT

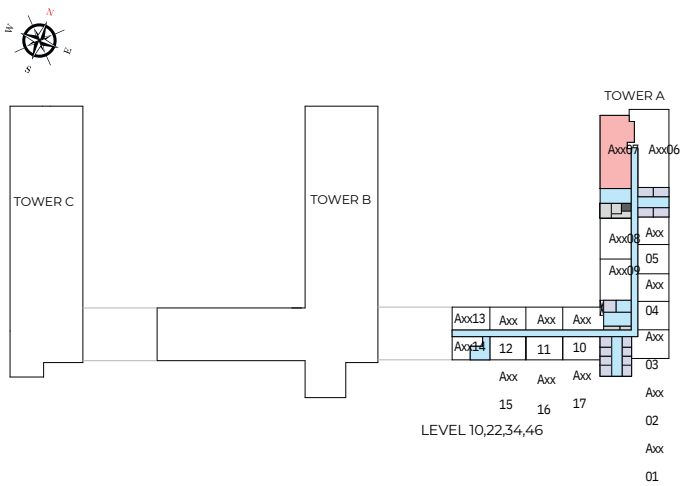
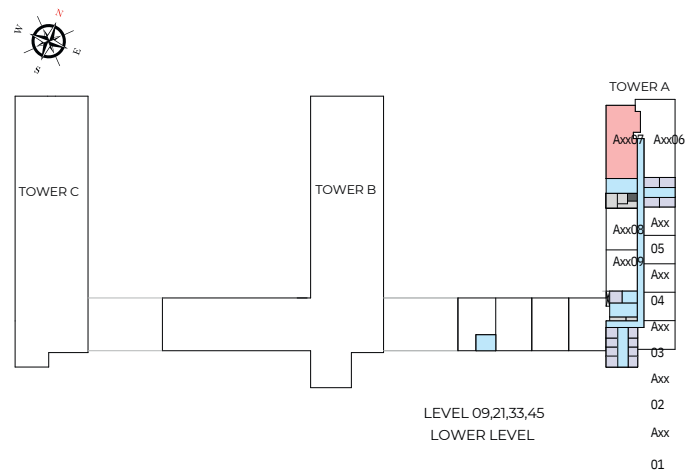
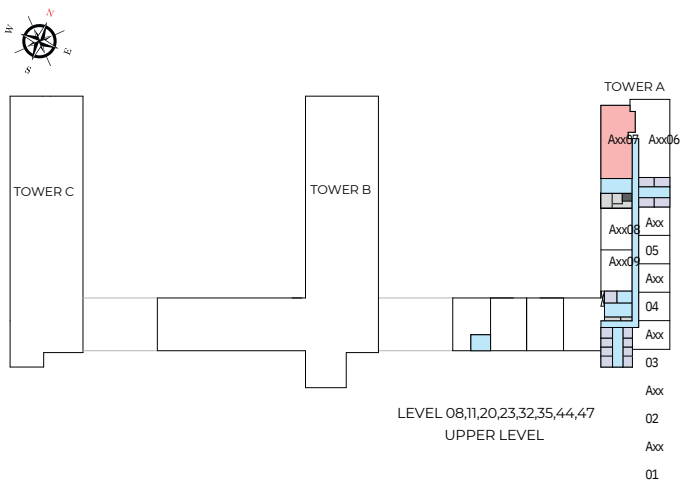

List of unit numbers with this unit plan:

## VIEWS

Downtown, Ras Al Khor, Creek, Golf Course, water body, Amenities  
 A807, A907, A1007, A1107, A2007, A2107, A2207, A2307

Downtown, Ras Al Khor, Creek, Golf Course, water body  
 A3207, A3307, A3407, A3507, A4407, A4507, A4607, A4707

Disclaimer: 1. All dimensions are in metric, measured to wall finishes. 2. All materials, dimensions & drawings are approximate. 3. Information is subject to change without notice, at developer's absolute discretion. 4. Actual area may vary from the stated area. 5. Drawing are not to scale. 6. All images used are for illustrative purpose only and do not represent the actual size, features, specifications, fittings and furnishings. 7. The developer reserves the right to make revisions/ alterations, at its absolute discretion, without any liability whatsoever.

# 3 BEDROOM APARTMENT

TYPE A (with maid room + balcony) VARIANT 1

TOTAL SALEABLE AREA  
 SUITE = 1,642.57 SQ.FT.  
 BALCONY = 274.54 SQ.FT.  
 TOTAL = 1,917.11 SQ.FT.



List of unit numbers with this unit plan:

## VIEWS

Ras Al Khor, Creek, Golf Course  
 A1406, A1506, A1606, A1706, A2706, A2806, A2906, A3806, A3906, A4006, A4106

Disclaimer: 1. All dimensions are in metric, measured to wall finishes. 2. All materials, dimensions & drawings are approximate. 3. Information is subject to change without notice, at developer's absolute discretion. 4. Actual area may vary from the stated area. 5. Drawing are not to scale. 6. All images used are for illustrative purpose only and do not represent the actual size, features, specifications, fittings and furnishings. 7. The developer reserves the right to make revisions/ alterations, at its absolute discretion, without any liability whatsoever.

# 3 BEDROOM APARTMENT

TYPE A (with maid room + balcony) VARIANT 1

TOTAL SALEABLE AREA  
SUITE = 1,642.57 SQ.FT.  
BALCONY = 274.54 SQ.FT.  
TOTAL = 1,917.11 SQ.FT.

 UNIT

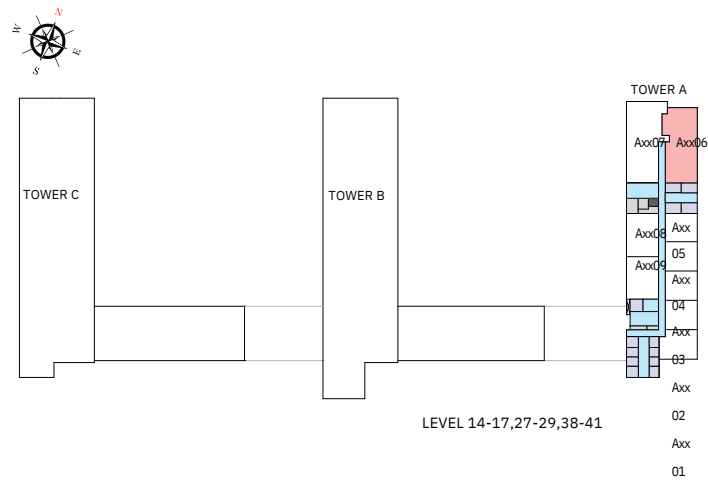

List of unit numbers with this unit plan:

## VIEWS

Ras Al Khor, Creek, Golf Course  
A1406, A1506, A1606, A1706, A2706, A2806, A2906, A3806, A3906, A4006, A4106

Disclaimer: 1. All dimensions are in metric, measured to wall finishes. 2. All materials, dimensions & drawings are approximate. 3. Information is subject to change without notice, at developer's absolute discretion. 4. Actual area may vary from the stated area. 5. Drawing are not to scale. 6. All images used are for illustrative purpose only and do not represent the actual size, features, specifications, fittings and furnishings. 7. The developer reserves the right to make revisions/ alterations, at its absolute discretion, without any liability whatsoever.

# 3 BEDROOM APARTMENT

TYPE C (with store room and maid room + yard)

TOTAL SALEABLE AREA  
 SUITE = 1,708.66 SQ.FT.  
 YARD = 782.88 SQ.FT.  
 TOTAL = 2,491.54 SQ.FT.

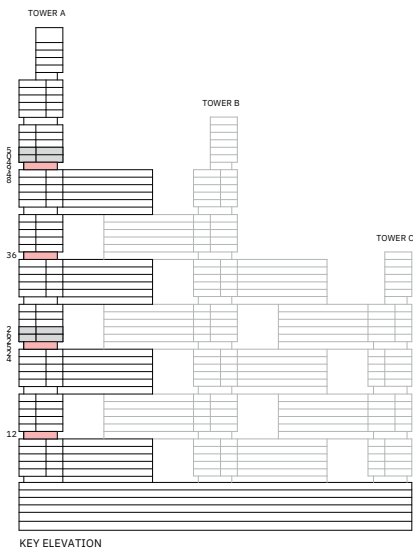

List of unit numbers with this unit plan:

## VIEWS

Downtown, Ras Al Khor, Creek, Golf Course, Waterbody  
 A1206, A2406, A3606, A4806

Disclaimer: 1. All dimensions are in metric, measured to wall finishes. 2. All materials, dimensions & drawings are approximate. 3. Information is subject to change without notice, at developer's absolute discretion. 4. Actual area may vary from the stated area. 5. Drawing are not to scale. 6. All images used are for illustrative purpose only and do not represent the actual size, features, specifications, fittings and furnishings. 7. The developer reserves the right to make revisions/ alterations, at its absolute discretion, without any liability whatsoever.



# 3 BEDROOM APARTMENT

TYPE C (with store room and maid room + yard)

TOTAL SALEABLE AREA  
SUITE = 1,708.66 SQ.FT.  
YARD = 782.88 SQ.FT.  
TOTAL = 2,491.54 SQ.FT.

UNIT

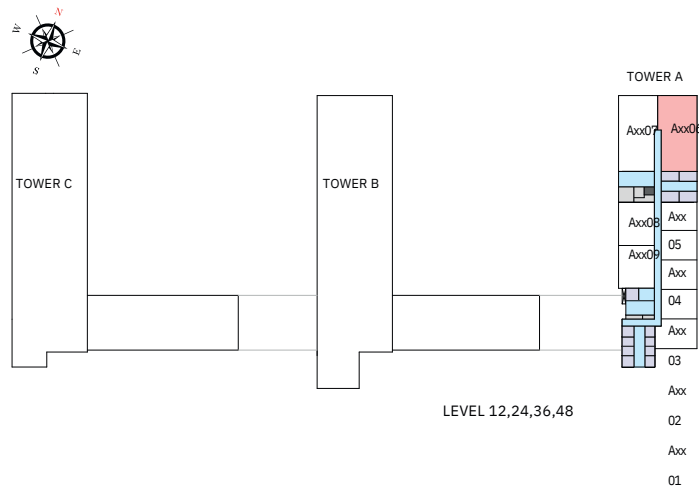

List of unit numbers with this unit plan:

## VIEWS

Downtown, Ras Al Khor, Creek, Golf Course, Waterbody  
A1206, A2406, A3606, A4806

Disclaimer: 1. All dimensions are in metric, measured to wall finishes. 2. All materials, dimensions & drawings are approximate. 3. Information is subject to change without notice, at developer's absolute discretion. 4. Actual area may vary from the stated area. 5. Drawing are not to scale. 6. All images used are for illustrative purpose only and do not represent the actual size, features, specifications, fittings and furnishings. 7. The developer reserves the right to make revisions/ alterations, at its absolute discretion, without any liability whatsoever.

# 3 BEDROOM APARTMENT

TYPE C (with store room and maid room + yard) VARIANT 1

TOTAL SALEABLE AREA  
 SUITE = 1,708.66 SQ.FT.  
 YARD = 782.88 SQ.FT.  
 TOTAL = 2,491.54 SQ.FT.

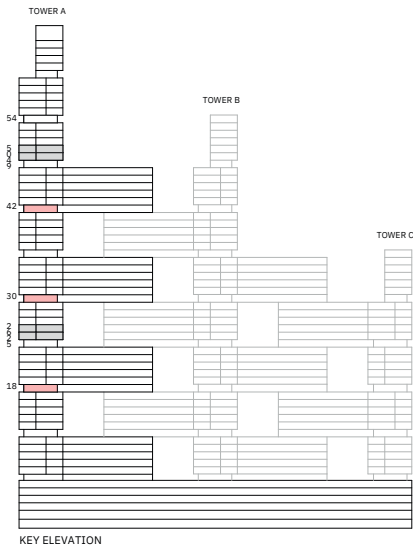

List of unit numbers with this unit plan:

## VIEWS

Downtown, Ras Al Khor, Creek, Golf Course, water body, Amenities  
 A1807

Downtown, Ras Al Khor, Creek, Golf Course, water body  
 A3007, A4207

Disclaimer: 1. All dimensions are in metric, measured to wall finishes. 2. All materials, dimensions & drawings are approximate. 3. Information is subject to change without notice, at developer's absolute discretion. 4. Actual area may vary from the stated area. 5. Drawing are not to scale. 6. All images used are for illustrative purpose only and do not represent the actual size, features, specifications, fittings and furnishings. 7. The developer reserves the right to make revisions/ alterations, at its absolute discretion, without any liability whatsoever.

# 3 BEDROOM APARTMENT

TYPE C (with store room and maid room + yard) VARIANT 1

TOTAL SALEABLE AREA  
SUITE = 1,708.66 SQ.FT.  
YARD = 782.88 SQ.FT.  
TOTAL = 2,491.54 SQ.FT.

UNIT

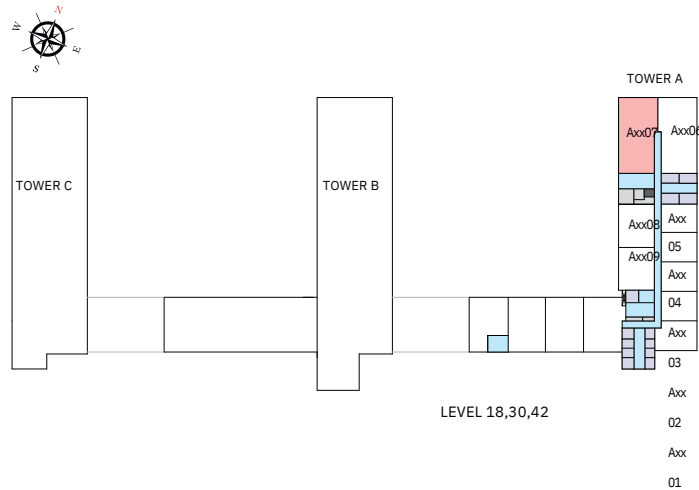

List of unit numbers with this unit plan:

## VIEWS

Downtown, Ras Al Khor, Creek, Golf Course, water body, Amenities  
A1807

Downtown, Ras Al Khor, Creek, Golf Course, water body  
A3007, A4207

Disclaimer: 1. All dimensions are in metric, measured to wall finishes. 2. All materials, dimensions & drawings are approximate. 3. Information is subject to change without notice, at developer's absolute discretion. 4. Actual area may vary from the stated area. 5. Drawing are not to scale. 6. All images used are for illustrative purpose only and do not represent the actual size, features, specifications, fittings and furnishings. 7. The developer reserves the right to make revisions/ alterations, at its absolute discretion, without any liability whatsoever.

# 3 BEDROOM APARTMENT

TYPE D (with store room and maid room + yard)

TOTAL SALEABLE AREA  
 SUITE = 1,708.66 SQ.FT.  
 YARD = 536.03 SQ.FT.  
 TOTAL = 2,244.69 SQ.FT.

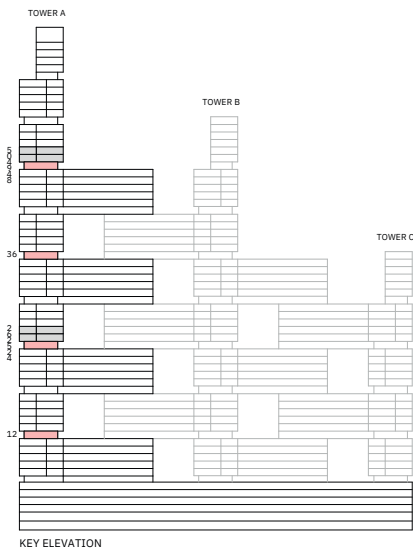

List of unit numbers with this unit plan:

## VIEWS

Downtown, Ras Al Khor, Creek, Golf Course, water body, Amenities  
 A1207, A2407

Downtown, Ras Al Khor, Creek, Golf Course, water body  
 A3607, A4807

Disclaimer: 1. All dimensions are in metric, measured to wall finishes. 2. All materials, dimensions & drawings are approximate. 3. Information is subject to change without notice, at developer's absolute discretion. 4. Actual area may vary from the stated area. 5. Drawing are not to scale. 6. All images used are for illustrative purpose only and do not represent the actual size, features, specifications, fittings and furnishings. 7. The developer reserves the right to make revisions/ alterations, at its absolute discretion, without any liability whatsoever.

# 3 BEDROOM APARTMENT

TYPE D (with store room and maid room + yard)

TOTAL SALEABLE AREA  
SUITE = 1,708.66 SQ.FT.  
YARD = 536.03 SQ.FT.  
TOTAL = 2,244.69 SQ.FT.

 UNIT

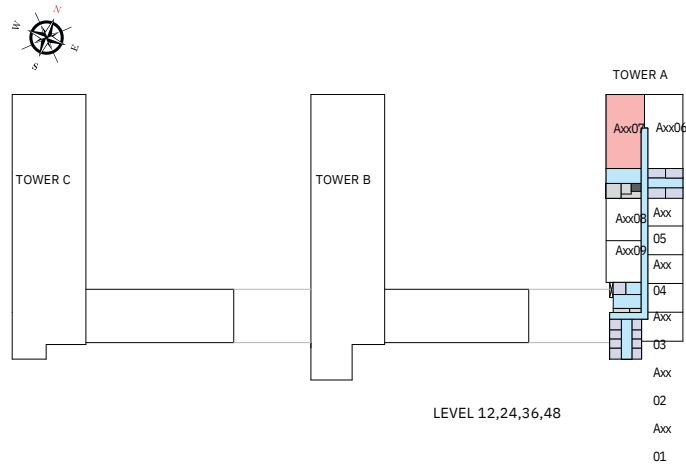

List of unit numbers with this unit plan:

## VIEWS

Downtown, Ras Al Khor, Creek, Golf Course, water body, Amenities  
A1207, A2407

Downtown, Ras Al Khor, Creek, Golf Course, water body  
A3607, A4807

Disclaimer: 1. All dimensions are in metric, measured to wall finishes. 2. All materials, dimensions & drawings are approximate. 3. Information is subject to change without notice, at developer's absolute discretion. 4. Actual area may vary from the stated area. 5. Drawing are not to scale. 6. All images used are for illustrative purpose only and do not represent the actual size, features, specifications, fittings and furnishings. 7. The developer reserves the right to make revisions/ alterations, at its absolute discretion, without any liability whatsoever.

# 3 BEDROOM APARTMENT

TYPE D (with store room and maid room + yard) VARIANT 1

TOTAL SALEABLE AREA  
 SUITE = 1,708.66 SQ.FT.  
 YARD = 536.03 SQ.FT.  
 TOTAL = 2,244.69 SQ.FT.

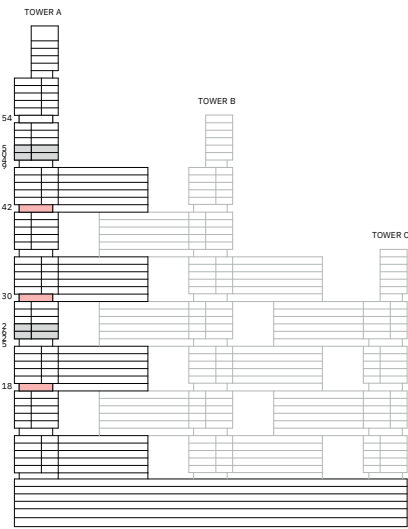

KEY ELEVATION

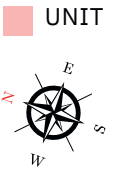

List of unit numbers with this unit plan:

## VIEWS

Downtown, Ras Al Khor, Creek, Golf Course, water body  
 A1806, A3006, A4206

Disclaimer: 1. All dimensions are in metric, measured to wall finishes. 2. All materials, dimensions & drawings are approximate. 3. Information is subject to change without notice, at developer's absolute discretion. 4. Actual area may vary from the stated area. 5. Drawing are not to scale. 6. All images used are for illustrative purpose only and do not represent the actual size, features, specifications, fittings and furnishings. 7. The developer reserves the right to make revisions/ alterations, at its absolute discretion, without any liability whatsoever.

# 3 BEDROOM APARTMENT

TYPE D (with store room and maid room + yard) VARIANT 1

TOTAL SALEABLE AREA  
SUITE = 1,708.66 SQ.FT.  
YARD = 536.03 SQ.FT.  
TOTAL = 2,244.69 SQ.FT.

UNIT

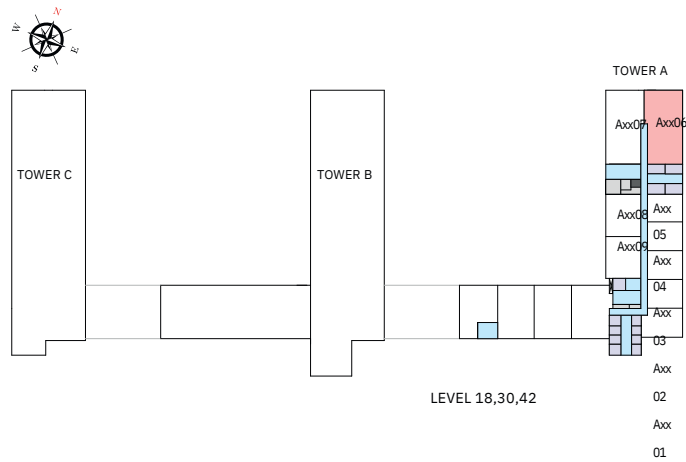

List of unit numbers with this unit plan:

## VIEWS

Downtown, Ras Al Khor, Creek, Golf Course, water body  
A1806, A3006, A4206

Disclaimer: 1. All dimensions are in metric, measured to wall finishes. 2. All materials, dimensions & drawings are approximate. 3. Information is subject to change without notice, at developer's absolute discretion. 4. Actual area may vary from the stated area. 5. Drawing are not to scale. 6. All images used are for illustrative purpose only and do not represent the actual size, features, specifications, fittings and furnishings. 7. The developer reserves the right to make revisions/ alterations, at its absolute discretion, without any liability whatsoever.

# 3 BEDROOM APARTMENT

TYPE E (with maid room + yard)

TOTAL SALEABLE AREA  
 SUITE = 1,642.57 SQ.FT.  
 YARD = 539.66 SQ.FT.  
 TOTAL = 2,182.23 SQ.FT.

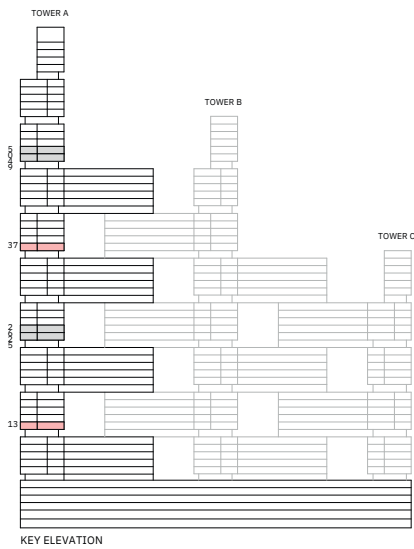

List of unit numbers with this unit plan:

## VIEWS

Ras Al Khor, Creek, Golf Course  
 A1306, A3706

Disclaimer: 1. All dimensions are in metric, measured to wall finishes. 2. All materials, dimensions & drawings are approximate. 3. Information is subject to change without notice, at developer's absolute discretion. 4. Actual area may vary from the stated area. 5. Drawing are not to scale. 6. All images used are for illustrative purpose only and do not represent the actual size, features, specifications, fittings and furnishings. 7. The developer reserves the right to make revisions/ alterations, at its absolute discretion, without any liability whatsoever.



# 3 BEDROOM APARTMENT

TYPE E (with maid room + yard)

TOTAL SALEABLE AREA  
SUITE = 1,642.57 SQ.FT.  
YARD = 539.66 SQ.FT.  
TOTAL = 2,182.23 SQ.FT.

UNIT

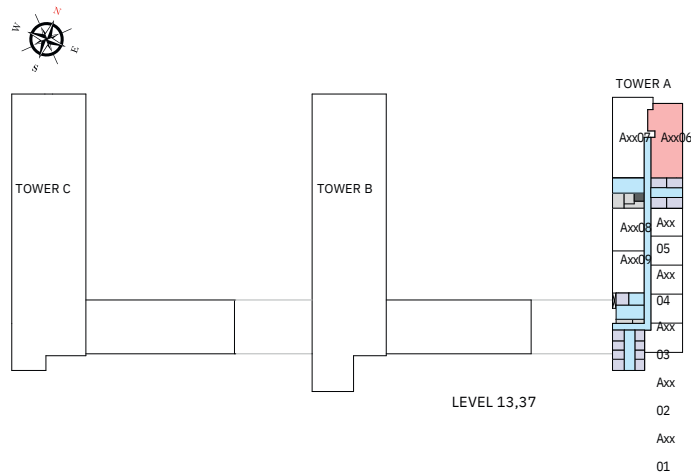

List of unit numbers with this unit plan:

## VIEWS

Ras Al Khor, Creek, Golf Course  
A1306, A3706

Disclaimer: 1. All dimensions are in metric, measured to wall finishes. 2. All materials, dimensions & drawings are approximate. 3. Information is subject to change without notice, at developer's absolute discretion. 4. Actual area may vary from the stated area. 5. Drawing are not to scale. 6. All images used are for illustrative purpose only and do not represent the actual size, features, specifications, fittings and furnishings. 7. The developer reserves the right to make revisions/ alterations, at its absolute discretion, without any liability whatsoever.

# 3 BEDROOM APARTMENT

## TYPE E (with maid room + yard) VARIANT 1

TOTAL SALEABLE AREA  
 SUITE = 1,642.57 SQ.FT.  
 YARD = 539.66 SQ.FT.  
 TOTAL = 2,182.23 SQ.FT.

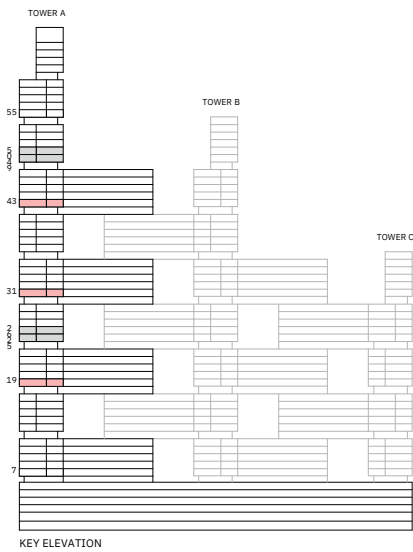

List of unit numbers with this unit plan:

### VIEWS

Downtown, Ras Al Khor, Creek, Golf Course, water body, Amenities  
 A1907

Downtown, Ras Al Khor, Creek, Golf Course, water body  
 A3107, A4307

Disclaimer: 1. All dimensions are in metric, measured to wall finishes. 2. All materials, dimensions & drawings are approximate. 3. Information is subject to change without notice, at developer's absolute discretion. 4. Actual area may vary from the stated area. 5. Drawing are not to scale. 6. All images used are for illustrative purpose only and do not represent the actual size, features, specifications, fittings and furnishings. 7. The developer reserves the right to make revisions/ alterations, at its absolute discretion, without any liability whatsoever.

**3 BEDROOM APARTMENT**  
 TYPE E (with maid room + yard) VARIANT 1

TOTAL SALEABLE AREA  
 SUITE = 1,642.57 SQ.FT.  
 YARD = 539.66 SQ.FT.  
 TOTAL = 2,182.23 SQ.FT.

UNIT

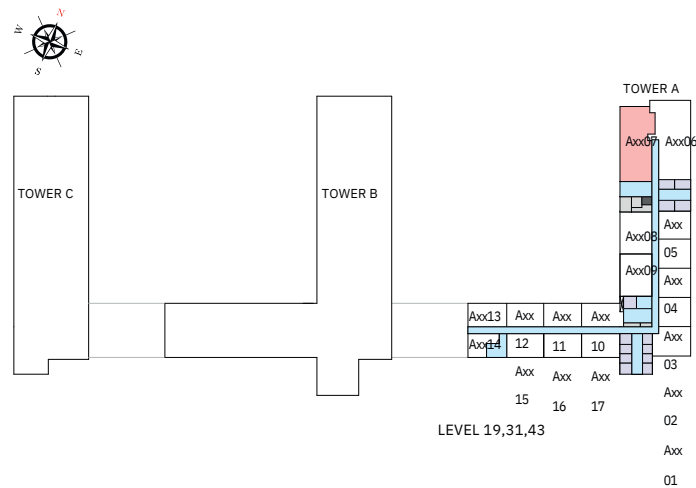

List of unit numbers with this unit plan:

**VIEWS**

Downtown, Ras Al Khor, Creek, Golf Course, water body, Amenities  
 A1907

Downtown, Ras Al Khor, Creek, Golf Course, water body  
 A3107, A4307

Disclaimer: 1. All dimensions are in metric, measured to wall finishes. 2. All materials, dimensions & drawings are approximate. 3. Information is subject to change without notice, at developer's absolute discretion. 4. Actual area may vary from the stated area. 5. Drawing are not to scale. 6. All images used are for illustrative purpose only and do not represent the actual size, features, specifications, fittings and furnishings. 7. The developer reserves the right to make revisions/ alterations, at its absolute discretion, without any liability whatsoever.

# 4 BEDROOM APARTMENT

TYPE A (with store room, maid room and powder room + balcony)

TOTAL SALEABLE AREA  
 SUITE = 2,080.88 SQ.FT.  
 BALCONY = 196.34 SQ.FT.  
 TOTAL = 2,277.22 SQ.FT.

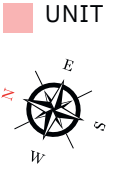
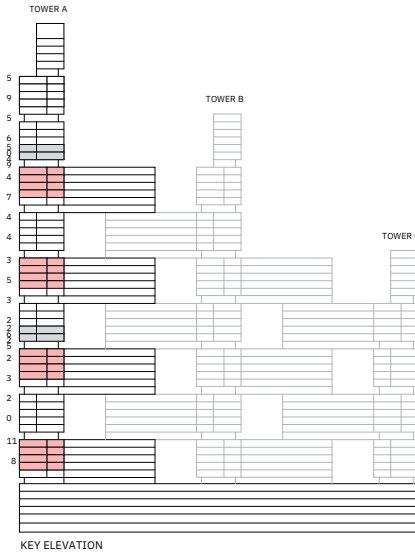

List of unit numbers with this unit plan:

## VIEWS

Downtown, Ras Al Khor, Creek, Golf Course, waterbody  
 A806, A906, A1006, A1106, A2006, A2106, A2206, A2306, A3206, A3306, A3406, A3506, A4406, A4506, A4606, A4706

Disclaimer: 1. All dimensions are in metric, measured to wall finishes. 2. All materials, dimensions & drawings are approximate. 3. Information is subject to change without notice, at developer's absolute discretion. 4. Actual area may vary from the stated area. 5. Drawing are not to scale. 6. All images used are for illustrative purpose only and do not represent the actual size, features, specifications, fittings and furnishings. 7. The developer reserves the right to make revisions/ alterations, at its absolute discretion, without any liability whatsoever.

# 4 BEDROOM APARTMENT

TYPE A (with store room, maid room and powder room + balcony)

TOTAL SALEABLE AREA  
 SUITE = 2,080.88 SQ.FT.  
 BALCONY = 196.34 SQ.FT.  
 TOTAL = 2,277.22 SQ.FT.

UNIT

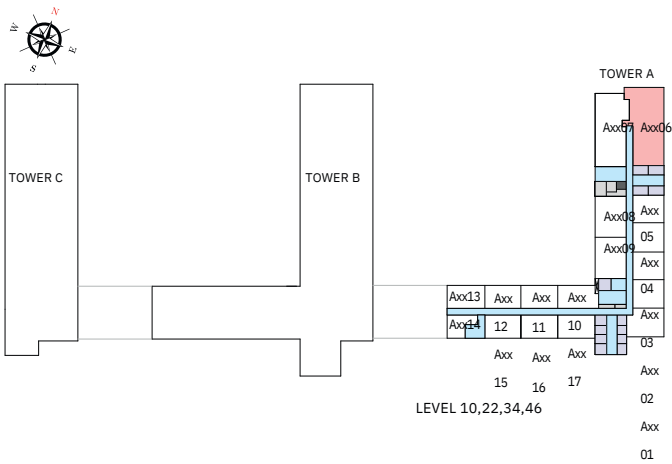
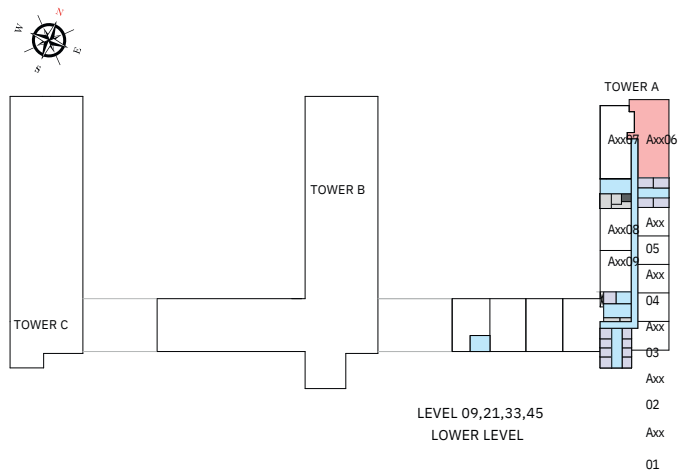
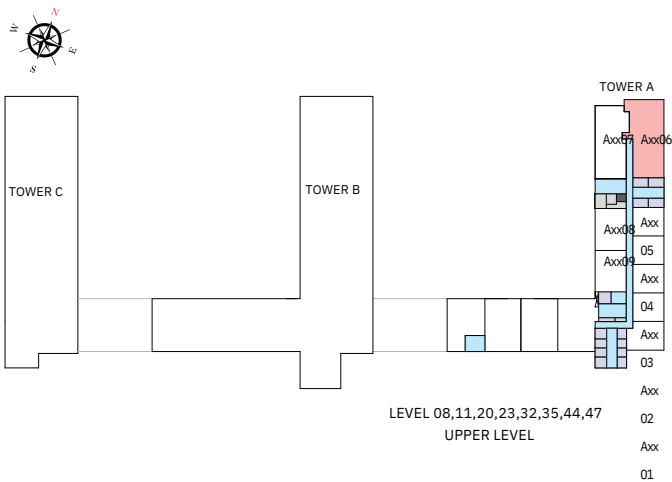

List of unit numbers with this unit plan:

## VIEWS

Downtown, Ras Al Khor, Creek, Golf Course, waterbody  
 A806, A906, A1006, A1106, A2006, A2106, A2206, A2306, A3206, A3306, A3406, A3506, A4406, A4506, A4606, A4706

Disclaimer: 1. All dimensions are in metric, measured to wall finishes. 2. All materials, dimensions & drawings are approximate. 3. Information is subject to change without notice, at developer's absolute discretion. 4. Actual area may vary from the stated area. 5. Drawing are not to scale. 6. All images used are for illustrative purpose only and do not represent the actual size, features, specifications, fittings and furnishings. 7. The developer reserves the right to make revisions/ alterations, at its absolute discretion, without any liability whatsoever.

# 4 BEDROOM APARTMENT

TYPE A (with store room, maid room and powder room + balcony) VARIANT 1

TOTAL SALEABLE AREA  
 SUITE = 2,080.88 SQ.FT.  
 BALCONY = 196.34 SQ.FT.  
 TOTAL = 2,277.22 SQ.FT.

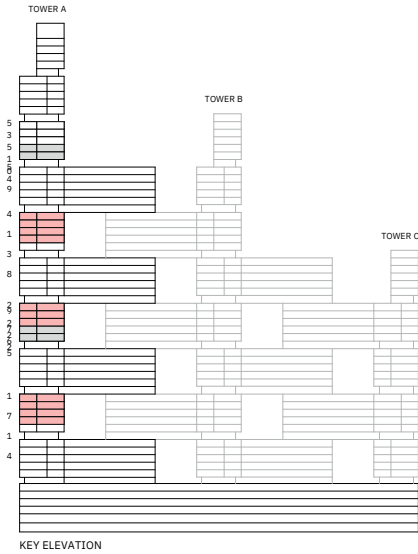

List of unit numbers with this unit plan:

## VIEWS

Downtown, Ras Al Khor, Creek, Golf Course, water body, Amenities  
 A1407, A1507, A1607, A1707

Downtown, Ras Al Khor, Creek, Golf Course, water body  
 A2707, A2807, A2907, A3807, A3907, A4007, A4107

Disclaimer: 1. All dimensions are in metric, measured to wall finishes. 2. All materials, dimensions & drawings are approximate. 3. Information is subject to change without notice, at developer's absolute discretion. 4. Actual area may vary from the stated area. 5. Drawing are not to scale. 6. All images used are for illustrative purpose only and do not represent the actual size, features, specifications, fittings and furnishings. 7. The developer reserves the right to make revisions/ alterations, at its absolute discretion, without any liability whatsoever.

# 4 BEDROOM APARTMENT

TYPE A (with store room, maid room and powder room + balcony) VARIANT 1

TOTAL SALEABLE AREA  
SUITE = 2,080.88 SQ.FT.  
BALCONY = 196.34 SQ.FT.  
TOTAL = 2,277.22 SQ.FT.

 UNIT

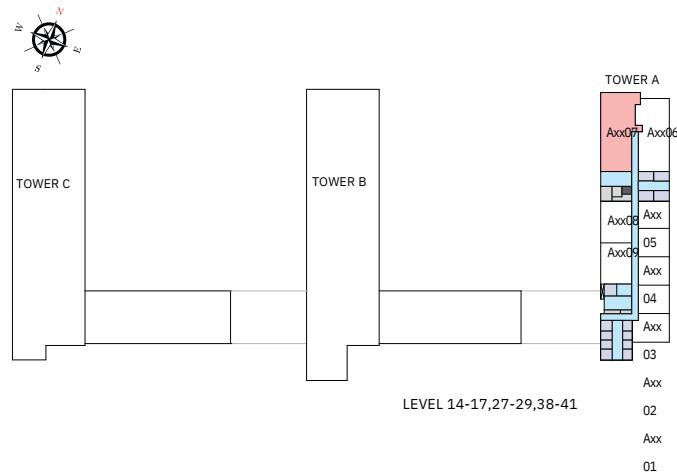

List of unit numbers with this unit plan:

## VIEWS

Downtown, Ras Al Khor, Creek, Golf Course, water body, Amenities  
A1407, A1507, A1607, A1707

Downtown, Ras Al Khor, Creek, Golf Course, water body  
A2707, A2807, A2907, A3807, A3907, A4007, A4107

Disclaimer: 1. All dimensions are in metric, measured to wall finishes. 2. All materials, dimensions & drawings are approximate. 3. Information is subject to change without notice, at developer's absolute discretion. 4. Actual area may vary from the stated area. 5. Drawing are not to scale. 6. All images used are for illustrative purpose only and do not represent the actual size, features, specifications, fittings and furnishings. 7. The developer reserves the right to make revisions/ alterations, at its absolute discretion, without any liability whatsoever.

# 4 BEDROOM APARTMENT

TYPE B (with store room, maid room and powder room + yard)

TOTAL SALEABLE AREA  
 SUITE = 2,084.43 SQ.FT.  
 YARD = 477.92 SQ.FT.  
 TOTAL = 2,562.35 SQ.FT.

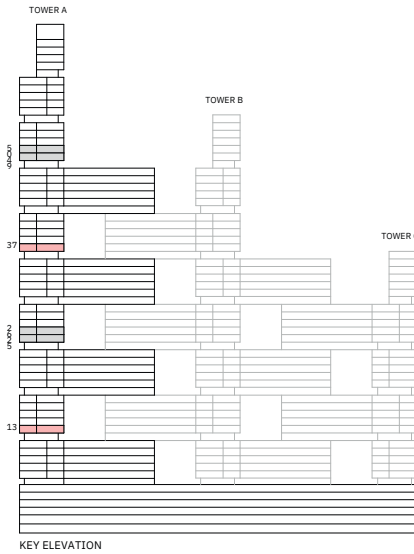

List of unit numbers with this unit plan:

## VIEWS

Downtown, Ras Al Khor, Creek, Golf Course, water body, Amenities  
 A1307

Downtown, Ras Al Khor, Creek, Golf Course, water body  
 A3707

Disclaimer: 1. All dimensions are in metric, measured to wall finishes. 2. All materials, dimensions & drawings are approximate. 3. Information is subject to change without notice, at developer's absolute discretion. 4. Actual area may vary from the stated area. 5. Drawing are not to scale. 6. All images used are for illustrative purpose only and do not represent the actual size, features, specifications, fittings and furnishings. 7. The developer reserves the right to make revisions/ alterations, at its absolute discretion, without any liability whatsoever.



# 4 BEDROOM APARTMENT

TYPE B (with store room, maid room and powder room + yard)

TOTAL SALEABLE AREA  
SUITE = 2,084.43 SQ.FT.  
YARD = 477.92 SQ.FT.  
TOTAL = 2,562.35 SQ.FT.

 UNIT

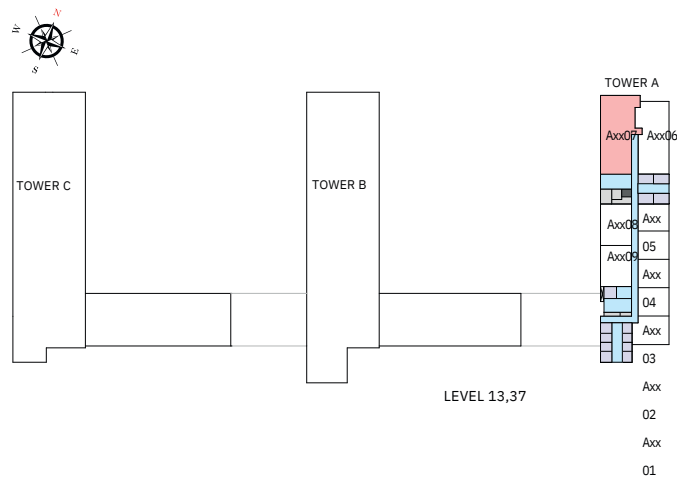

List of unit numbers with this unit plan:

## VIEWS

Downtown, Ras Al Khor, Creek, Golf Course, water body, Amenities  
A1307

Downtown, Ras Al Khor, Creek, Golf Course, water body  
A3707

Disclaimer: 1. All dimensions are in metric, measured to wall finishes. 2. All materials, dimensions & drawings are approximate. 3. Information is subject to change without notice, at developer's absolute discretion. 4. Actual area may vary from the stated area. 5. Drawing are not to scale. 6. All images used are for illustrative purpose only and do not represent the actual size, features, specifications, fittings and furnishings. 7. The developer reserves the right to make revisions/ alterations, at its absolute discretion, without any liability whatsoever.

# 4 BEDROOM APARTMENT

TYPE B (with store room, maid room and powder room + yard) VARIANT 1

TOTAL SALEABLE AREA  
 SUITE = 2,084.43 SQ.FT.  
 YARD = 477.32 SQ.FT.  
 TOTAL = 2,562.35 SQ.FT.

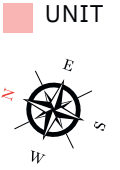
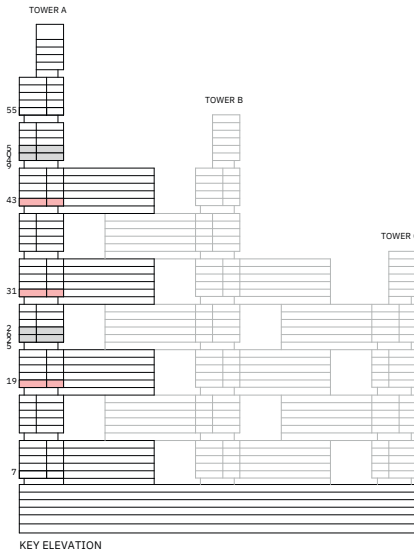

List of unit numbers with this unit plan:

## VIEWS

Downtown, Ras Al Khor, Creek, Golf Course, waterbody  
 A1906, A3106, A4306

Disclaimer: 1. All dimensions are in metric, measured to wall finishes. 2. All materials, dimensions & drawings are approximate. 3. Information is subject to change without notice, at developer's absolute discretion. 4. Actual area may vary from the stated area. 5. Drawing are not to scale. 6. All images used are for illustrative purpose only and do not represent the actual size, features, specifications, fittings and furnishings. 7. The developer reserves the right to make revisions/ alterations, at its absolute discretion, without any liability whatsoever.

# 4 BEDROOM APARTMENT

TYPE B (with store room, maid room and powder room + yard) VARIANT 1

TOTAL SALEABLE AREA  
 SUITE = 2,084.43 SQ.FT.  
 YARD = 477.32 SQ.FT.  
 TOTAL = 2,562.35 SQ.FT.

■ UNIT

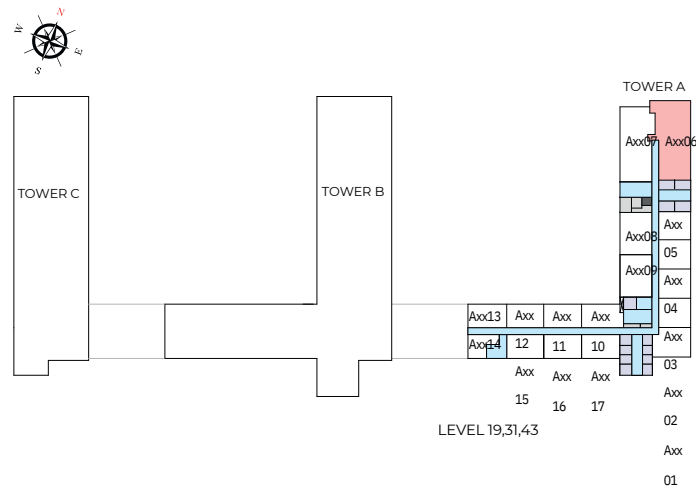

List of unit numbers with this unit plan:

## VIEWS

Downtown, Ras Al Khor, Creek, Golf Course, waterbody  
 A1906, A3106, A4306

Disclaimer: 1. All dimensions are in metric, measured to wall finishes. 2. All materials, dimensions & drawings are approximate. 3. Information is subject to change without notice, at developer's absolute discretion. 4. Actual area may vary from the stated area. 5. Drawing are not to scale. 6. All images used are for illustrative purpose only and do not represent the actual size, features, specifications, fittings and furnishings. 7. The developer reserves the right to make revisions/ alterations, at its absolute discretion, without any liability whatsoever.

# 2 BEDROOM DUPLEX APARTMENT

TYPE A (with store room, maid room and powder room + balcony)

TOTAL SALEABLE AREA  
 SUITE = 1,701.76 SQ.FT.  
 BALCONY = 178.96 SQ.FT.  
 TOTAL = 1,880.72 SQ.FT.

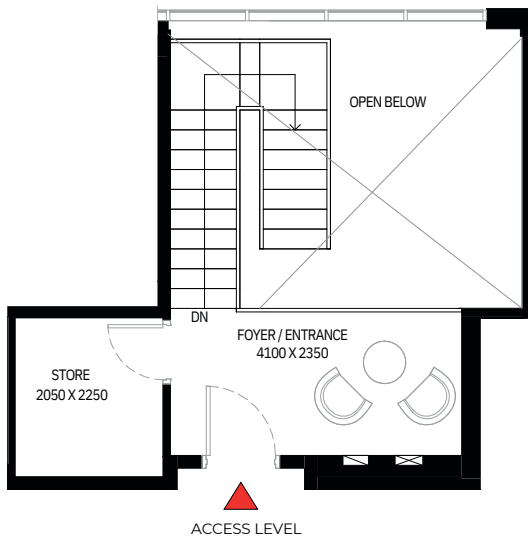
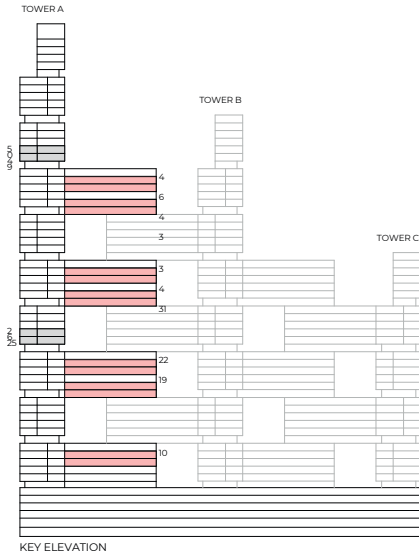

List of unit numbers with this unit plan:

## VIEWS

Ras Al Khor, Golf Course, Amenities  
 A1014, A1914, A2214

Ras Al Khor, Golf Course  
 A3114, A3414, A4314, A4614

Disclaimer: 1. All dimensions are in metric, measured to wall finishes. 2. All materials, dimensions & drawings are approximate. 3. Information is subject to change without notice, at developer's absolute discretion. 4. Actual area may vary from the stated area. 5. Drawing are not to scale. 6. All images used are for illustrative purpose only and do not represent the actual size, features, specifications, fittings and furnishings. 7. The developer reserves the right to make revisions/ alterations, at its absolute discretion, without any liability whatsoever.

# 2 BEDROOM DUPLEX APARTMENT

TYPE A (with store room, maid room and powder room + balcony)

TOTAL SALEABLE AREA  
 SUITE = 1,701.76 SQ.FT.  
 BALCONY = 178.96 SQ.FT.  
 TOTAL = 1,880.72 SQ.FT.

UNIT

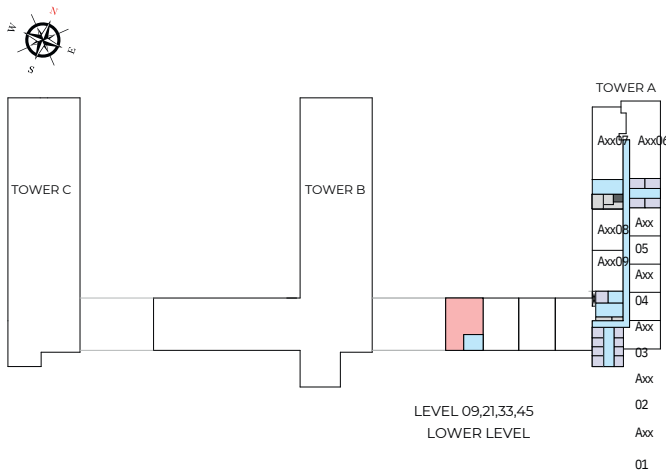
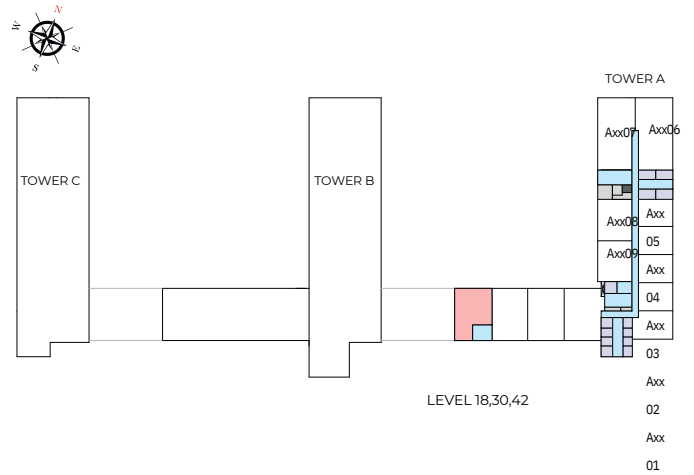
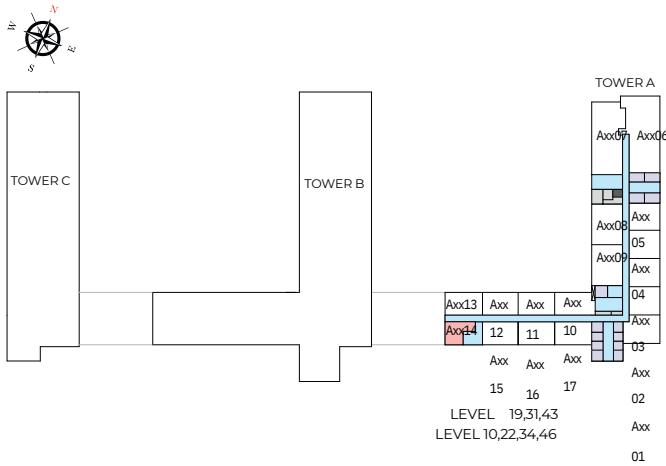

List of unit numbers with this unit plan:

## VIEWS

Ras Al Khor, Golf Course, Amenities  
 A1014, A1914, A2214

Ras Al Khor, Golf Course  
 A3114, A3414, A4314, A4614

Disclaimer: 1. All dimensions are in metric, measured to wall finishes. 2. All materials, dimensions & drawings are approximate. 3. Information is subject to change without notice, at developer's absolute discretion. 4. Actual area may vary from the stated area. 5. Drawing are not to scale. 6. All images used are for illustrative purpose only and do not represent the actual size, features, specifications, fittings and furnishings. 7. The developer reserves the right to make revisions/ alterations, at its absolute discretion, without any liability whatsoever.

# 4 BEDROOM DUPLEX APARTMENT

## TYPE A (with maid room and powder room + balcony)

TOTAL SALEABLE AREA  
 SUITE = 2,176.53 SQ.FT.  
 BALCONY = 176.25 SQ.FT.  
 TOTAL = 2,352.78 SQ.FT.

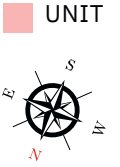
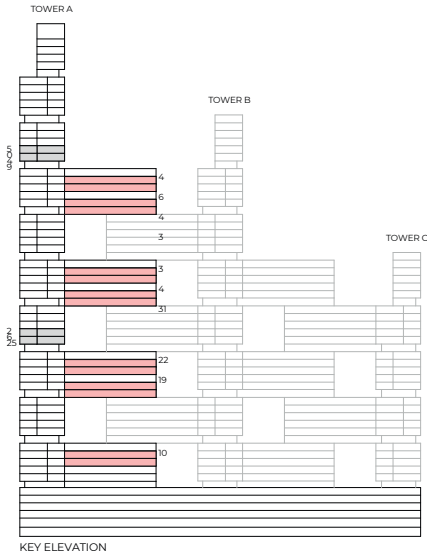

List of unit numbers with this unit plan:

### VIEWS

Ras Al Khor, Golf Course, Amenities  
 A1015, A1915, A2215

Ras Al Khor, Golf Course  
 A3115, A3415, A4315, A4615

Disclaimer: 1. All dimensions are in metric, measured to wall finishes. 2. All materials, dimensions & drawings are approximate. 3. Information is subject to change without notice, at developer's absolute discretion. 4. Actual area may vary from the stated area. 5. Drawing are not to scale. 6. All images used are for illustrative purpose only and do not represent the actual size, features, specifications, fittings and furnishings. 7. The developer reserves the right to make revisions/ alterations, at its absolute discretion, without any liability whatsoever.

# 4 BEDROOM DUPLEX APARTMENT

## TYPE A (with maid room and powder room + balcony)

TOTAL SALEABLE AREA  
 SUITE = 2,176.53 SQ.FT.  
 BALCONY = 176.25 SQ.FT.  
 TOTAL = 2,352.78 SQ.FT.

■ UNIT

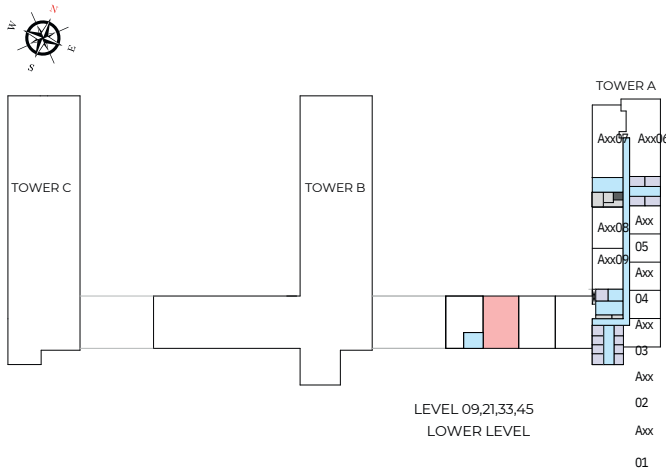
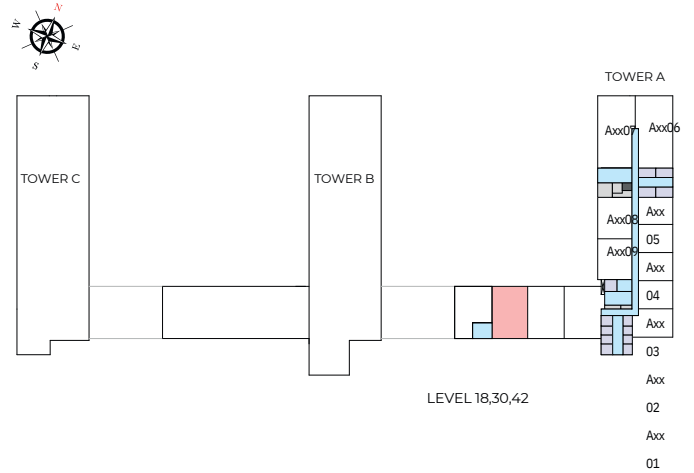
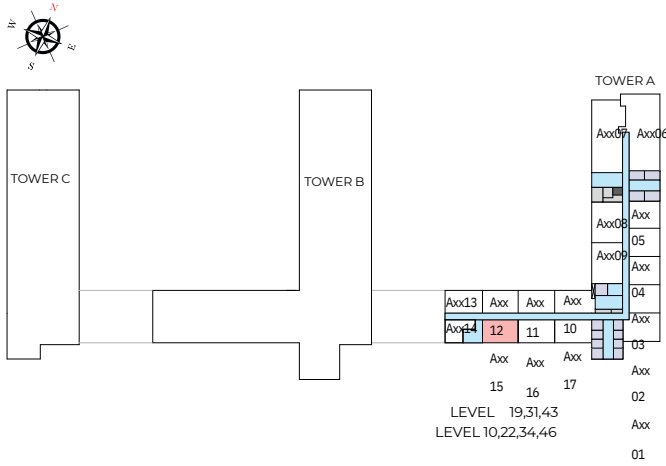

List of unit numbers with this unit plan:

### VIEWS

Ras Al Khor, Golf Course, Amenities  
 A1015, A1915, A2215

Ras Al Khor, Golf Course  
 A3115, A3415, A4315, A4615

Disclaimer: 1. All dimensions are in metric, measured to wall finishes. 2. All materials, dimensions & drawings are approximate. 3. Information is subject to change without notice, at developer's absolute discretion. 4. Actual area may vary from the stated area. 5. Drawing are not to scale. 6. All images used are for illustrative purpose only and do not represent the actual size, features, specifications, fittings and furnishings. 7. The developer reserves the right to make revisions/ alterations, at its absolute discretion, without any liability whatsoever.

# 4 BEDROOM DUPLEX APARTMENT

TYPE A (with maid room and powder room + balcony) VARIANT 1

TOTAL SALEABLE AREA  
 SUITE = 2,172.85 SQ.FT.  
 BALCONY = 176.25 SQ.FT.  
 TOTAL = 2,349.10 SQ.FT.

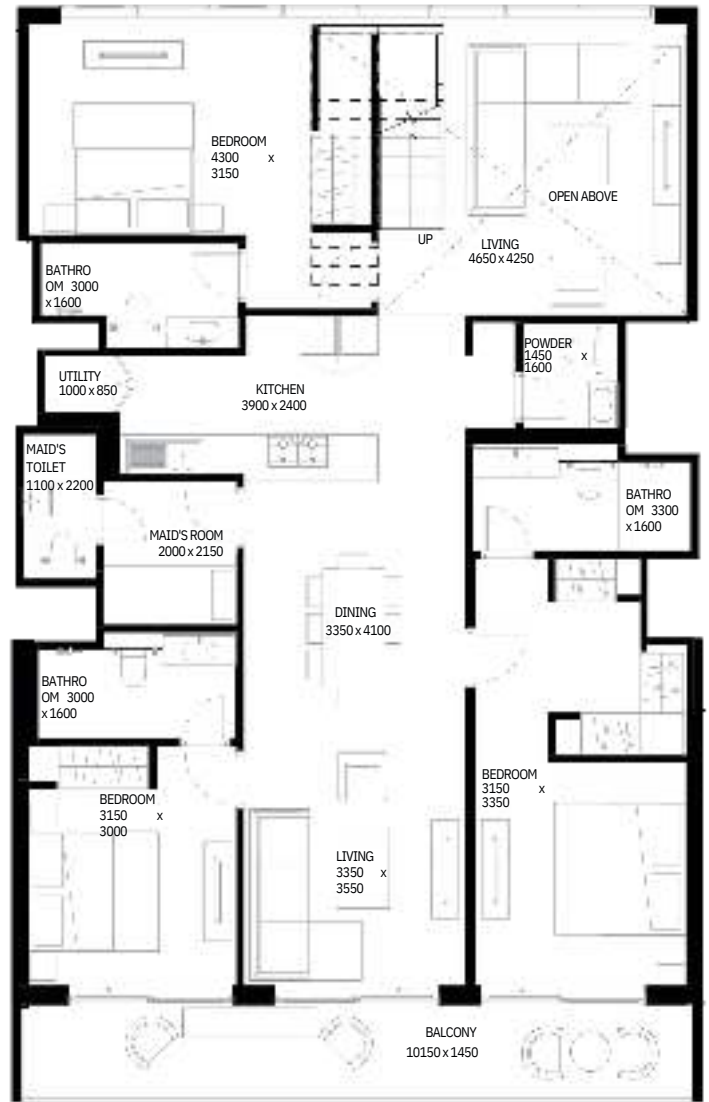
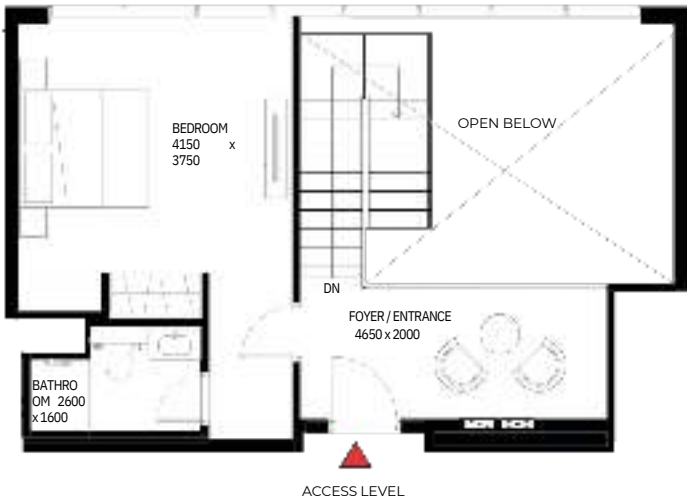
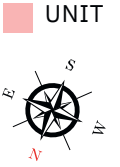
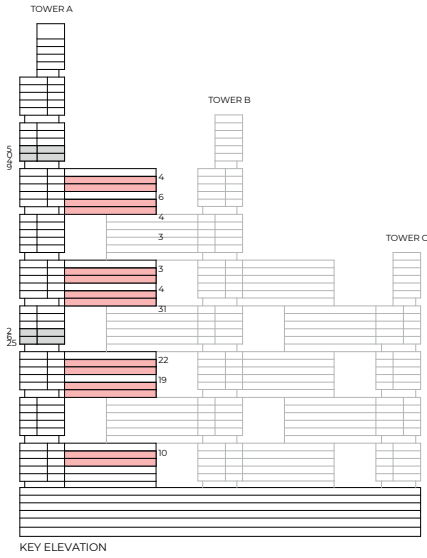

List of unit numbers with this unit plan:

## VIEWS

Ras Al Khor, Golf Course, Amenities  
 A1016, A1916, A2216

Ras Al Khor, Golf Course  
 A3116, A3416, A4316, A4616

Disclaimer: 1. All dimensions are in metric, measured to wall finishes. 2. All materials, dimensions & drawings are approximate. 3. Information is subject to change without notice, at developer's absolute discretion. 4. Actual area may vary from the stated area. 5. Drawing are not to scale. 6. All images used are for illustrative purpose only and do not represent the actual size, features, specifications, fittings and furnishings. 7. The developer reserves the right to make revisions/ alterations, at its absolute discretion, without any liability whatsoever.



# 4 BEDROOM DUPLEX APARTMENT

TYPE A (with maid room and powder room + balcony) VARIANT 1

TOTAL SALEABLE AREA  
 SUITE = 2,172.85 SQ.FT.  
 BALCONY = 176.25 SQ.FT.  
 TOTAL = 2,349.10 SQ.FT.

UNIT

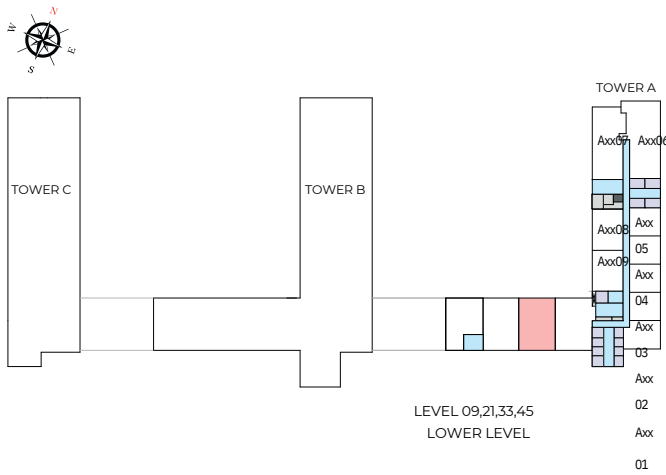
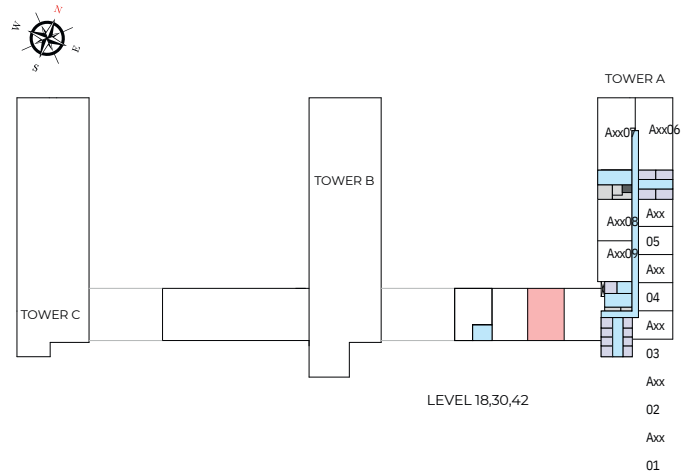
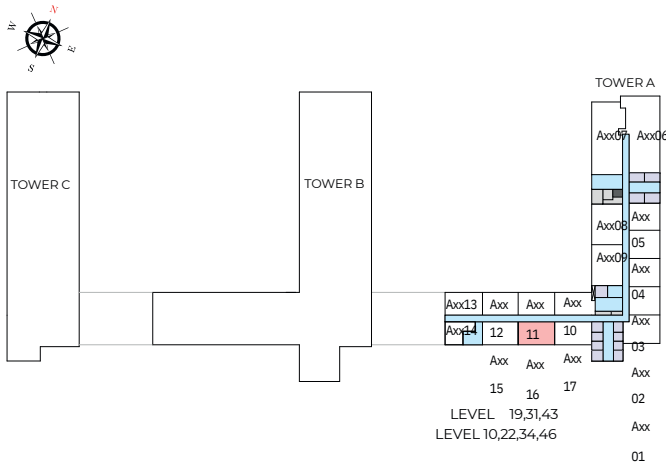

List of unit numbers with this unit plan:

## VIEWS

Ras Al Khor, Golf Course, Amenities  
 A1016, A1916, A2216

Ras Al Khor, Golf Course  
 A3116, A3416, A4316, A4616

Disclaimer: 1. All dimensions are in metric, measured to wall finishes. 2. All materials, dimensions & drawings are approximate. 3. Information is subject to change without notice, at developer's absolute discretion. 4. Actual area may vary from the stated area. 5. Drawing are not to scale. 6. All images used are for illustrative purpose only and do not represent the actual size, features, specifications, fittings and furnishings. 7. The developer reserves the right to make revisions/ alterations, at its absolute discretion, without any liability whatsoever.

# 4 BEDROOM DUPLEX APARTMENT

TYPE A1 (with maid room and powder room + balcony)

TOTAL SALEABLE AREA  
 SUITE = 2,227.74 SQ.FT.  
 BALCONY = 173.33 SQ.FT.  
 TOTAL = 2,401.07 SQ.FT.

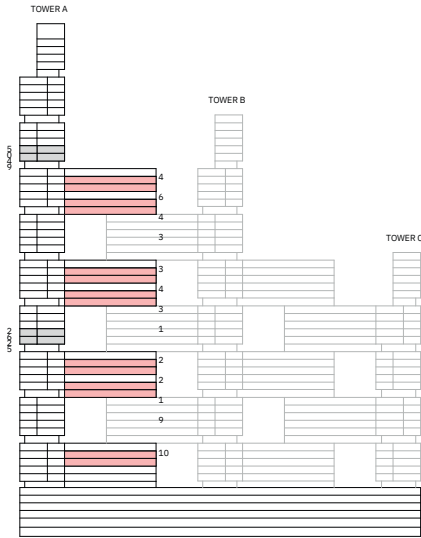

KEY ELEVATION

UNIT

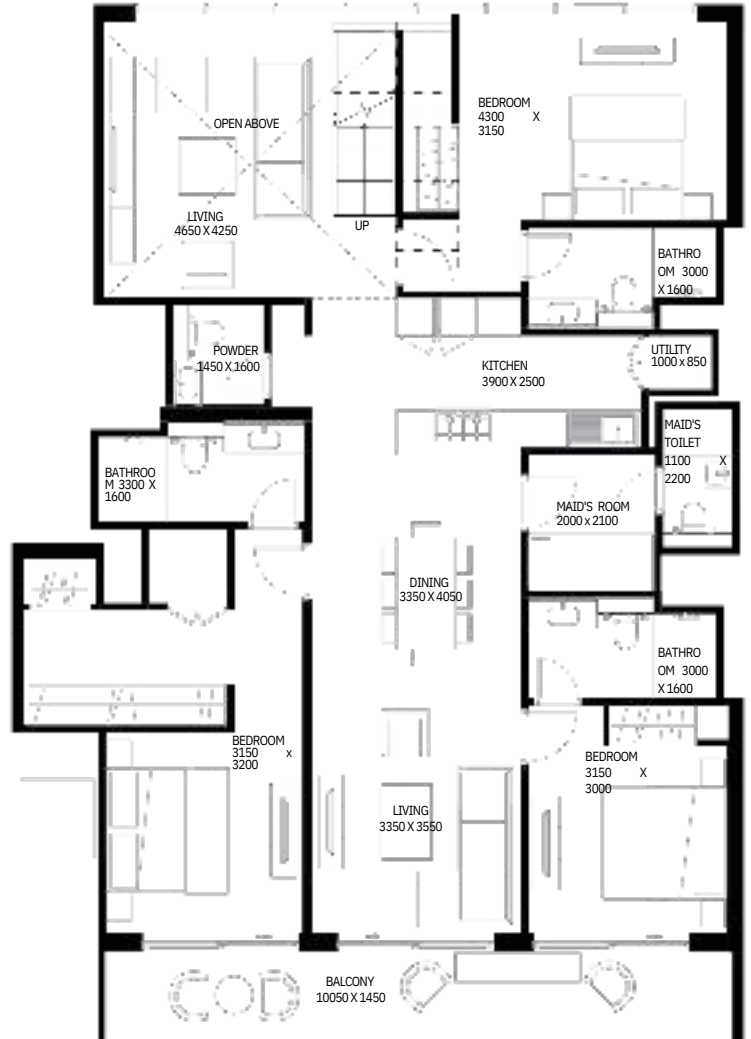
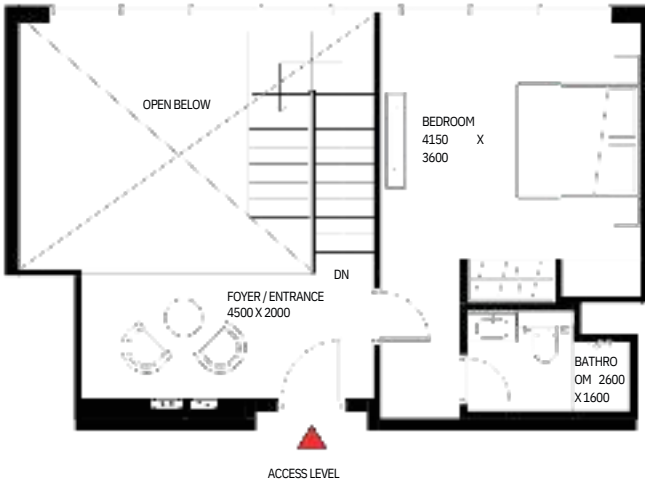
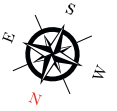

LOWER LEVEL

List of unit numbers with this unit plan:

## VIEWS

Ras Al Khor, Golf Course, Amenities  
 A1017, A1917, A2217

Ras Al Khor, Golf Course  
 A3117, A3417, A4317, A4617

Disclaimer: 1. All dimensions are in metric, measured to wall finishes. 2. All materials, dimensions & drawings are approximate. 3. Information is subject to change without notice, at developer's absolute discretion. 4. Actual area may vary from the stated area. 5. Drawing are not to scale. 6. All images used are for illustrative purpose only and do not represent the actual size, features, specifications, fittings and furnishings. 7. The developer reserves the right to make revisions/ alterations, at its absolute discretion, without any liability whatsoever.

# 4 BEDROOM DUPLEX APARTMENT

TYPE A1 (with maid room and powder room + balcony)

TOTAL SALEABLE AREA  
 SUITE = 2,227.74 SQ.FT.  
 BALCONY = 173.33 SQ.FT.  
 TOTAL = 2,401.07 SQ.FT.

■ UNIT

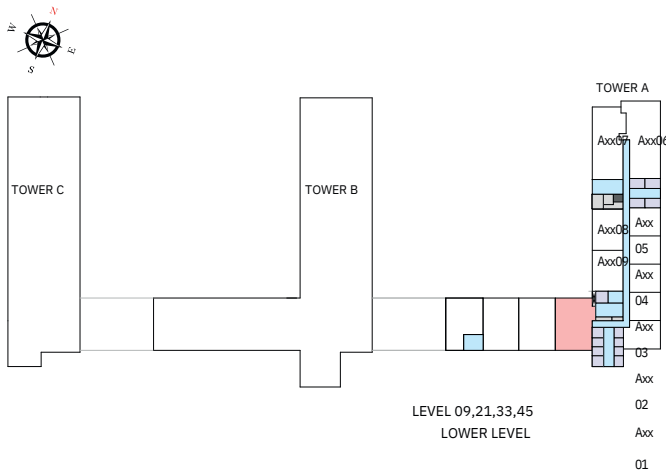
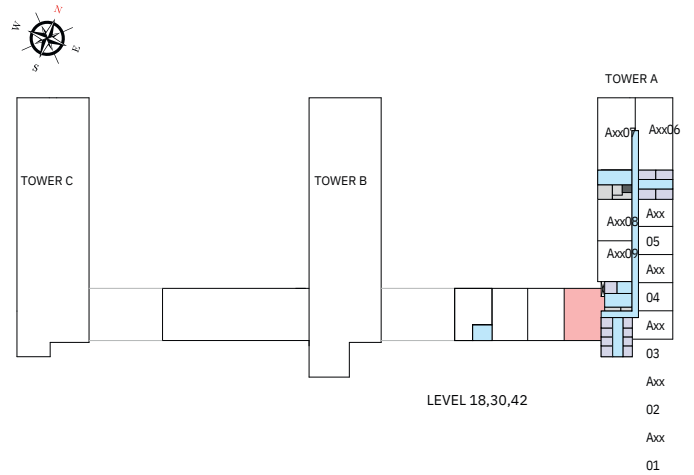
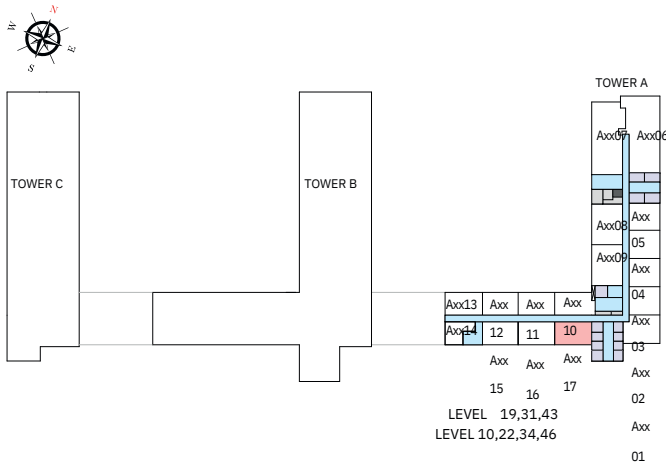

List of unit numbers with this unit plan:

## VIEWS

Ras Al Khor, Golf Course, Amenities  
 A1017, A1917, A2217

Ras Al Khor, Golf Course  
 A3117, A3417, A4317, A4617

Disclaimer: 1. All dimensions are in metric, measured to wall finishes. 2. All materials, dimensions & drawings are approximate. 3. Information is subject to change without notice, at developer's absolute discretion. 4. Actual area may vary from the stated area. 5. Drawing are not to scale. 6. All images used are for illustrative purpose only and do not represent the actual size, features, specifications, fittings and furnishings. 7. The developer reserves the right to make revisions/ alterations, at its absolute discretion, without any liability whatsoever.

# TOWER B

UNIT PLANS

# 1 BEDROOM APARTMENT

TYPE D (with balcony)

TOTAL SALEABLE AREA  
 SUITE = 490.21 SQ.FT.  
 BALCONY = 49.51 SQ.FT.  
 TOTAL = 539.72 SQ.FT.

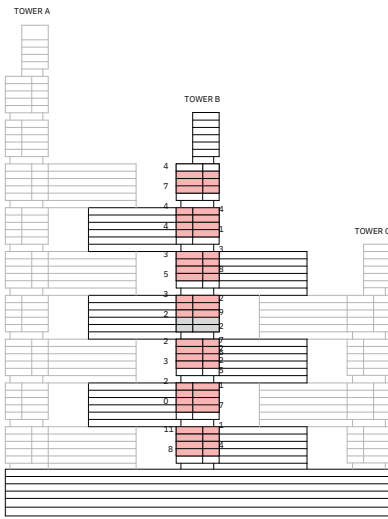

KEY ELEVATION

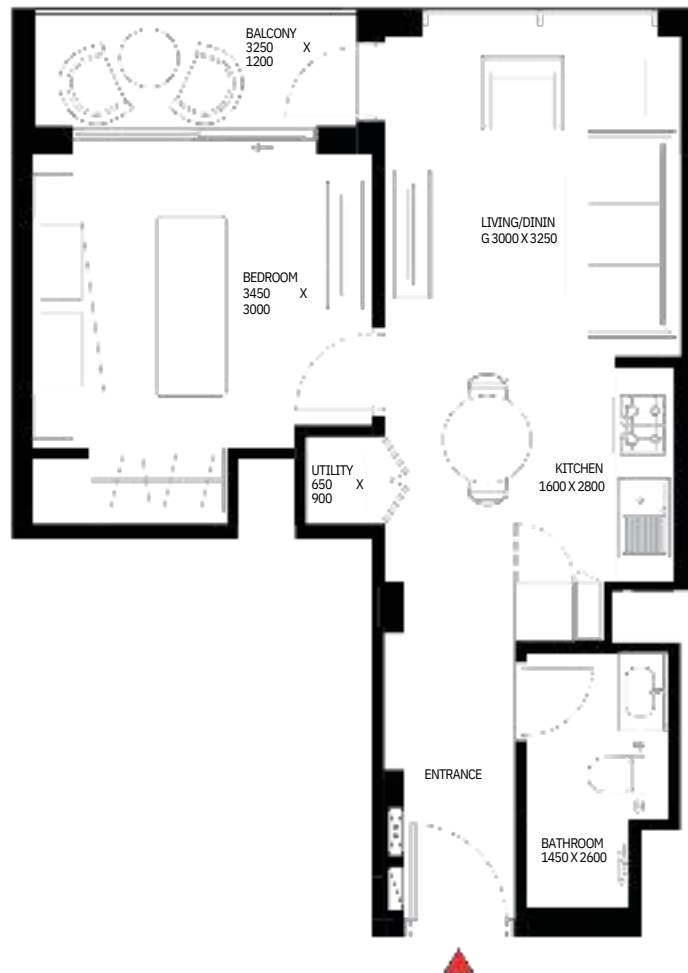

List of unit numbers with this unit plan:

## VIEWS

Ras Al Khor, Golf Course, Amenities  
 B806, B906, B1006, B1106, B1406, B1506, B1606, B1706, B2006, B2106, B2206, B2306

Ras Al Khor, Golf Course, Water Body  
 B2706, B2806, B2906, B3206, B3306, B3406, B3506

Ras Al Khor, Golf Course  
 B3806, B3906, B4006, B4106, B4406, B4506, B4606

Disclaimer: 1. All dimensions are in metric, measured to wall finishes. 2. All materials, dimensions & drawings are approximate. 3. Information is subject to change without notice, at developer's absolute discretion. 4. Actual area may vary from the stated area. 5. Drawing are not to scale. 6. All images used are for illustrative purpose only and do not represent the actual size, features, specifications, fittings and furnishings. 7. The developer reserves the right to make revisions/ alterations, at its absolute discretion, without any liability whatsoever.

# 1 BEDROOM APARTMENT

TYPE D (with balcony)

TOTAL SALEABLE AREA

SUITE = 490.21 SQ.FT.

BALCONY = 49.51 SQ.FT.

TOTAL = 539.72 SQ.FT.

 UNIT

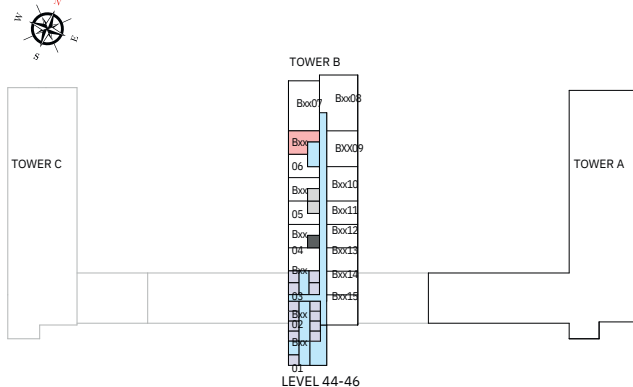
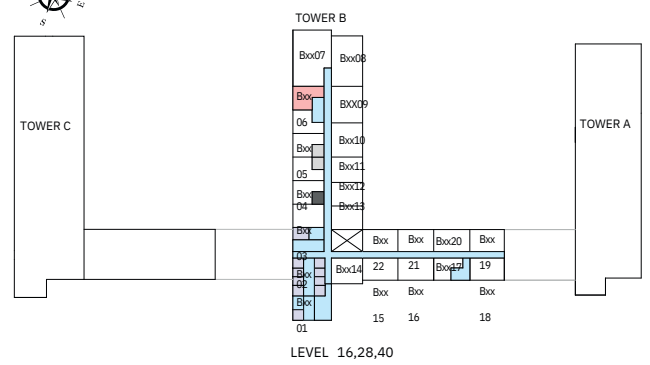
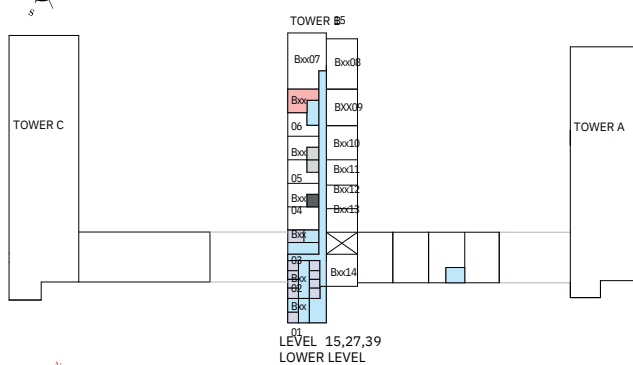
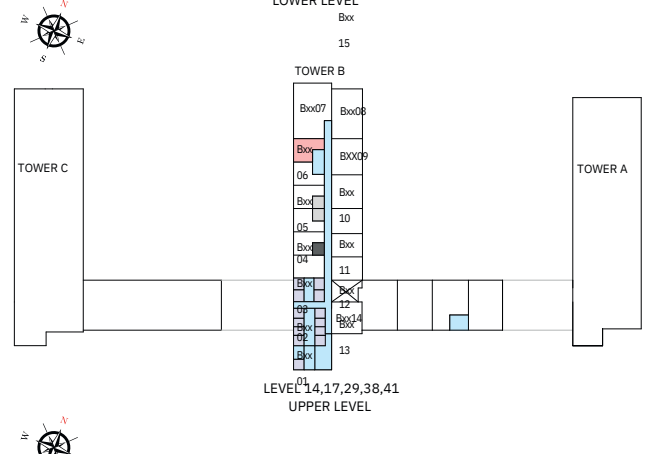
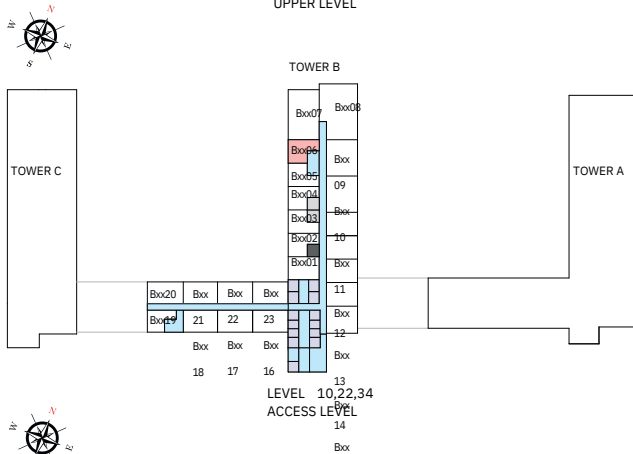
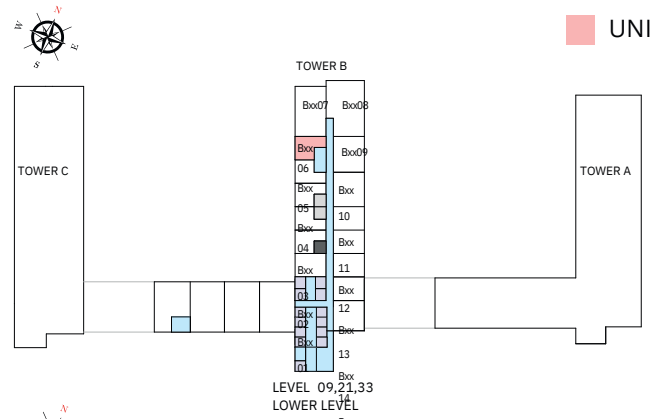
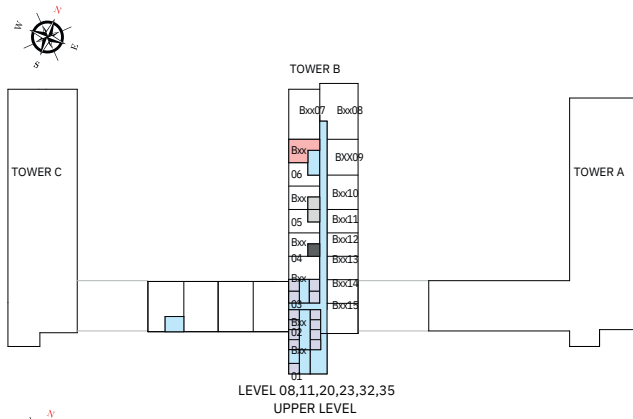

List of unit numbers with this unit plan:

## VIEWS

Ras Al Khor, Golf Course, Amenities

B806, B906, B1006, B1106, B1406, B1506, B1606, B1706, B2006, B2106, B2206, B2306

Ras Al Khor, Golf Course, Water Body

B2706, B2806, B2906, B3206, B3306, B3406, B3506

Ras Al Khor, Golf Course

B3806, B3906, B4006, B4106, B4406, B4506, B4606

Disclaimer: 1. All dimensions are in metric, measured to wall finishes. 2. All materials, dimensions & drawings are approximate. 3. Information is subject to change without notice, at developer's absolute discretion. 4. Actual area may vary from the stated area. 5. Drawing are not to scale. 6. All images used are for illustrative purpose only and do not represent the actual size, features, specifications, fittings and furnishings. 7. The developer reserves the right to make revisions/ alterations, at its absolute discretion, without any liability whatsoever.

# 1 BEDROOM APARTMENT

TYPE D (with balcony) VARIANT 1

TOTAL SALEABLE AREA  
 SUITE = 491.58 SQ.FT.  
 BALCONY = 46.05 SQ.FT.  
 TOTAL = 537.63 SQ.FT.

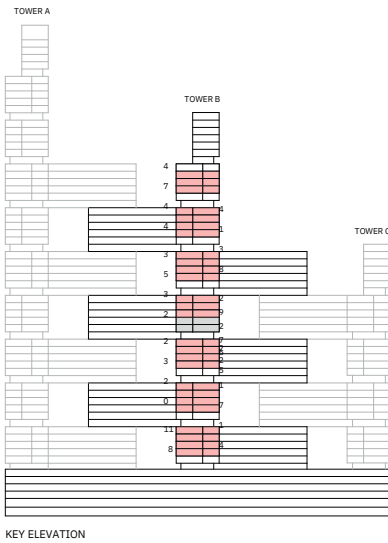

List of unit numbers with this unit plan:

## VIEWS

Ras Al Khor, Golf Course, Amenities  
 B805, B905, B1005, B1105, B1405, B1505, B1605, B1705, B2005, B2105, B2205, B2305

Ras Al Khor, Golf Course  
 B3805, B3905, B4005, B4105, B4405, B4505, B4605

Ras Al Khor, Golf Course, Water Body  
 B2705, B2805, B2905, B3205, B3305, B3405, B3505

Disclaimer: 1. All dimensions are in metric, measured to wall finishes. 2. All materials, dimensions & drawings are approximate. 3. Information is subject to change without notice, at developer's absolute discretion. 4. Actual area may vary from the stated area. 5. Drawing are not to scale. 6. All images used are for illustrative purpose only and do not represent the actual size, features, specifications, fittings and furnishings. 7. The developer reserves the right to make revisions/ alterations, at its absolute discretion, without any liability whatsoever.

# 1 BEDROOM APARTMENT

TYPE D (with balcony) VARIANT 1

TOTAL SALEABLE AREA

SUITE = 491.58 SQ.FT.

BALCONY = 46.05 SQ.FT.

TOTAL = 537.63 SQ.FT.

 UNIT

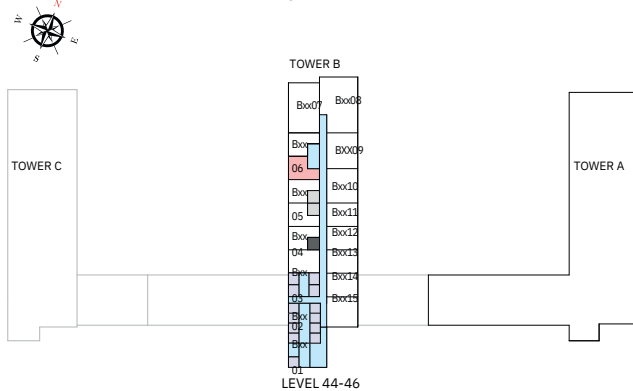
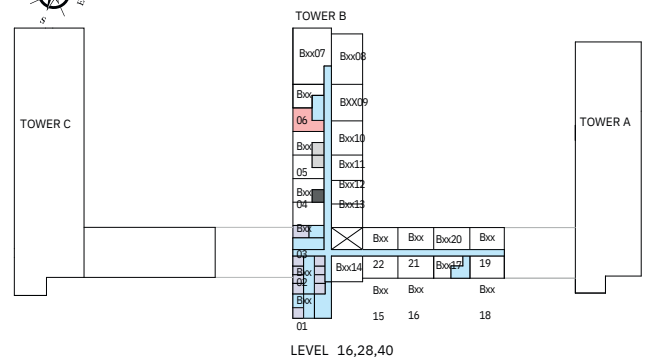
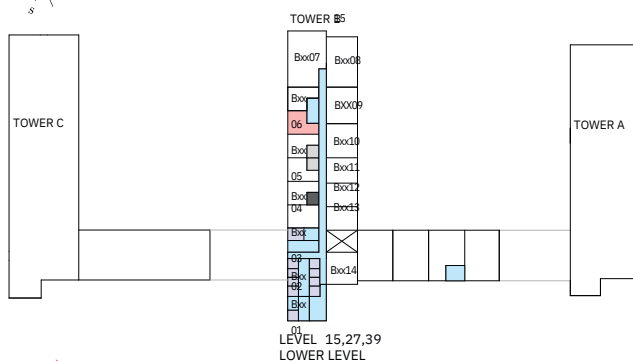
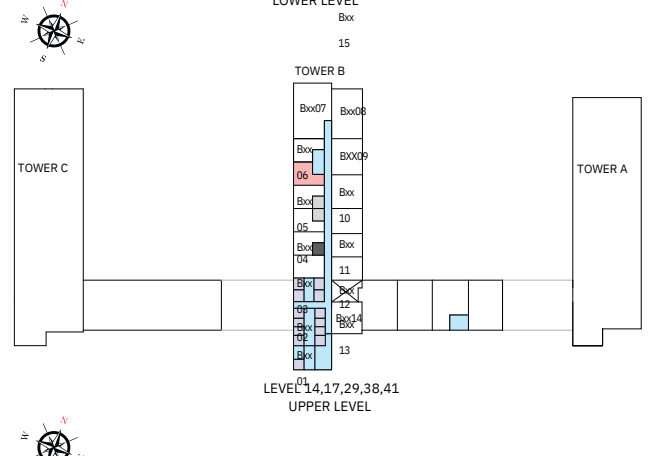
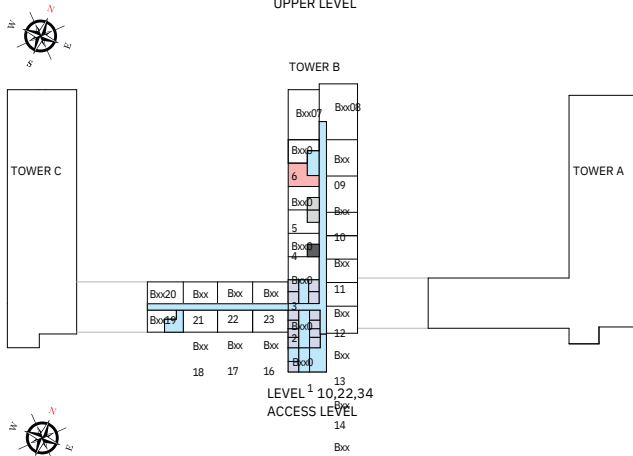
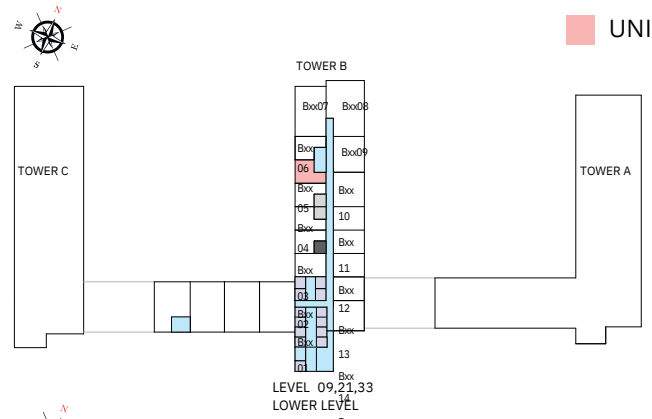
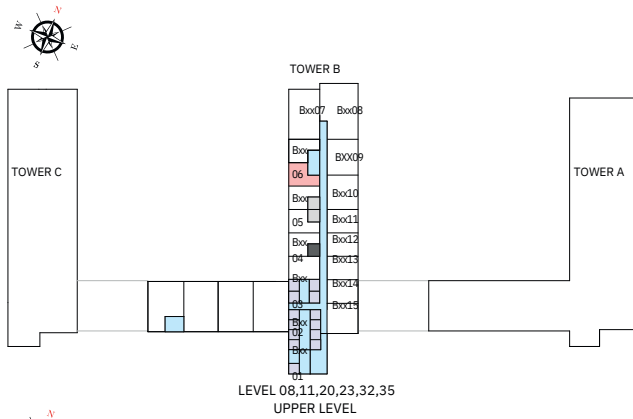

List of unit numbers with this unit plan:

## VIEWS

Ras Al Khor, Golf Course, Amenities  
B805, B905, B1005, B1105, B1405, B1505, B1605, B1705, B2005, B2105, B2205, B2305

Ras Al Khor, Golf Course, Water Body  
B2705, B2805, B2905, B3205, B3305, B3405, B3505

Ras Al Khor, Golf Course  
B3805, B3905, B4005, B4105, B4405, B4505, B4605

Disclaimer: 1. All dimensions are in metric, measured to wall finishes. 2. All materials, dimensions & drawings are approximate. 3. Information is subject to change without notice, at developer's absolute discretion. 4. Actual area may vary from the stated area. 5. Drawing are not to scale. 6. All images used are for illustrative purpose only and do not represent the actual size, features, specifications, fittings and furnishings. 7. The developer reserves the right to make revisions/ alterations, at its absolute discretion, without any liability whatsoever.



# 1 BEDROOM APARTMENT

TYPE E (with balcony)

TOTAL SALEABLE AREA  
 SUITE = 503.94 SQ.FT.  
 BALCONY = 45.08 SQ.FT.  
 TOTAL = 549.02 SQ.FT.

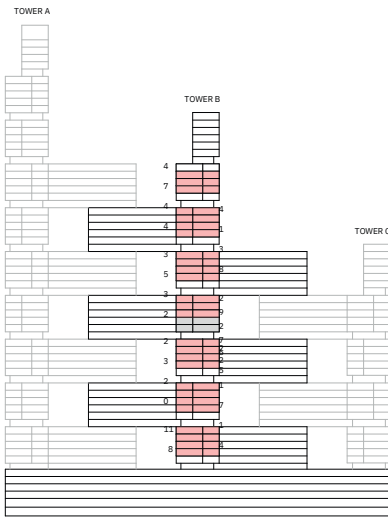

KEY ELEVATION



List of unit numbers with this unit plan:

## VIEWS

Ras Al Khor, Amenities  
 B803, B903, B1003

Ras Al Khor, Golf Course, Water Body  
 B2703, B2803, B2903, B3203, B3303, B3403, B3503,

Ras Al Khor, Golf Course, Amenities  
 B1103, B1403, B1503, B1603, B1703, B2003, B2103, B2203, B2303

Ras Al Khor, Golf Course  
 B3803, B3903, B4003, B4103, B4403, B4503, B4603

Disclaimer: 1. All dimensions are in metric, measured to wall finishes. 2. All materials, dimensions & drawings are approximate. 3. Information is subject to change without notice, at developer's absolute discretion. 4. Actual area may vary from the stated area. 5. Drawing are not to scale. 6. All images used are for illustrative purpose only and do not represent the actual size, features, specifications, fittings and furnishings. 7. The developer reserves the right to make revisions/ alterations, at its absolute discretion, without any liability whatsoever.

# 1 BEDROOM APARTMENT

TYPE E (with balcony)

TOTAL SALEABLE AREA

SUITE = 503.94 SQ.FT.

BALCONY = 45.08 SQ.FT.

TOTAL = 549.02 SQ.FT.

■ UNIT

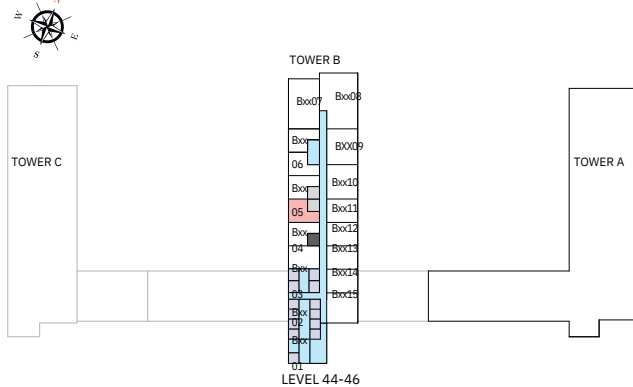
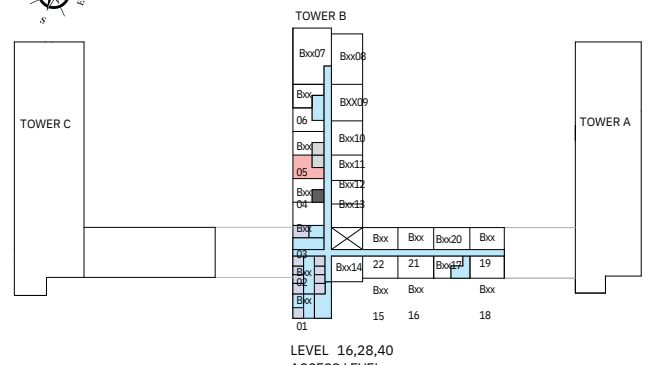
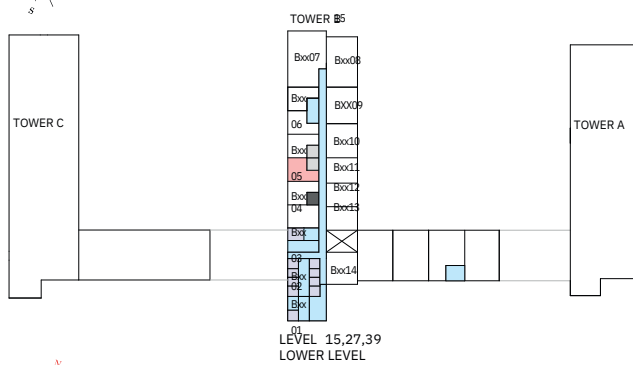
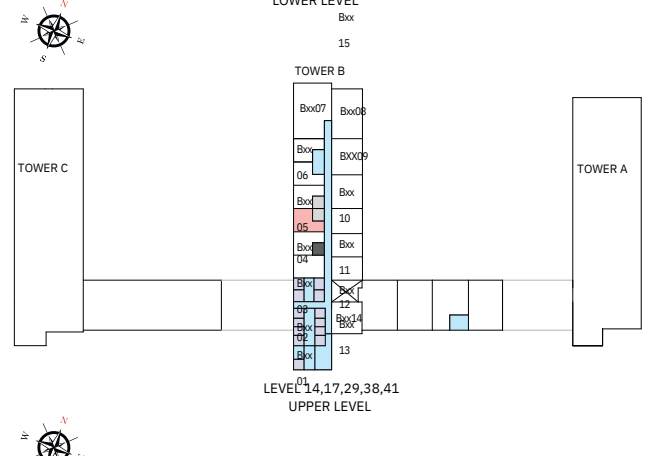
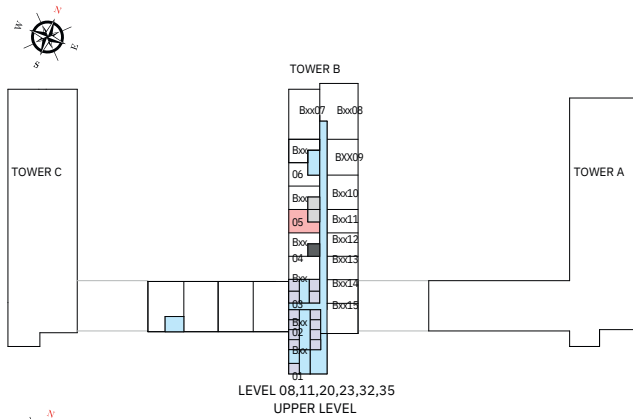

List of unit numbers with this unit plan:

## VIEWS

Ras Al Khor, Amenities  
B803, B903, B1003

Ras Al Khor, Golf Course, Amenities  
B1103, B1403, B1503, B1603, B1703, B2003, B2103, B2203, B2303

Ras Al Khor, Golf Course, Water Body  
B2703, B2803, B2903, B3203, B3303, B3403, B3503,

Ras Al Khor, Golf Course  
B3803, B3903, B4003, B4103, B4403, B4503, B4603

Disclaimer: 1. All dimensions are in metric, measured to wall finishes. 2. All materials, dimensions & drawings are approximate. 3. Information is subject to change without notice, at developer's absolute discretion. 4. Actual area may vary from the stated area. 5. Drawing are not to scale. 6. All images used are for illustrative purpose only and do not represent the actual size, features, specifications, fittings and furnishings. 7. The developer reserves the right to make revisions/ alterations, at its absolute discretion, without any liability whatsoever.

# 1 BEDROOM APARTMENT

TYPE E (with balcony) VARIANT 1

TOTAL SALEABLE AREA  
 SUITE = 503.94 SQ.FT.  
 BALCONY = 45.08 SQ.FT.  
 TOTAL = 549.02 SQ.FT.

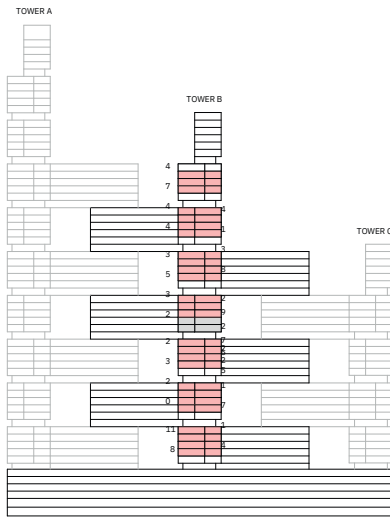

KEY ELEVATION



List of unit numbers with this unit plan:

## VIEWS

Ras Al Khor, Amenities  
 B802, B902, B1002

Ras Al Khor, Golf Course, Amenities  
 B1102, B1402, B1502, B1602, B1702, B2002, B2102, B2202, B2302

Ras Al Khor, Golf Course  
 B2702, B2802, B2902, B3202, B3302, B3402, B3502, B3802, B3902, B4002,  
 B4102, B4402, B4502, B4602

Disclaimer: 1. All dimensions are in metric, measured to wall finishes. 2. All materials, dimensions & drawings are approximate. 3. Information is subject to change without notice, at developer's absolute discretion. 4. Actual area may vary from the stated area. 5. Drawing are not to scale. 6. All images used are for illustrative purpose only and do not represent the actual size, features, specifications, fittings and furnishings. 7. The developer reserves the right to make revisions/ alterations, at its absolute discretion, without any liability whatsoever.

# 1 BEDROOM APARTMENT

TYPE E (with balcony) VARIANT 1

TOTAL SALEABLE AREA

SUITE = 503.94 SQ.FT.

BALCONY = 45.08 SQ.FT.

TOTAL = 549.02 SQ.FT.

 UNIT

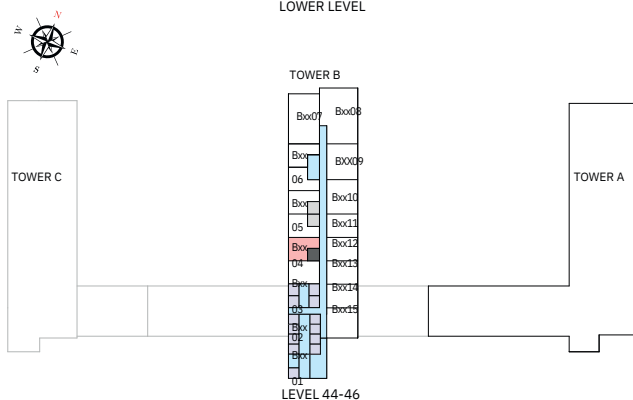
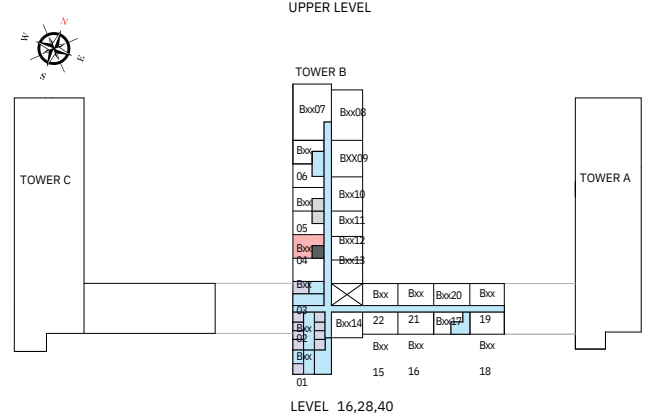
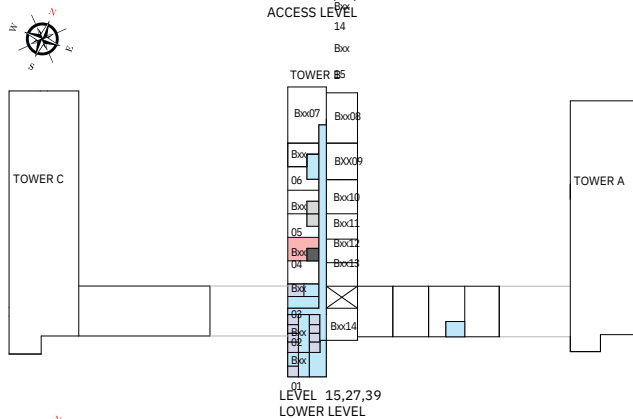
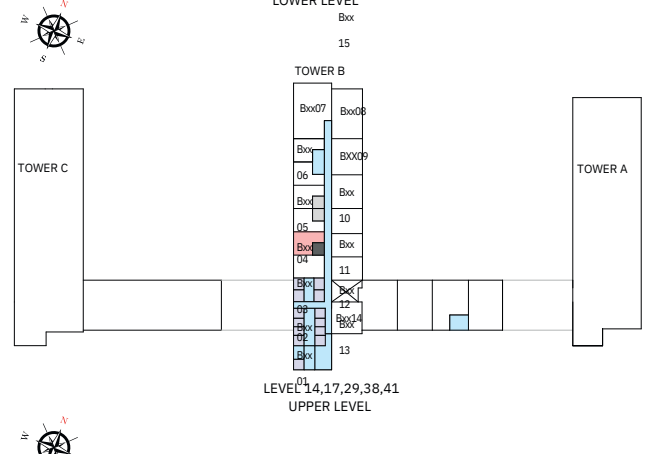
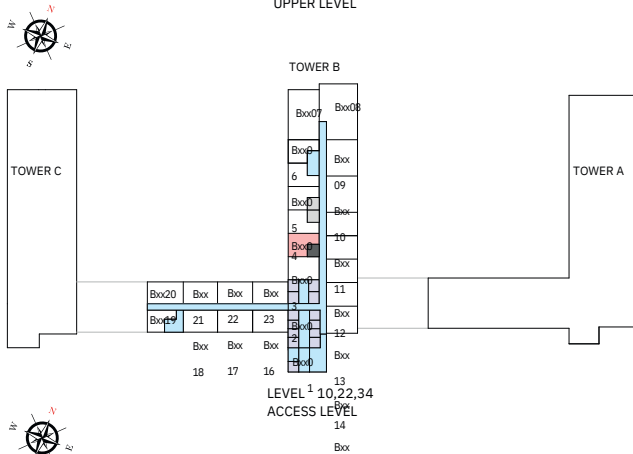
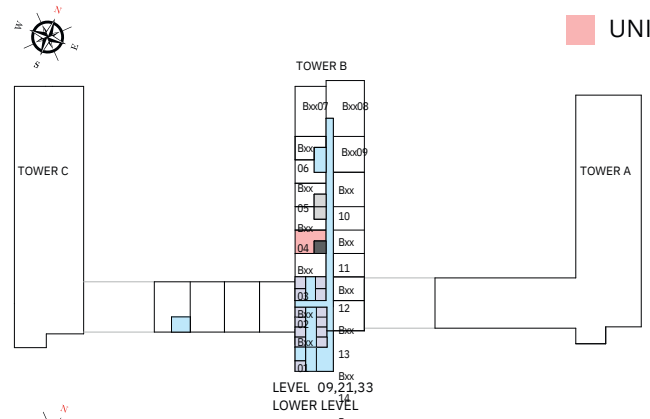
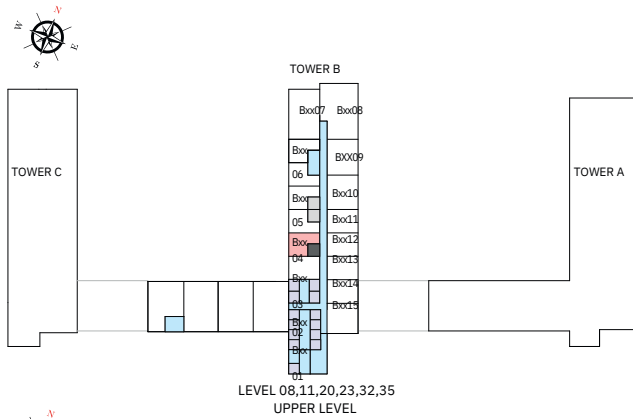

List of unit numbers with this unit plan:

## VIEWS

Ras Al Khor, Amenities  
B802, B902, B1002

Ras Al Khor, Golf Course, Amenities  
B1102, B1402, B1502, B1602, B1702, B2002, B2102, B2202, B2302

Ras Al Khor, Golf Course  
B2702, B2802, B2902, B3202, B3302, B3402, B3502, B3802, B3902, B4002, B4102, B4402, B4502, B4602

Disclaimer: 1. All dimensions are in metric, measured to wall finishes. 2. All materials, dimensions & drawings are approximate. 3. Information is subject to change without notice, at developer's absolute discretion. 4. Actual area may vary from the stated area. 5. Drawing are not to scale. 6. All images used are for illustrative purpose only and do not represent the actual size, features, specifications, fittings and furnishings. 7. The developer reserves the right to make revisions/ alterations, at its absolute discretion, without any liability whatsoever.

# 1 BEDROOM APARTMENT

TYPE F (with balcony)

TOTAL SALEABLE AREA  
 SUITE = 508.06 SQ.FT.  
 BALCONY = 45.35 SQ.FT.  
 TOTAL = 553.41 SQ.FT.

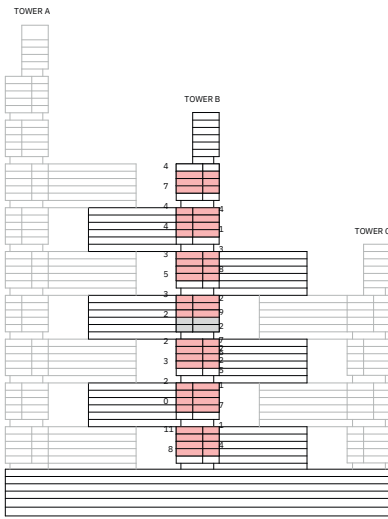

KEY ELEVATION



List of unit numbers with this unit plan:

## VIEWS

Ras Al Khor, Amenities  
 B804, B904, B1004

Ras Al Khor, Golf Course, Water Body  
 B2704, B2804, B2904, B3204, B3304, B3404, B3504

Ras Al Khor, Golf Course, Amenities  
 B1104, B1404, B1504, B1604, B1704, B2004, B2104, B2204, B2304

Ras Al Khor, Golf Course  
 B3804, B3904, B4004, B4104, B4404, B4504, B4604

Disclaimer: 1. All dimensions are in metric, measured to wall finishes. 2. All materials, dimensions & drawings are approximate. 3. Information is subject to change without notice, at developer's absolute discretion. 4. Actual area may vary from the stated area. 5. Drawing are not to scale. 6. All images used are for illustrative purpose only and do not represent the actual size, features, specifications, fittings and furnishings. 7. The developer reserves the right to make revisions/ alterations, at its absolute discretion, without any liability whatsoever.

# 1 BEDROOM APARTMENT

TYPE F (with balcony)

TOTAL SALEABLE AREA

SUITE = 508.06 SQ.FT.

BALCONY = 45.35 SQ.FT.

TOTAL = 553.41 SQ.FT.

■ UNIT

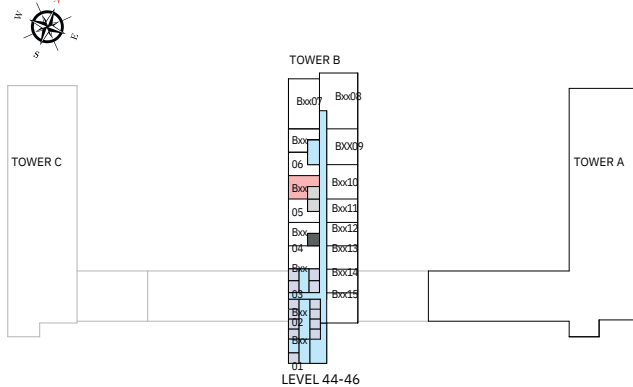
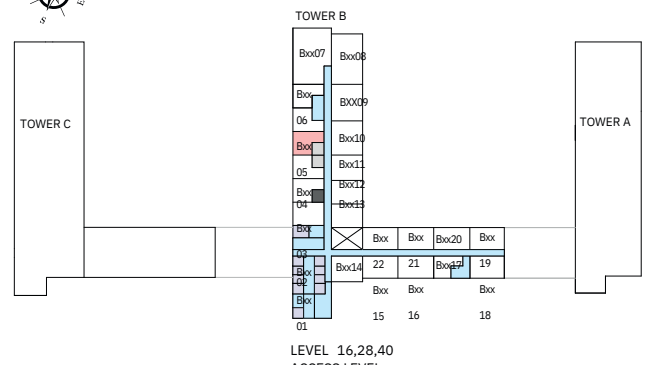
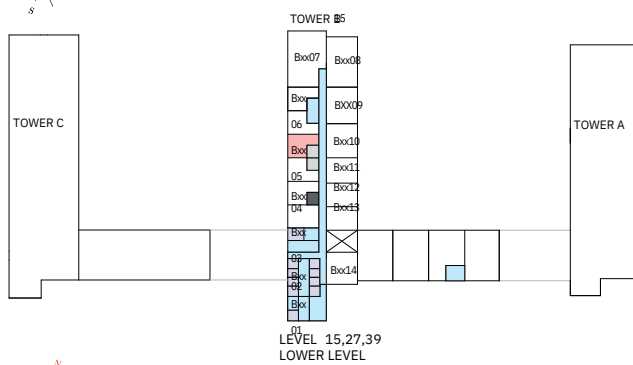
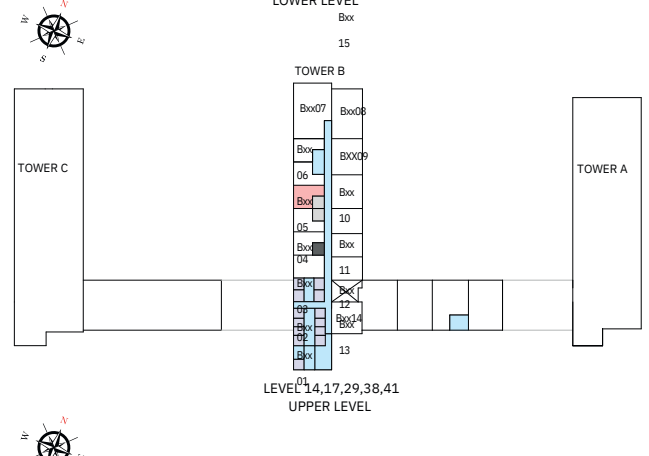
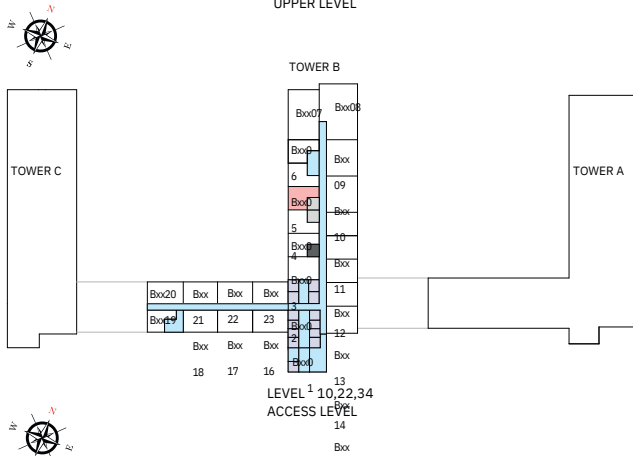
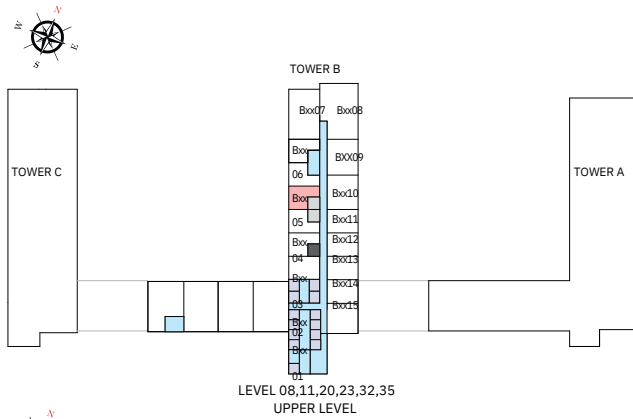

List of unit numbers with this unit plan:

## VIEWS

Ras Al Khor, Amenities  
B804, B904, B1004

Ras Al Khor, Golf Course, Water Body  
B2704, B2804, B2904, B3204, B3304, B3404, B3504

Ras Al Khor, Golf Course, Amenities  
B1104, B1404, B1504, B1604, B1704, B2004, B2104, B2204, B2304

Ras Al Khor, Golf Course  
B3804, B3904, B4004, B4104, B4404, B4504, B4604

Disclaimer: 1. All dimensions are in metric, measured to wall finishes. 2. All materials, dimensions & drawings are approximate. 3. Information is subject to change without notice, at developer's absolute discretion. 4. Actual area may vary from the stated area. 5. Drawing are not to scale. 6. All images used are for illustrative purpose only and do not represent the actual size, features, specifications, fittings and furnishings. 7. The developer reserves the right to make revisions/ alterations, at its absolute discretion, without any liability whatsoever.

# 1.5 BEDROOM APARTMENT

TYPE A (with study room + balcony)

TOTAL SALEABLE AREA  
 SUITE = 630.99 SQ.FT.  
 BALCONY = 45.99 SQ.FT.  
 TOTAL = 676.98 SQ.FT.

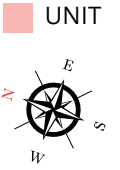
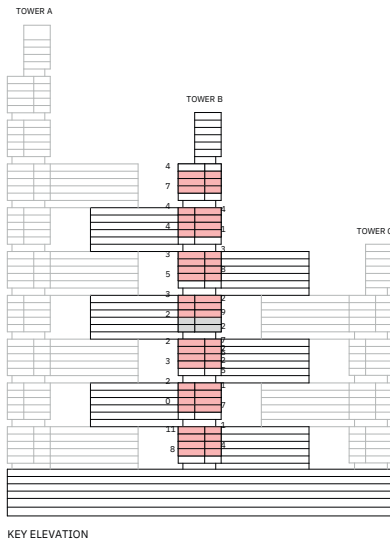

List of unit numbers with this unit plan:

## VIEWS

Amenities, Creek  
 B813, B913, B1013

Golf Course, Amenities, Creek  
 B1113, B1413, B1513, B1613, B1713, B2013, B2113, B2213, B2313

Golf Course, Creek  
 B2713, B2813, B2913, B3213, B3313, B3413, B3513, B3813, B3913, B4013, B4113, B4413, B4513, B4613

Disclaimer: 1. All dimensions are in metric, measured to wall finishes. 2. All materials, dimensions & drawings are approximate. 3. Information is subject to change without notice, at developer's absolute discretion. 4. Actual area may vary from the stated area. 5. Drawing are not to scale. 6. All images used are for illustrative purpose only and do not represent the actual size, features, specifications, fittings and furnishings. 7. The developer reserves the right to make revisions/ alterations, at its absolute discretion, without any liability whatsoever.

# 1.5 BEDROOM APARTMENT

TYPE A (with study room + balcony)

TOTAL SALEABLE AREA

SUITE = 630.99 SQ.FT.

BALCONY = 45.99 SQ.FT.

TOTAL = 676.98 SQ.FT.

■ UNIT

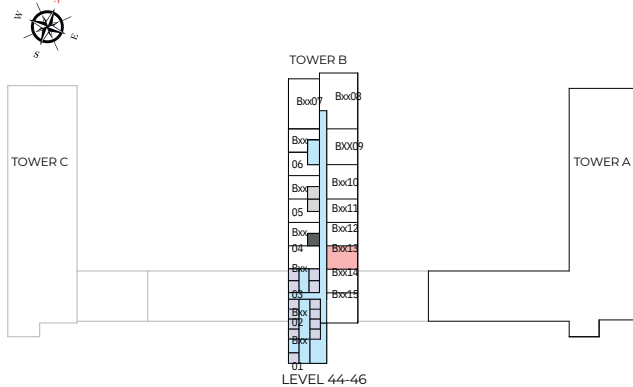
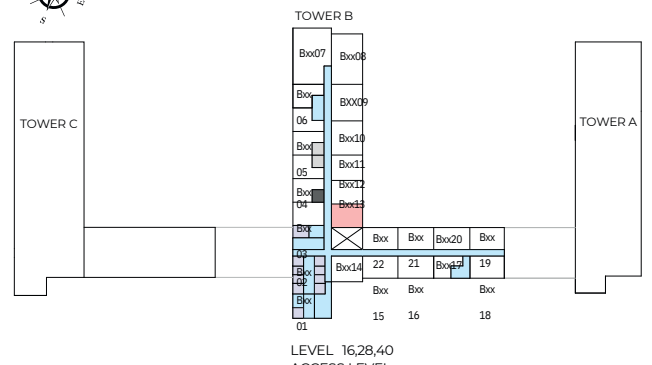
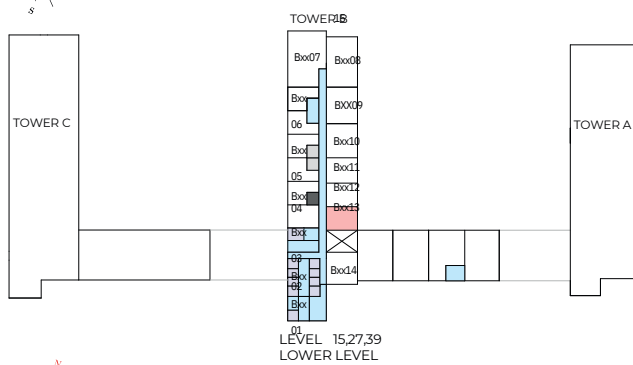
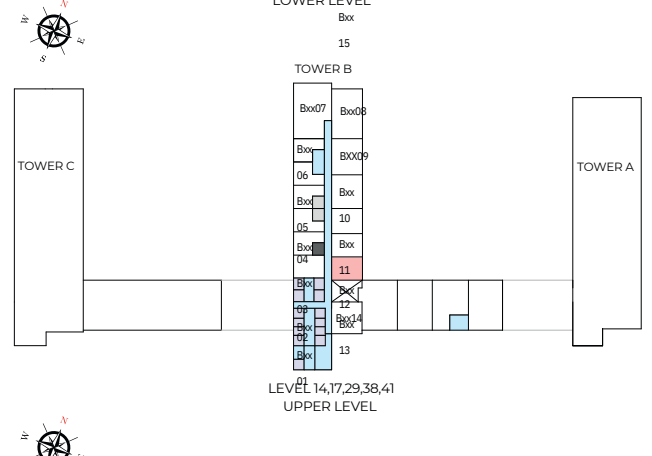
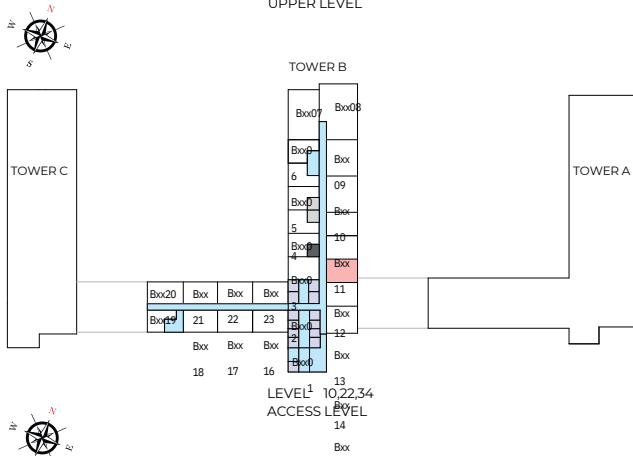
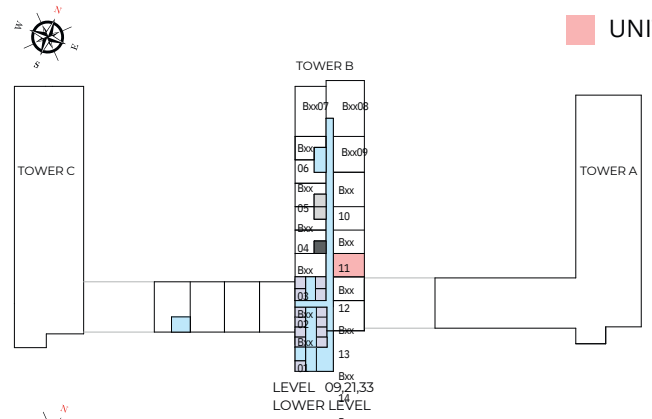
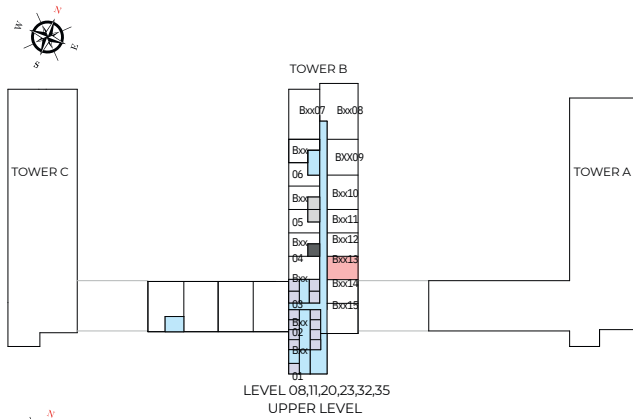

List of unit numbers with this unit plan:

## VIEWS

Amenities, Creek  
B813, B913, B1013

Golf Course, Amenities, Creek  
B1113, B1413, B1513, B1613, B1713, B2013, B2113, B2213, B2313

Golf Course, Creek  
B2713, B2813, B2913, B3213, B3313, B3413, B3513, B3813, B3913, B4013, B4113, B4413, B4513, B4613

Disclaimer: 1. All dimensions are in metric, measured to wall finishes. 2. All materials, dimensions & drawings are approximate. 3. Information is subject to change without notice, at developer's absolute discretion. 4. Actual area may vary from the stated area. 5. Drawing are not to scale. 6. All images used are for illustrative purpose only and do not represent the actual size, features, specifications, fittings and furnishings. 7. The developer reserves the right to make revisions/ alterations, at its absolute discretion, without any liability whatsoever.



# 1.5 BEDROOM APARTMENT

TYPE A (with study room + balcony) VARIANT 1

TOTAL SALEABLE AREA  
 SUITE = 630.99 SQ.FT.  
 BALCONY = 45.99 SQ.FT.  
 TOTAL = 676.98 SQ.FT.

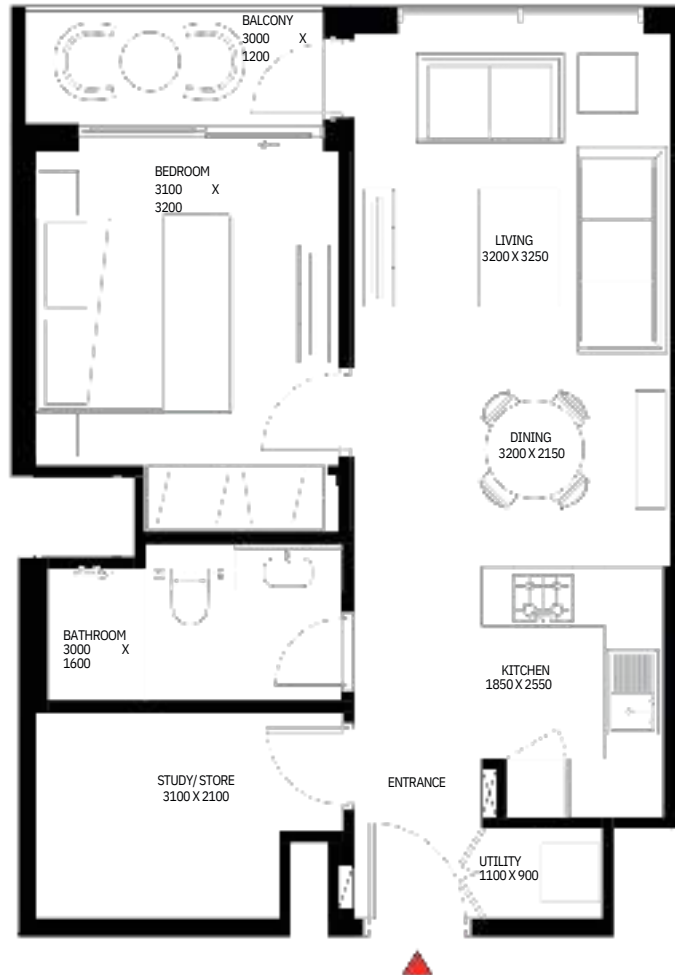
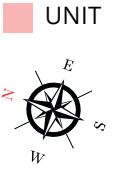
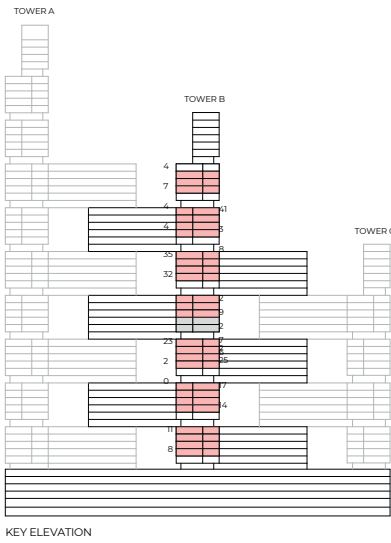

List of unit numbers with this unit plan:

## VIEWS

Amenities, Creek  
 B812, B912, B1012

Golf Course, Amenities, Creek  
 B1112, B1412, B1512, B1612, B1712, B2012, B2112, B2212, B2312

Golf Course, Creek  
 B2712, B2812, B2912, B3212, B3312, B3412, B3512, B3812, B3912, B4012, B4112, B4412, B4512, B4612

Disclaimer: 1. All dimensions are in metric, measured to wall finishes. 2. All materials, dimensions & drawings are approximate. 3. Information is subject to change without notice, at developer's absolute discretion. 4. Actual area may vary from the stated area. 5. Drawing are not to scale. 6. All images used are for illustrative purpose only and do not represent the actual size, features, specifications, fittings and furnishings. 7. The developer reserves the right to make revisions/ alterations, at its absolute discretion, without any liability whatsoever.

# 1.5 BEDROOM APARTMENT

TYPE A (with study room + balcony) VARIANT 1

TOTAL SALEABLE AREA  
 SUITE = 630.99 SQ.FT.  
 BALCONY = 45.99 SQ.FT.  
 TOTAL = 676.98 SQ.FT.

■ UNIT

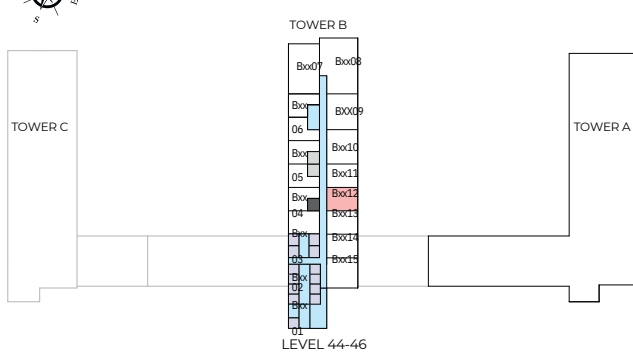
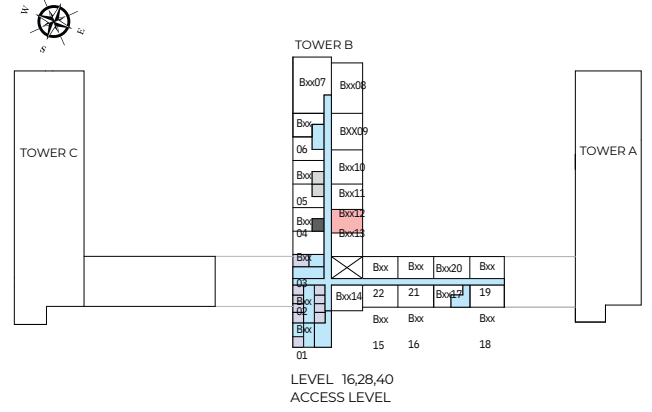
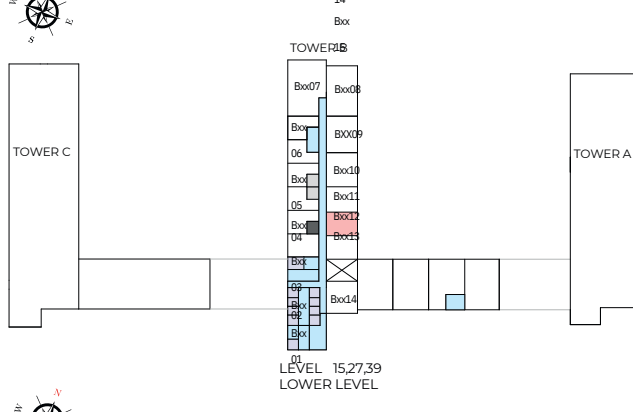
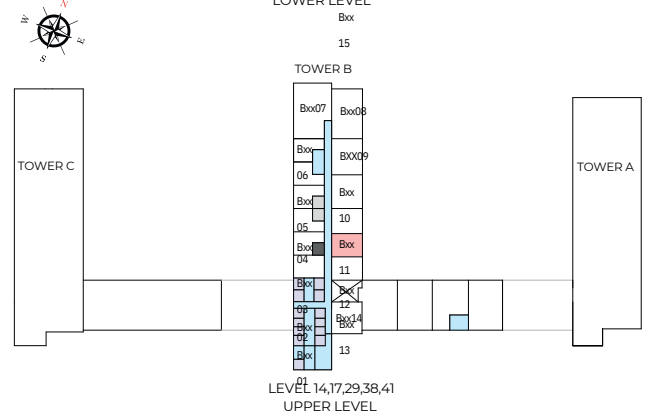
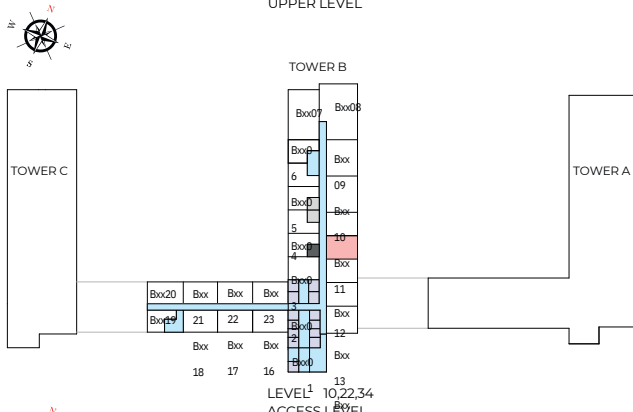
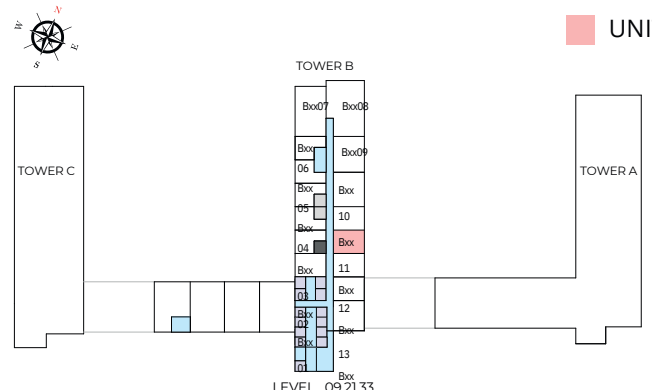
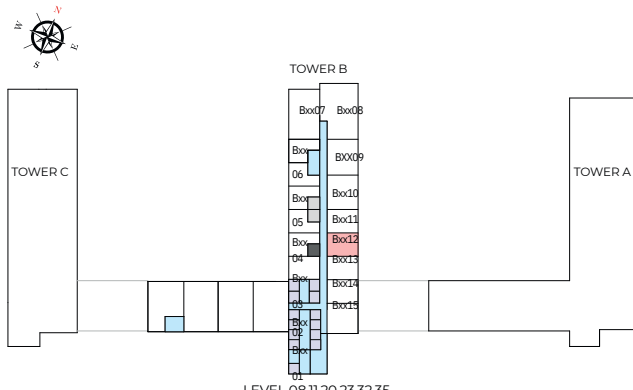

List of unit numbers with this unit plan:

## VIEWS

Amenities, Creek  
 B812, B912, B1012

Golf Course, Amenities, Creek  
 B1112, B1412, B1512, B1612, B1712, B2012, B2112, B2212, B2312

Golf Course, Creek  
 B2712, B2812, B2912, B3212, B3312, B3412, B3512, B3812, B3912, B4012, B4112, B4412, B4512, B4612

Disclaimer: 1. All dimensions are in metric, measured to wall finishes. 2. All materials, dimensions & drawings are approximate. 3. Information is subject to change without notice, at developer's absolute discretion. 4. Actual area may vary from the stated area. 5. Drawing are not to scale. 6. All images used are for illustrative purpose only and do not represent the actual size, features, specifications, fittings and furnishings. 7. The developer reserves the right to make revisions/ alterations, at its absolute discretion, without any liability whatsoever.

# 1.5 BEDROOM APARTMENT

TYPE A (with study room + balcony) VARIANT 2

TOTAL SALEABLE AREA  
 SUITE = 635.38 SQ.FT.  
 BALCONY = 45.90 SQ.FT.  
 TOTAL = 681.28 SQ.FT.

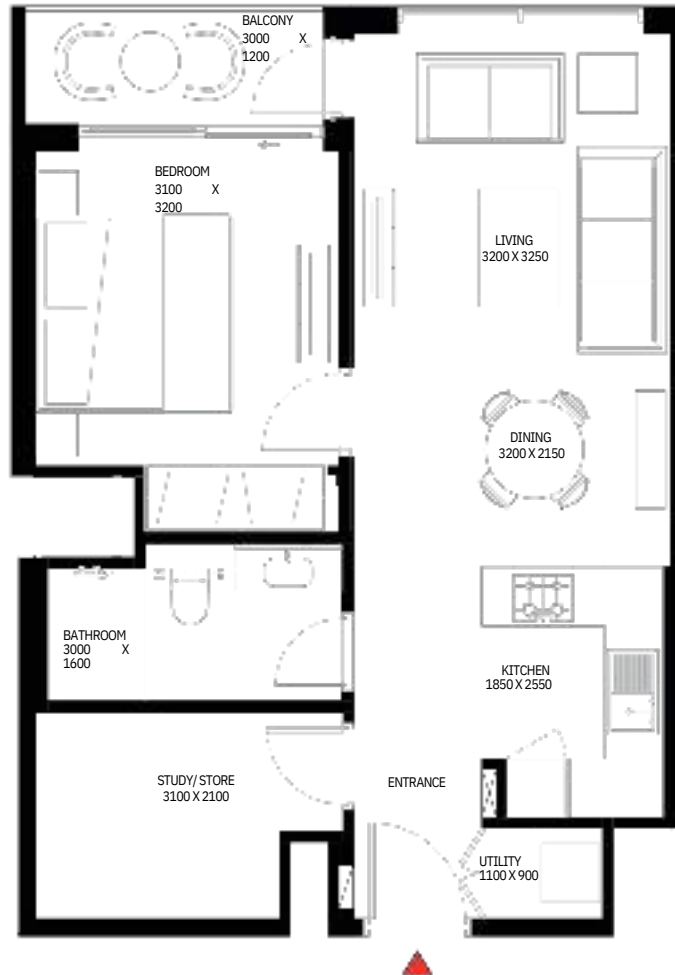
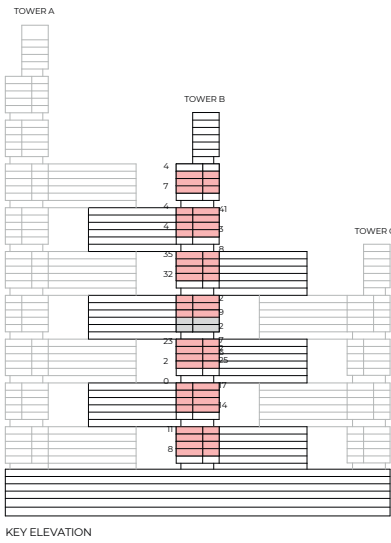

List of unit numbers with this unit plan:

## VIEWS

Ras Al Khor, Amenities  
 B801, B901, B1001

Ras Al Khor, Golf Course, Amenities  
 B1101, B1401, B1501, B1601, B1701, B2001, B2101, B2201, B2301

Ras Al Khor, Golf Course  
 B2701, B2801, B2901, B3201, B3301, B3401, B3501, B3801, B3901, B4001, B4101, B4401, B4501, B4601

Disclaimer: 1. All dimensions are in metric, measured to wall finishes. 2. All materials, dimensions & drawings are approximate. 3. Information is subject to change without notice, at developer's absolute discretion. 4. Actual area may vary from the stated area. 5. Drawing are not to scale. 6. All images used are for illustrative purpose only and do not represent the actual size, features, specifications, fittings and furnishings. 7. The developer reserves the right to make revisions/ alterations, at its absolute discretion, without any liability whatsoever.

# 1.5 BEDROOM APARTMENT

TYPE A (with study room + balcony) VARIANT 2

TOTAL SALEABLE AREA

SUITE = 635.38 SQ.FT.

BALCONY = 45.90 SQ.FT.

TOTAL = 681.28 SQ.FT.

■ UNIT

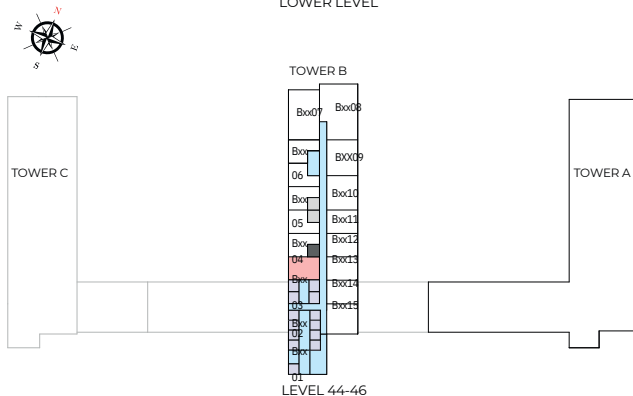
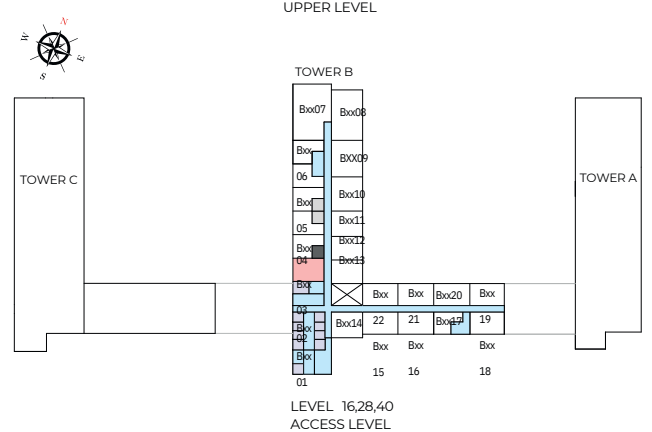
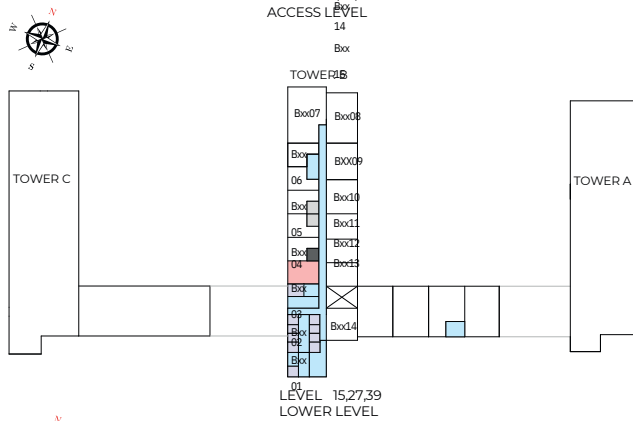
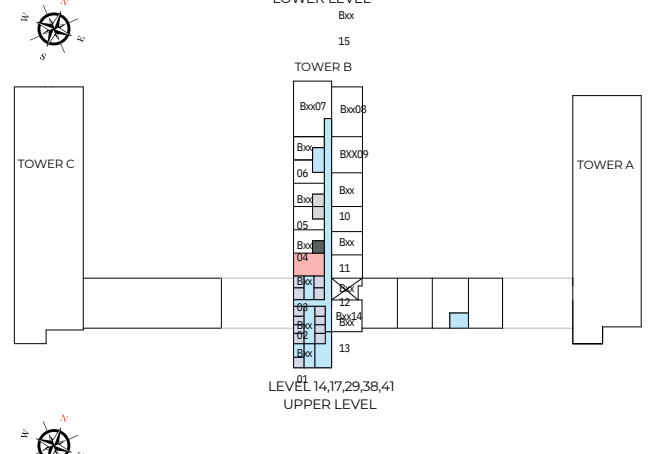
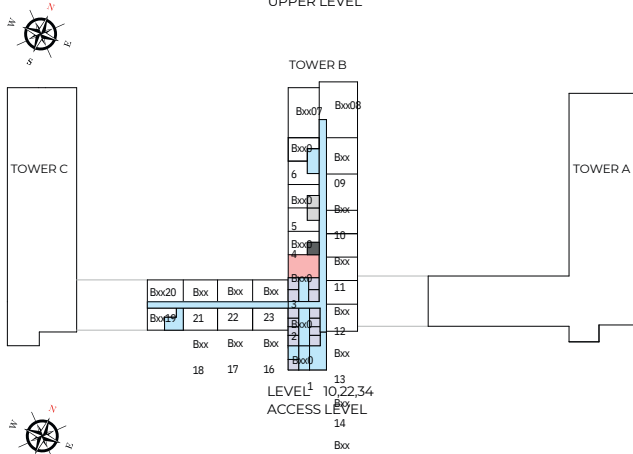
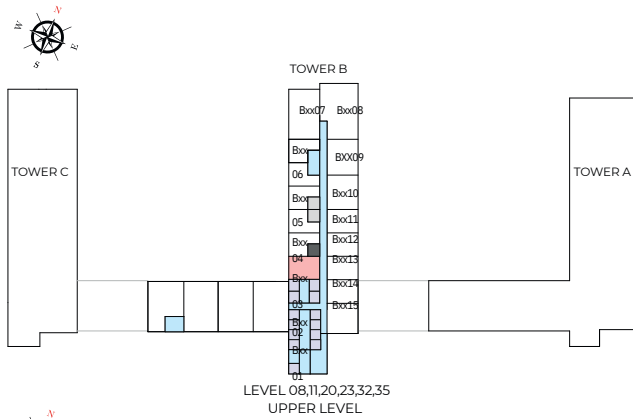

List of unit numbers with this unit plan:

## VIEWS

Ras Al Khor, Amenities

B801, B901, B1001

Ras Al Khor, Golf Course, Amenities

B1101, B1401, B1501, B1601, B1701, B2001, B2101, B2201, B2301

Ras Al Khor, Golf Course

B2701, B2801, B2901, B3201, B3301, B3401, B3501, B3801, B3901, B4001, B4101, B4401, B4501, B4601

Disclaimer: 1. All dimensions are in metric, measured to wall finishes. 2. All materials, dimensions & drawings are approximate. 3. Information is subject to change without notice, at developer's absolute discretion. 4. Actual area may vary from the stated area. 5. Drawing are not to scale. 6. All images used are for illustrative purpose only and do not represent the actual size, features, specifications, fittings and furnishings. 7. The developer reserves the right to make revisions/ alterations, at its absolute discretion, without any liability whatsoever.

# 2 BEDROOM APARTMENT

## TYPE D (with powder room + balcony)

TOTAL SALEABLE AREA  
 SUITE = 968.11 SQ.FT.  
 BALCONY = 48.13 SQ.FT.  
 TOTAL = 1,016.24 SQ.FT.

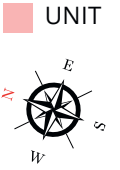
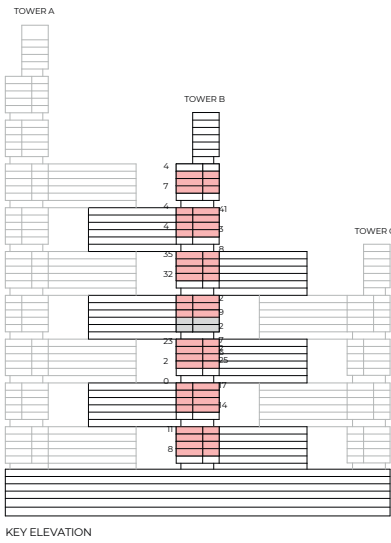

List of unit numbers with this unit plan:

### VIEWS

Golf Course, Amenities, Creek  
 B809, B909, B1009

Golf Course, Amenities, Creek  
 B1109, B1110, B1409, B1410, B1509, B1510, B1609, B1610, B1709, B1710, B2009, B2010, B2109, B2110, B2209, B2210, B2309, B2310

Amenities, Creek  
 B810, B910, B1010

Golf Course, Creek  
 B2709, B2710, B2809, B2810, B2909, B2910, B3209, B3210, B3309, B3310, B3409, B3410, B3509, B3510, B3809, B3810, B3909, B3910, B4009, B4010, B4109, B4110, B4409, B4410, B4509, B4510, B4609, B4610

Disclaimer: 1. All dimensions are in metric, measured to wall finishes. 2. All materials, dimensions & drawings are approximate. 3. Information is subject to change without notice, at developer's absolute discretion. 4. Actual area may vary from the stated area. 5. Drawing are not to scale. 6. All images used are for illustrative purpose only and do not represent the actual size, features, specifications, fittings and furnishings. 7. The developer reserves the right to make revisions/ alterations, at its absolute discretion, without any liability whatsoever.

# 2 BEDROOM APARTMENT

TYPE D (with powder room + balcony)

TOTAL SALEABLE AREA

SUITE = 968.11 SQ.FT.

BALCONY = 48.13 SQ.FT.

TOTAL = 1,016.24 SQ.FT.

■ UNIT

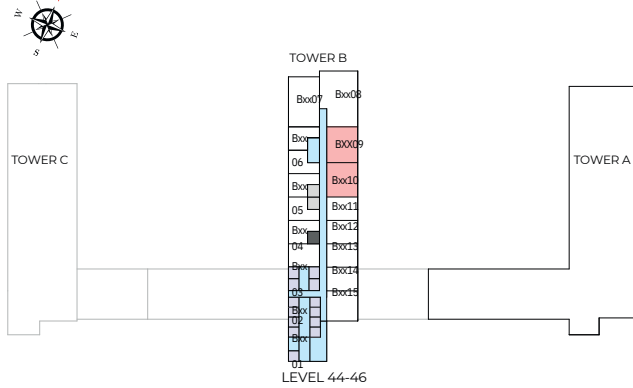
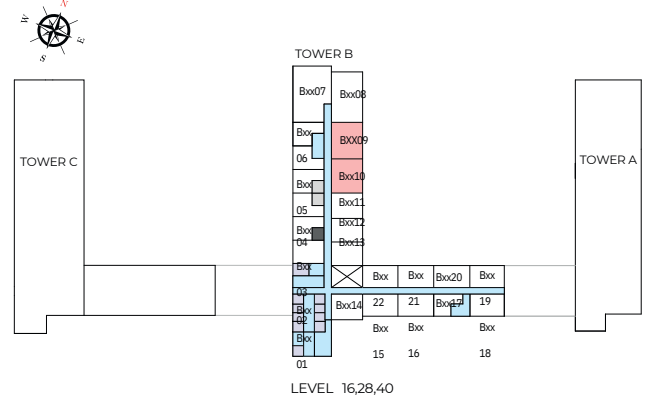
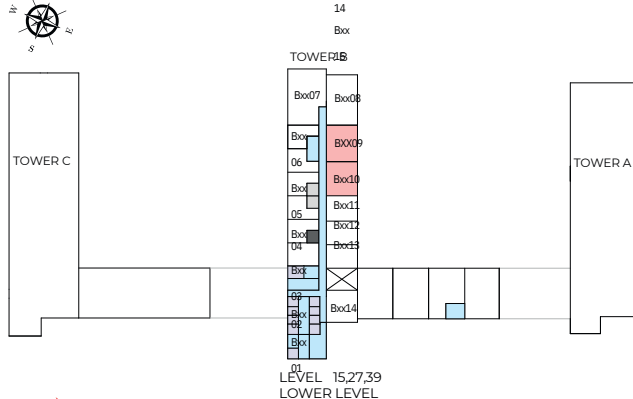
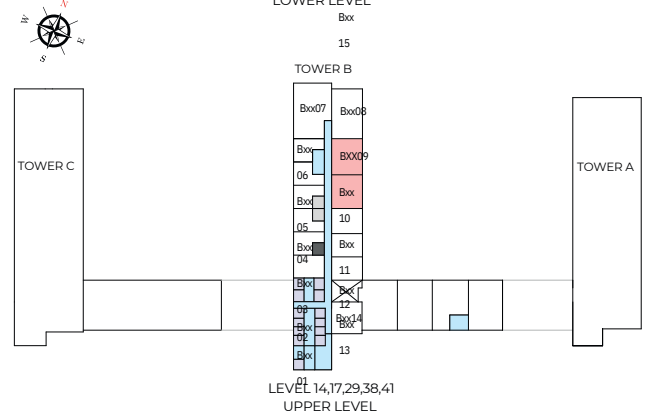
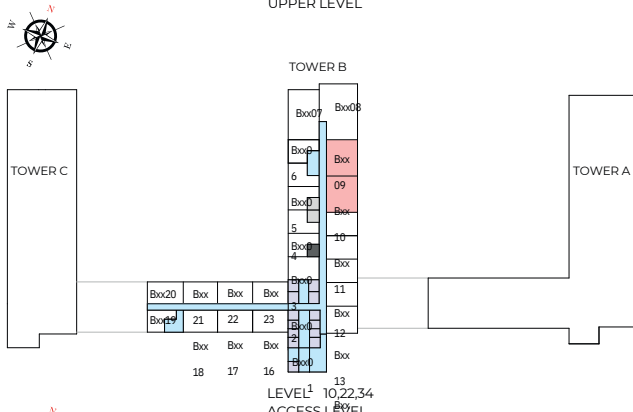
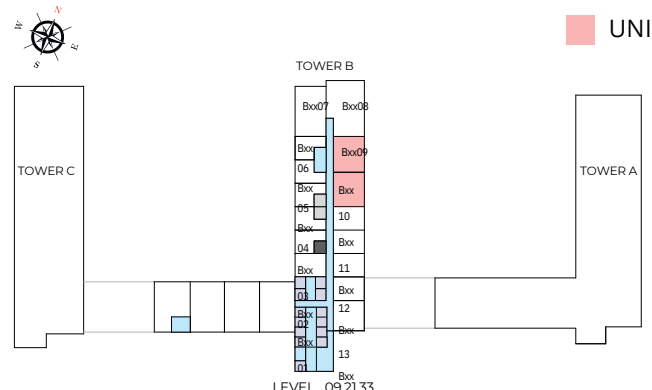
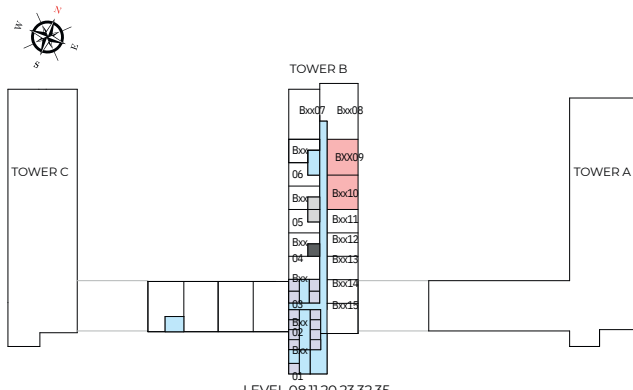

List of unit numbers with this unit plan:

## VIEWS

Golf Course, Amenities, Creek  
B809, B909, B1009

Golf Course, Amenities, Creek  
B1109, B1110, B1409, B1410, B1509, B1510, B1609, B1610, B1709, B1710, B2009, B2010, B2109, B2110, B2209, B2210, B2309, B2310

Amenities, Creek  
B810, B910, B1010

Golf Course, Creek  
B2709, B2710, B2809, B2810, B2909, B2910, B3209, B3210, B3309, B3310, B3409, B3410, B3509, B3510, B3809, B3810, B3909, B3910, B4009, B4010, B4109, B4110, B4409, B4410, B4509, B4510, B4609, B4610

Disclaimer: 1. All dimensions are in metric, measured to wall finishes. 2. All materials, dimensions & drawings are approximate. 3. Information is subject to change without notice, at developer's absolute discretion. 4. Actual area may vary from the stated area. 5. Drawing are not to scale. 6. All images used are for illustrative purpose only and do not represent the actual size, features, specifications, fittings and furnishings. 7. The developer reserves the right to make revisions/ alterations, at its absolute discretion, without any liability whatsoever.



# TOTALLY HOME

---

REAL ESTATE



[totallyhomerealestate](#)



[totallyhomerealestate](#)



[totallyhomerealestate](#)



[totallyhomerealestate.com](#)

---

+971 54 289 7686



[sales@totallyhomerealestate.com](mailto:sales@totallyhomerealestate.com)



[support@totallyhomerealestate.com](mailto:support@totallyhomerealestate.com)



[admin@totallyhomerealestate.com](mailto:admin@totallyhomerealestate.com)



Office 103, Building 6 Bay Square Tower, Business Bay PO Box 418317, Dubai